



Panasonic[®]

Owner's Manual

CD Stereo System

Model No. **SC-AKX14**

Thank you for purchasing this product.

For optimum performance and safety, please read these instructions carefully.

Please keep this manual for future reference.

If you have any questions, contact:

1-800-211-PANA (7262)

La guía rápida en español se encuentra en la página 2.

Panasonic Consumer Marketing Company of North America,
Division of Panasonic Corporation of North America

One Panasonic Way, Secaucus,
New Jersey 07094
<http://www.panasonic.com>

© Panasonic Corporation 2012
Printed in Malaysia



RQT9691-1P

L0112CH1022

Do the procedures with the remote control. You can also use the buttons on the main unit if they are the same.

Your system and the illustrations can look differently.

These operating instructions are applicable to the following system.

System	SC-AKX14
Main unit	SA-AKX14
Speakers	SB-AKX14

The model number and serial number of this product can be found on either the back or the bottom of the unit. Please note them in the space provided below and keep for future reference.

MODEL NUMBER _____ SC-AKX14
SERIAL NUMBER _____

User memo:

DATE OF PURCHASE _____
DEALER NAME _____
DEALER ADDRESS _____

TELEPHONE NUMBER _____

IMPORTANT SAFETY INSTRUCTIONS

Read these operating instructions carefully before using the unit. Follow the safety instructions on the unit and the applicable safety instructions listed below. Keep these operating instructions handy for future reference.

- 1) Read these instructions.
- 2) Keep these instructions.
- 3) Heed all warnings.
- 4) Follow all instructions.
- 5) Do not use this apparatus near water.
- 6) Clean only with dry cloth.
- 7) Do not block any ventilation openings. Install in accordance with the manufacturer's instructions.
- 8) Do not install near any heat sources such as radiators, heat registers, stoves, or other apparatus (including amplifiers) that produce heat.
- 9) Do not defeat the safety purpose of the polarized or grounding-type plug. A polarized plug has two blades with one wider than the other. A grounding-type plug has two blades and a third grounding prong. The wide blade or the third prong are provided for your safety. If the provided plug does not fit into your outlet, consult an electrician for replacement of the obsolete outlet.
- 10) Protect the power cord from being walked on or pinched particularly at plugs, convenience receptacles, and the point where they exit from the apparatus.
- 11) Only use attachments/accessories specified by the manufacturer.
- 12) Use only with the cart, stand, tripod, bracket, or table specified by the manufacturer, or sold with the apparatus. When a cart is used, use caution when moving the cart/apparatus combination to avoid injury from tip-over.
- 13) Unplug this apparatus during lightning storms or when unused for long periods of time.
- 14) Refer all servicing to qualified service personnel. Servicing is required when the apparatus has been damaged in any way, such as power-supply cord or plug is damaged, liquid has been spilled or objects have fallen into the apparatus, the apparatus has been exposed to rain or moisture, does not operate normally, or has been dropped.



Safety precaution

	CAUTION RISK OF ELECTRIC SHOCK DO NOT OPEN	
CAUTION:	TO REDUCE THE RISK OF ELECTRIC SHOCK, DO NOT REMOVE SCREWS. NO USER-SERVICEABLE PARTS INSIDE. REFER SERVICING TO QUALIFIED SERVICE PERSONNEL.	



The lightning flash with arrowhead symbol, within an equilateral triangle, is intended to alert the user to the presence of uninsulated "dangerous voltage" within the product's enclosure that may be of sufficient magnitude to constitute a risk of electric shock to persons.



The exclamation point within an equilateral triangle is intended to alert the user to the presence of important operating and maintenance (servicing) instructions in the literature accompanying the appliance.

CAUTION	- LASER RADIATION WHEN OPEN. DO NOT STARE INTO BEAM.	FDA 21 CFR / Class
CAUTION	- CLASS 1M VISIBLE AND INVISIBLE LASER RADIATION WHEN OPEN. DO NOT VIEW DIRECTLY WITH OPTICAL INSTRUMENTS. REC0802S-1 +A2/ Class 1M.	
VARNING	- KLASS 1M SYNLIG OCH OSYNLIG LASERSTRÅLNING NÄR DENNA DEL ÄR ÖPPNAD. BETRÄKTA EJ STRÅLEN DIREKT GENOM OPTISKA INSTRUMENT.	
FORSIGTIG	- SYNLIG OG USYNLIG LASERSTRÅLING KLASS 1M. NÄR LÅGET ER ÅBENT, UNDGÅ AT SE LIGE PÅ MED OPTISKE INSTRUMENTER.	
VARO!	- AVATTAESSA OLET AULTIINA LUKKAN 1M NÄRIVÄÄ JA NÄKYMÄTÖNTÄ, LASERSÄTELYÄ. ÄLÄ KATSO OPTISELLA LAITTEILLA SUORAAN SÄTEESEEN.	
VORSICHT	- SICHTBARE UND UNSICHTBARE LASERSTRAHLUNG KLASSE 1M. WEIN ABEDECKUNG GEÖFFNET, NICHT DIREKT MIT OPTISCHEN INSTRUMENTEN BETRACHTEN.	
ATTENTION	- RAYONNEMENT LASER VISIBLE ET INVISIBLE. CLASSE 1M. EN CAS D'OUVERTURE, NE PAS REGARDER DIRECTEMENT À L'ŒIL DES INSTRUMENTS D'OPTIQUE.	
PRECAUCION	- RADIACIÓN LASER VISIBLE E INVISIBLE DE CLASE 1M AL ESTAR ABIERTO. NO VEA DIRECTAMENTE CON INSTRUMENTOS ÓPTICOS.	

RQLXS0106

Inside of product

WARNING!

Unit

- To reduce the risk of fire, electric shock or product damage,
 - Do not expose this unit to rain, moisture, dripping or splashing.
 - Do not place objects filled with liquids, such as vases, on this unit.
 - Use only the recommended accessories.
 - Do not remove covers.
 - Do not repair this unit by yourself. Refer servicing to qualified service personnel.

CAUTION!

Unit

- To reduce the risk of fire, electric shock or product damage,
 - Do not install or place this unit in a bookcase, built-in cabinet or in another confined space. Ensure this unit is well ventilated.
 - Do not obstruct this unit's ventilation openings with newspapers, tablecloths, curtains, and similar items.
 - Do not place sources of naked flames, such as lighted candles, on this unit.
- Install this unit so that the AC mains lead can be unplugged from the socket outlet immediately if any problem occurs.
- This unit utilizes a laser. Use of controls or adjustments or performance of procedures other than those specified herein may result in hazardous radiation exposure.

Battery

- Do not break open or short-circuit the battery.
- Do not charge the alkaline or manganese battery.
- Do not use the battery if the cover has peeled off.
- Do not heat or expose to flame.
- Do not leave the battery(ies) in a car exposed to direct sunlight for a long period of time with door and windows closed.
- Remove the battery if you do not use the remote control for a long period of time. Keep in a cool, dark area.
- Danger of explosion if battery is incorrectly replaced. Replace only with the type recommended by the manufacturer.
- When disposing the batteries, please contact your local authorities or dealer and ask for the correct method of disposal.

FCC Note:

This equipment has been tested and found to comply with the limits for a Class B digital device, pursuant to Part 15 of the FCC Rules.

These limits are designed to provide reasonable protection against harmful interference in a residential installation. This equipment generates, uses and can radiate radio frequency energy and, if not installed and used in accordance with the instructions, may cause harmful interference to radio communications. However, there is no guarantee that interference will not occur in a particular installation. If this equipment does cause harmful interference to radio or television reception, which can be determined by turning the equipment off and on, the user is encouraged to try to correct the interference by one or more of the following measures:

- Reorient or relocate the receiving antenna.
- Increase the separation between the equipment and receiver.
- Connect the equipment into an outlet on a circuit different from that to which the receiver is connected.
- Consult the dealer or an experienced radio/TV technician for help.

Any unauthorized changes or modifications to this equipment would void the user's authority to operate this device.

This device complies with Part 15 of the FCC Rules. Operation is subject to the following two conditions:

- (1) This device may not cause harmful interference, and
- (2) this device must accept any interference received, including interference that may cause undesired operation.

Declaration of Conformity

Trade name: Panasonic

Model No.: SC-AKX14

Responsible Party:

Panasonic Corporation of North America
One Panasonic Way, Secaucus, NJ 07094

Support Contact:

Panasonic Consumer Marketing Company of North America
Telephone No.: 1-800-211-PANA (7262)

Product service

- 1) Damage requiring service** — The unit should be serviced by qualified service personnel if:
 - a) The AC power supply cord or the plug has been damaged; or
 - b) Objects or liquids have gotten into the unit; or
 - c) The unit has been exposed to rain; or
 - d) The unit does not operate normally or exhibits a marked change in performance; or
 - e) The unit has been dropped or the cabinet damaged.
- 2) Servicing** — Do not attempt to service the unit beyond that described in these operating instructions. Refer all other servicing to authorized servicing personnel.
- 3) Replacement parts** — When parts need replacing ensure the servicer uses parts specified by the manufacturer or parts that have the same characteristics as the original parts. Unauthorized substitutes may result in fire, electric shock, or other hazards.
- 4) Safety check** — After repairs or service, ask the servicer to perform safety checks to confirm that the unit is in proper working condition.

Product information

For product information or assistance with product operation:

Refer to "Customer Services Directory (United States and Puerto Rico)".

- If you see this symbol -

Information on Disposal in other Countries outside the European Union



This symbol is only valid in the European Union.
If you wish to discard this product, please contact your local authorities or dealer and ask for the correct method of disposal.

Panasonic Home Audio Products Limited Warranty

Limited Warranty Coverage (For USA and Puerto Rico Only)

If your product does not work properly because of a defect in materials or workmanship, Panasonic Consumer Marketing Company of North America (referred to as "the warrantor") will, for the length of the period indicated on the chart below, which starts with the date of original purchase ("warranty period"), at its option either (a) repair your product with new or refurbished parts, (b) replace it with a new or a refurbished equivalent value product, or (c) refund your purchase price. The decision to repair, replace or refund will be made by the warrantor.

Product or Part Name	Parts	Labor
Audio Products (except items below)	1 year	1 year
DVD Home Theater System	1 year	1 year
Home Theater Audio System	1 year	1 year
SD Memory Cards, Rechargeable Battery Packs (defective exchange)	90 days	Not Applicable

During the "Labor" warranty period there will be no charge for labor. During the "Parts" warranty period, there will be no charge for parts. This Limited Warranty excludes both parts and labor for non-rechargeable batteries, antennas, and cosmetic parts (cabinet). This warranty only applies to products purchased and serviced in the United States or Puerto Rico. This warranty is extended only to the original purchaser of a new product which was not sold "as is".

Carry-In or Mail-In Service

To find a service center please visit <http://www.panasonic.com/help> or call 1-800-211-PANA (7262).

When shipping the unit, carefully pack, include all supplied accessories listed in the Owner's Manual, and send it prepaid, adequately insured and packed well in a carton box. When shipping Lithium Ion batteries please visit our Web Site at www.panasonic.com/BatteryHandling as Panasonic is committed to providing the most up to date information. Include a letter detailing the complaint, a return address and provide a daytime phone number where you can be reached. A valid registered receipt is required under the Limited Warranty.

IF REPAIR IS NEEDED DURING THE WARRANTY PERIOD, THE PURCHASER WILL BE REQUIRED TO FURNISH A SALES RECEIPT/PROOF OF PURCHASE INDICATING DATE OF PURCHASE, AMOUNT PAID AND PLACE OF PURCHASE. CUSTOMER WILL BE CHARGED FOR THE REPAIR OF ANY UNIT RECEIVED WITHOUT SUCH PROOF OF PURCHASE.

Limited Warranty Limits And Exclusions

This warranty ONLY COVERS failures due to defects in materials or workmanship, and DOES NOT COVER normal wear and tear or cosmetic damage. The warranty ALSO DOES NOT COVER damages which occurred in shipment, or failures which are caused by products not supplied by the warrantor, or failures which result from accidents, misuse, abuse, neglect, mishandling, misapplication, alteration, faulty installation, set-up adjustments, misadjustment of consumer controls, improper maintenance, power line surge, lightning damage, modification, introduction of sand, humidity or liquids, commercial use such as hotel, office, restaurant, or other business or rental use of the product, or service by anyone other than a Factory Service Center or other Authorized Servicer, or damage that is attributable to acts of God.

THERE ARE NO EXPRESS WARRANTIES EXCEPT AS LISTED UNDER "LIMITED WARRANTY COVERAGE".

THE WARRANTOR IS NOT LIABLE FOR INCIDENTAL OR CONSEQUENTIAL DAMAGES RESULTING FROM THE USE OF THIS PRODUCT, OR ARISING OUT OF ANY BREACH OF THIS WARRANTY. (As examples, this excludes damages for lost time, travel to and from the servicer, loss of or damage to media or images, data or other memory or recorded content. The items listed are not exclusive, but for illustration only.)

ALL EXPRESS AND IMPLIED WARRANTIES, INCLUDING THE WARRANTY OF MERCHANTABILITY, ARE LIMITED TO THE PERIOD OF THE LIMITED WARRANTY.

Some states do not allow the exclusion or limitation of incidental or consequential damages, or limitations on how long an implied warranty lasts, so the exclusions may not apply to you. This warranty gives you specific legal rights and you may also have other rights which vary from state to state. If a problem with this product develops during or after the warranty period, you may contact your dealer or Service Center. If the problem is not handled to your satisfaction, then write to the warrantor's Consumer Affairs Department at the addresses listed for the warrantor.

PARTS AND SERVICE, WHICH ARE NOT COVERED BY THIS LIMITED WARRANTY, ARE YOUR RESPONSIBILITY.

Customer Services Directory (United States and Puerto Rico)

Obtain Product Information and Operating Assistance; locate your nearest Dealer or Service Center; purchase Parts and Accessories; or make Customer Service and Literature requests by visiting our Web Site at:

<http://www.panasonic.com/help>

or, contact us via the web at:

<http://www.panasonic.com/contactinfo>

You may also contact us directly at:

1-800-211-PANA (7262)

Monday-Friday 9am-9pm, Saturday-Sunday 10am-7pm EST

For hearing or speech impaired TTY users, TTY: 1-877-833-8855

Accessory Purchases (United States and Puerto Rico)

Purchase Parts, Accessories and Instruction Books online for all Panasonic Products by visiting our Web Site at:

<http://www.pstc.panasonic.com>

or, send your request by E-mail to:

npcparts@us.panasonic.com

You may also contact us directly at:

1-800-332-5368 (Phone) 1-800-237-9080 (Fax Only)

(Monday-Friday 9am-9pm EST)

Panasonic National Parts Center
20421 84th Ave. S., Kent, WA 98032

(We accept Visa, MasterCard, Discover Card, American Express)

For hearing or speech impaired TTY users, TTY: 1-866-605-1277

As of January 2012

Supplied accessories

Check and identify the supplied accessories.

Use numbers indicated in parentheses when asking for replacement parts. (Product numbers correct as of February 2012. This may be subject to change.)

To order accessories, refer to "Accessory Purchases (United States and Puerto Rico)".

1 x AC power supply cord
(K2CB2YY00059)

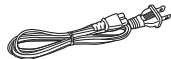

1 x AM loop antenna
(N1DY000011)



1 x FM indoor antenna
(RSAX0002)



1 x Remote control
(N2QAYB000636)

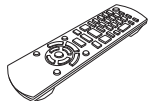

1 x Remote control battery



Placement of speakers



The right and left speakers are the same.
You cannot remove the net of the speakers.

Use only the supplied speakers.

The combination of the main unit and speakers give the best sound.

You can cause damage to the system and decrease the sound quality if you use other speakers.

Note:

- Keep your speakers at least 10 mm ($\frac{15}{32}$ ") away from the system for proper ventilation.
- Put the speakers on a flat safe surface.
- These speakers do not have magnetic shielding. Do not put them near TVs, PCs or other equipment easily influenced by magnetism.
- When you play at high levels for a long period, it can cause damage to the system and decrease the life of the system.
- Decrease the volume in these conditions to prevent damage:
 - When you play distorted sound.
 - When you adjust the sound quality.

CAUTION!

- Use the speakers only with the recommended system. If not, you can cause damage to the amplifier and speakers and can cause a fire. Consult an approved service personnel if damage occurs or if there is a sudden apparent change in performance.
- Do the procedures included in these instructions when you attach the speakers.

Preparing the remote control

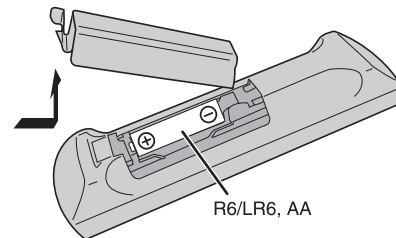

Use alkaline or manganese battery.

Install the battery so that the poles (+ and –) align with those in the remote control.

Point the remote control at the remote control sensor, away from obstacles, at a maximum range of 7 m (23 ft) directly in front of the main unit.

Specifications

Amplifier section

RMS output power stereo mode

Front Ch (both ch driven)	125 W per channel (4 Ω), 1 kHz, 10% THD
Total RMS stereo mode power	250 W (10% THD) 320 W (max)

FTC output power stereo mode

Front Ch (both ch driven)	56 W per channel (4 Ω), 20 Hz to 20 kHz, 1% THD
Total FTC stereo mode power	112 W

Tuner, terminals section

Preset station	FM 30 stations AM 15 stations
-----------------------	----------------------------------

Frequency modulation (FM)

Frequency range	87.9 MHz to 107.9 MHz (200 kHz step) 87.5 MHz to 108.0 MHz (100 kHz step)
Antenna terminals	75 Ω (unbalanced)

Amplitude modulation (AM)

Frequency range	520 kHz to 1710 kHz (10 kHz step)
-----------------	-----------------------------------

AUX input	RCA pin jack
------------------	--------------

Disc section

Disc played (8 cm or 12 cm)	CD, CD-R/RW (CD-DA, MP3*)
------------------------------------	---------------------------

Pick up

Wavelength	790 nm (CD)
Laser power	CLASS 1

Audio output (Disc)

Number of channels	2 ch (FL, FR)
FL = Front left channel	
FR = Front right channel	

* MPEG-1 Layer 3

USB section

USB port

USB standard	USB 2.0 full speed
Media file format support	MP3 (*.mp3)
USB device file system	FAT12, FAT16, FAT32
USB port power	500 mA (max)
Bit rate	16 kbps to 320 kbps (playback)

Speaker section

Type	2 way, 2 speaker system (bass reflex)
-------------	--

Speaker unit(s)

Woofer	16 cm (6 ½") cone type
Tweeter	6 cm (2 ¾") cone type

Impedance	4 Ω
------------------	-----

Output sound pressure	85 dB/W (1 m)
------------------------------	---------------

Frequency range	48 Hz to 22 kHz (−16 dB) 52 Hz to 20 kHz (−10 dB)
------------------------	--

Dimensions (W x H x D)	200 mm x 334 mm x 193 mm (7 ⅞" x 13 ⅛" x 7 ⅝")
-------------------------------	---

Mass (Weight)	2.5 kg (5.5 lbs)
----------------------	------------------

General

Power supply	AC 120 V, 60 Hz
---------------------	-----------------

Power consumption	58 W
--------------------------	------

Dimensions (W x H x D)	220 mm x 334 mm x 245 mm (8 ⅝" x 13 ⅛" x 9 ⅝")
-------------------------------	---

Mass (Weight)	2.8 kg (6.2 lbs)
----------------------	------------------

Operating temperature range	0°C to +40°C (+32°F to 104°F)
------------------------------------	----------------------------------

Operating humidity range	35% to 80% RH (no condensation)
---------------------------------	------------------------------------

Power consumption in standby mode

0.2 W (approximate)

Note:

- Specifications are subject to change without notice. Mass (weight) and dimensions are approximate.
- Total harmonic distortion is measured by the digital spectrum analyzer.

Making the connections

Conserving power

The system consumes approximately 0.2 W when it is in standby mode. Disconnect the power supply if you do not use the system.

Some settings will be lost after you disconnect the system. You have to set them again.

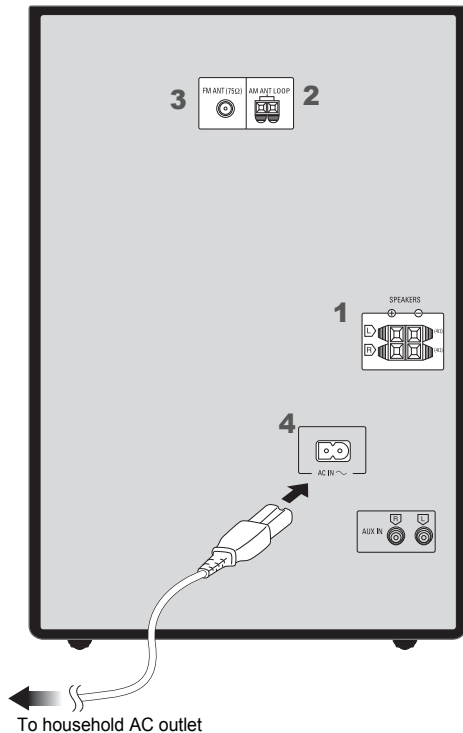

1 Connect the speakers.

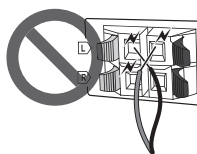
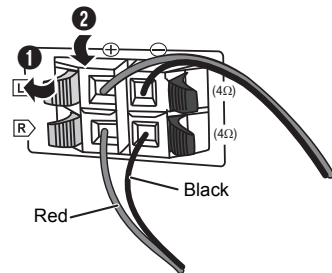

Be careful not to cross (short-circuit) or reverse the polarity of the speaker wires as doing so may damage the speakers.

2 Connect the AM loop antenna.

Stand the antenna up on its base until it clicks.

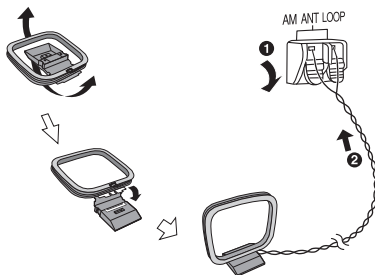

3 Connect the FM indoor antenna.

Place the antenna where reception is best.

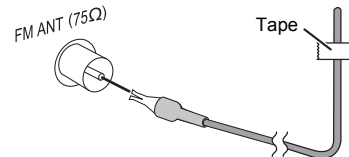

4 Connect the AC power supply cord.

Use the supplied AC power supply cord with this system only.

Do not use an AC power supply cord from other equipment.

Overview of controls

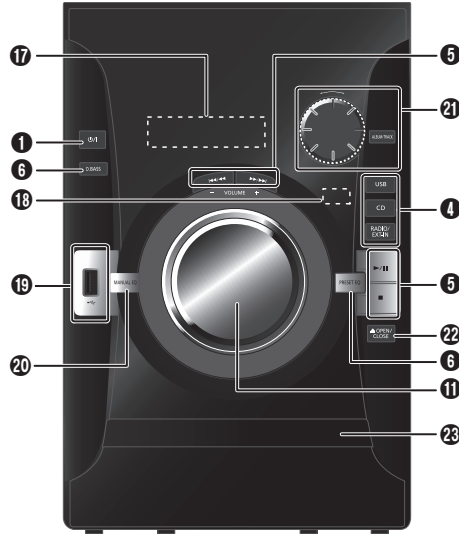
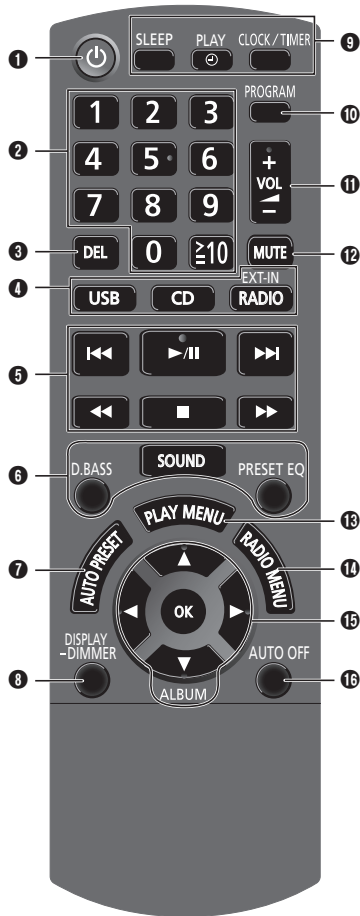

- 1 Standby/on switch** [⏻], [⏻/⏹]
Press to switch the unit from on to standby mode or vice versa. In standby mode, the unit is still consuming a small amount of power.
- 2 Numeric buttons** [1 to 9, 0, ≥10]
To select a 2-digit number
Example: 16: [≥10] → [1] → [6]
- 3 Delete a programmed track**
- 4 Select audio source**
- 5 Basic playback control**
- 6 Select the sound effects**
- 7 Auto preset the radio station**
- 8 View content information**
Decrease the brightness of the display panel
Press and hold the button to use this function.
To cancel, press and hold the button again.

- 9 Clock and timer operation**
- 10 Set the program function**
- 11 Adjust the volume of the system**
- 12 Mute the sound of the system**
Press the button again to cancel.
"MUTE" is also canceled when you adjust the volume or when you switch off the system.
- 13 Set the play menu item**
- 14 Set the radio menu item**
- 15 Select the option**
- 16 Automatically switch off the system**
When you are in disc or USB source, the auto off function switches off the system if you do not use the system for 30 minutes.
To cancel, press the button again.
- 17 Display panel**
- 18 Remote control sensor**
- 19 USB port** (↔)
- 20 Select bass or treble effect**
- 21 Browse tracks or albums**
[CD]
Turn the knob to browse the track.
Press [▶/||] to start playback from the selection.
[MP3]
Press [ALBUM/TRACK] to select album or track and then turn the knob to browse.
Press [▶/||] to start playback from the selection.
- 22 Open or close the disc tray**
- 23 Disc tray**

Disc

Playing disc

- 1 Press [**▲**, OPEN/CLOSE] on the main unit to open the disc tray.
Put in a disc with the label facing up.
Press [**▲**, OPEN/CLOSE] again to close the disc tray.
- 2 Press [**CD**] and then press [**▶/||**] to start playback.

Stop playback	Press [■].
Pause playback	Press [▶/]. Press again to continue playback.
Skip album (MP3)	Press [▲ , ▼].
Skip track	Press [◀◀] or [▶▶] (main unit: [◀◀/▶▶] or [▶▶/▶▶]).
Search through track	Press and hold [◀◀] or [▶▶] (main unit: [◀◀/▶▶] or [▶▶/▶▶]).

Viewing available information

You can view the available information on the display panel.

Press [**DISPLAY**].

Note:

- Maximum characters that can be shown: approximately 16
- This system supports ver. 1.0 and 1.1 ID3 tags.
- Text data that the system does not support can show differently.

Play menu

- 1 Press [**PLAY MENU**] to select “PLAYMODE” or “REPEAT”.
- 2 Press [**◀**, ▶] and then press [**OK**] to select the desired mode.

PLAYMODE

OFF PLAYMODE	Play all tracks.
1-TRACK 1TR	Play one selected track on the disc. Press the numeric buttons to select the track.
1-ALBUM 1ALBUM (MP3)	Play one selected album on the disc. Press [▲ , ▼] to select the album.
RANDOM RND	Play a disc randomly.
1-ALBUM RANDOM 1ALBUM RND (MP3)	Play all tracks in one selected album randomly. Press [▲ , ▼] to select the album.

REPEAT

ON REPEAT 	Repeat playback.
OFF REPEAT	Cancel repeat playback.

Note:

- Playmode function does not work with “Program playback”.
- The setting returns to the default “OFF PLAYMODE” when you open the disc tray.

Program playback

This function allows you to program up to 24 tracks.

- 1 Press [**PROGRAM**] in the stop mode.
“PGM” is shown.
- 2  Press the numeric buttons to select the desired track.
Do this step again to program other tracks.

(MP3)

1. Press [**▲**, ▼] to select the desired album.
 2. Press [**▶▶**] and then press the numeric buttons to select the desired track.
 3. Press [**OK**].
- Do these steps again to program other tracks.

- 3 Press [**▶/||**] to start playback.

Cancel program mode	Press [PROGRAM] in the stop mode.
Check program contents	Press [◀◀] or [▶▶] when “PGM” is shown in the stop mode.
Clear the last track	Press [DEL] in the stop mode.
Clear all programmed tracks	Press [■] in the stop mode. “CLR ALL” is shown. Within 5 seconds, press [■] again.

Note:

The program memory is cleared when you open the disc tray.

Note on disc

- This system can play CD-R/RW with CD-DA or MP3 format content.
- Some CD-R/RW cannot be played because of the condition of the recording.
- MP3 files are defined as tracks and folders are defined as albums.
- This system can access up to:
 - CD-DA: 99 tracks
 - MP3: 999 tracks, 255 albums and 20 sessions
- Disc must conform to ISO9660 level 1 or 2 (except for extended formats).
- Recordings will not necessarily be played in the order you recorded them.

MPEG Layer-3 audio coding technology licensed from Fraunhofer IIS and Thomson.

USB

You can connect and play MP3 tracks from your USB device.

Do not use a USB extension cable. The system cannot recognize USB device connected through a cable.

- 1 Connect the USB device to the USB port.**
Hold the main unit when connecting or disconnecting the USB device.
- 2 Press [USB] and then press [▶/||] to start playback.**

Stop playback	Press [■] during playback. "RESUME" is shown. Press [▶/] to continue playback from the start of the track. OR Press [■] two times to stop the playback fully.
---------------	--

For other operation, refer to "Disc".

Compatible USB devices which are defined as mass storage class:

- USB devices that support bulk-only transfer.
- USB devices that support USB 2.0 full speed.

Note:

- Files are defined as tracks and folders are defined as albums.
- Track must have the extension ".mp3" or ".MP3".
- This system can access up to:
 - 255 albums (including albums without MP3 tracks)
 - 2500 tracks
 - 999 tracks in one album
- CBI (Control/Bulk/Interrupt) is not supported.
- NTFS file system is not supported (only FAT 12/16/32 file system is supported).
- Some files can fail to work because of the sector size.

Radio

Manual tuning

- 1 Press [RADIO, EXT-IN] (main unit: [RADIO/EXT-IN]) to select "FM" or "AM".**
- 2 Press [◀◀] or [▶▶] to select the frequency of the required station.**
To tune automatically, press and hold the button until the frequency starts changing quickly.

Improving the sound quality

When "FM" is selected

- 1 Press [RADIO MENU] to select "FM MODE".**
- 2 Press [◀, ▶] to select "MONO" and then press [OK].**
To cancel, select "STEREO".
"MONO" is also canceled when you change the frequency.

When "AM" is selected

- 1 Press [RADIO MENU] to select "B.PROOF".**
- 2 Press [◀, ▶] to select "BP 1" or "BP 2" and then press [OK].**

Memory presetting

30 FM and 15 AM stations can be preset.

Automatic presetting

- 1 Press [OK] to select "LOWEST" or "CURRENT" frequency.**
- 2 Press [AUTO PRESET] to start presetting.**
To cancel, press [■].

Manual presetting

- 1 Press [◀◀] or [▶▶] to tune in to the station.**
- 2 Press [PROGRAM].**
- 3 Press the numeric buttons to select a preset number.**
Do steps 1 through 3 again to preset more stations.
The new station replaces any station that occupies the same preset number.

Selecting a preset station

Press the numeric buttons, [◀◀] or [▶▶] (main unit: [◀◀/◀◀] or [▶▶/▶▶]) to select the preset station.

FM allocation setting

By main unit only

This system can also receive FM broadcasts allocated in 0.1 MHz steps.

- 1 Press [RADIO/EXT-IN] to select "FM" or "AM".**
- 2 Press and hold [RADIO/EXT-IN].**

After a few seconds, the display panel shows the current minimum radio frequency. Release the button when the minimum frequency changes.

- To go back to the initial setting, do the above steps again.
- After you change the setting, preset frequencies are erased.

External equipment

You can connect a VCR, DVD player etc. and listen to the audio through this system.

Preparation

- Disconnect the AC power supply cord.
- Switch off all equipment and read the appropriate operating instructions.

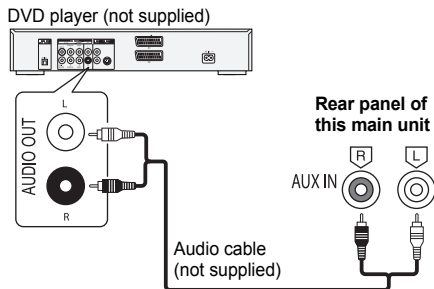

- 1 Connect the external equipment.**
- 2 Press [RADIO, EXT-IN] (main unit: [RADIO/EXT-IN]) to select "AUX".**
- 3 Play the external equipment.**

Note:

- Components and cables are sold separately.
- If you want to connect equipment other than those described, refer to the audio dealer.
- Sound distortion can occur when you use an adapter.

Troubleshooting

Before requesting service, make the following checks. If you are in doubt about some of the check points, or if the solutions indicated do not solve the problem, refer to "Customer Services Directory (United States and Puerto Rico)" on page 1.

Common problems

The display panel lights up and changes continuously in standby mode.

- Press and hold [MUTE] on the main unit to select "DEMO OFF".

No operations can be done with the remote control.

- Examine that the battery is installed correctly.

Sound is distorted or no sound.

- Adjust the volume of the system.
- Switch off the system, determine and correct the cause, then switch the system on again. It can be caused by straining of the speakers through excessive volume or power, and when using the system in a hot environment.

A "humming" sound can be heard during playback.

- An AC power supply cord or fluorescent light is near the cables. Keep other appliances and cords away from the cables of this system.

Disc

Display not shown correctly. Playback does not start.

- You have not put in the disc correctly. Put it in correctly.
- Disc is dirty. Clean the disc.
- Replace the disc if it is scratched, warped, or non-standard.
- There is condensation. Let the system dry for 1 to 2 hours.

The total number of tracks displayed is incorrect.

The disc cannot be read.

Distorted sound is heard.

- You put in a disc that the system cannot play. Change to a playable disc.
- You put in a disc that has not been finalized.

Radio

Sound is distorted.

- Use an optional FM outdoor antenna. The antenna should be installed by a competent technician.

A beat sound is heard.

- Switch off the TV or move it away from the system.
- Set to "BP 1" or "BP 2" when in AM tuner mode.

A low hum is heard during AM broadcasts.

- Move the antenna away from other cables and cords.

USB

The USB device or the contents in it cannot be read.

- The format of the USB device or the contents in it is/are not compatible with the system.
- USB devices with storage capacity of more than 32 GB cannot work in some conditions.

Slow operation of the USB device.

- Large content size or large memory USB device takes longer time to read.

Main unit displays

"NO PLAY"

- Examine the content. You can only play supported format.
- If there are more than 255 albums or folders (audio and non-audio), some of the MP3 files in these albums cannot be read and played. Transfer these music albums to another USB device. Alternatively, reformat the USB device and save these music albums prior to saving the other non-audio folders.

"F61"

- Examine and correct the speaker cords connection.
- Disconnect the USB device. Switch off the system and then switch it on again.

“ERROR”

- An incorrect operation was done. Read the instructions and try again.

“NOT MP3/ERROR”

- An unsupported MP3 format. The system will skip that track and play the next one.

“VBR–”

- The system cannot show the remaining play time for variable bit rate (VBR) tracks.

“NORMAL”

- The “INPUT LEVEL” of AUX source automatically changes from “HIGH” to “NORMAL” when the system detects distorted music sounds.

“NODEVICE”

- The USB device is not connected. Examine the connection.

Memory reset (initialization)

Reset the memory when the following situations occur:

- There is no response when buttons are pressed.
- You want to clear and reset the memory contents.

1 Disconnect the AC power supply cord.

2 While you press and hold [⏻] on the main unit, connect the AC power supply cord again.
“-----” is shown.

3 Release [⏻].
All the settings are set back to the factory preset. It is necessary to set the memory items again.

Remote control code

When other Panasonic equipment responds to the remote control of this system, change the remote control code for this system.

Preparation

Press [RADIO, EXT-IN] (main unit: [RADIO/EXT-IN]) to select “AUX”.

To set the code to “REMOTE 2”

- 1 Press and hold [RADIO/EXT-IN] on the main unit and [2] on the remote control until “REMOTE 2” is shown.**
- 2 Press and hold [OK] and [2] for a minimum of 4 seconds.**

To set the code to “REMOTE 1”

- 1 Press and hold [RADIO/EXT-IN] on the main unit and [1] on the remote control until “REMOTE 1” is shown.**
- 2 Press and hold [OK] and [1] for a minimum of 4 seconds.**

Maintenance

To clean this system, wipe with a soft, dry cloth

- Never use alcohol, paint thinner or benzine to clean this system.
- Before using chemically treated cloth, read the instructions that came with the cloth carefully.

Cómo realizar las conexiones

1 Conecte las bocinas.

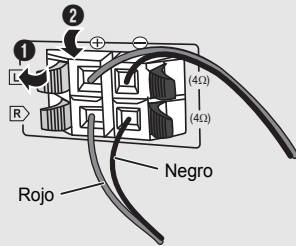

2 Conecte la antena de cuadro AM.

Ponga la antena en posición vertical sobre su base hasta que haga clic.

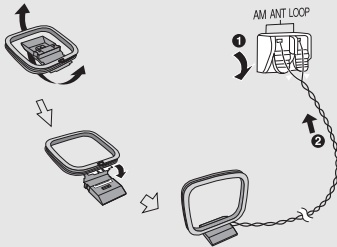

3 Conecte la antena interior FM.

Coloque la antena donde la recepción sea la mejor.

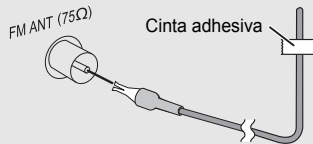

4 Conecte el cable de alimentación de CA.

Use exclusivamente el cable de alimentación de CA suministrado con este sistema.

No use un cable de alimentación de CA de otro equipo.

Disco

Cómo reproducir disco

1 Pulse [▲, OPEN/CLOSE] en la unidad principal para abrir la bandeja del disco.

Coloque un disco con la etiqueta hacia arriba.

Pulse [▲, OPEN/CLOSE] nuevamente para cerrar la bandeja del disco.

2 Pulse [CD] y después pulse [▶/II] para iniciar la reproducción.

Detener reproducción	Pulse [■].
Pausar la reproducción	Pulse [▶/II]. Pulse nuevamente para continuar la reproducción.
Saltar álbum (MP3)	Pulse [▲, ▼].
Saltar pista	Pulse [◀◀] o [▶▶] (unidad principal: [◀◀/◀◀] o [▶▶/▶▶]).
Buscar por pista	Pulse y mantenga pulsado [◀◀] o [▶▶] (unidad principal: [◀◀/◀◀] o [▶▶/▶▶]).

Menú de reproducción

1 Pulse [PLAY MENU] para seleccionar "PLAYMODE" o "REPEAT".

2 Pulse [◀, ▶] y luego pulse [OK] para seleccionar el modo deseado.

PLAYMODE

OFF PLAYMODE	Reproducir todas las pistas.
1-TRACK 1TR	Reproduce una pista seleccionada del disco. Pulse los botones numéricos para seleccionar la pista.
1-ALBUM 1ALBUM (MP3)	Reproduce un álbum seleccionado del disco. Pulse [▲, ▼] para seleccionar el álbum.
RANDOM RND	Reproduce un disco aleatoriamente.
1- ALBUM RANDOM 1ALBUM RND (MP3)	Reproduce todas las pistas de un álbum seleccionado aleatoriamente. Pulse [▲, ▼] para seleccionar el álbum.

REPEAT

ON REPEAT	Repetir la reproducción.
OFF REPEAT	Cancelar la reproducción repetida.

USB

Usted puede conectar y reproducir pistas MP3 desde su dispositivo USB.

No use un cable de extensión USB. El sistema no puede reconocer el dispositivo USB conectado a través de un cable.

1 Conecte el dispositivo USB al puerto USB.

Sujete la unidad principal al conectar o desconectar el dispositivo USB.

2 Pulse [USB] y después pulse [▶/||] para iniciar la reproducción.

Detener reproducción	Pulse [■] durante la reproducción. Se visualiza "RESUME". Pulse [▶/] para continuar la reproducción desde el principio de la pista. O Pulse [■] dos veces para detener totalmente la reproducción.
----------------------	---

Para otras operaciones, refiérase a "Disco".

Compatible con dispositivos USB definidos como tipo de almacenamiento masivo:

- Dispositivos USB que soportan sólo transferencia en masa.
- Dispositivos USB que soportan una velocidad total USB 2.0.

Radio

Sintonización manual

- 1** Pulse [RADIO, EXT-IN] (unidad principal: [RADIO/EXT-IN]) para seleccionar "FM" o "AM".
- 2** Pulse [◀◀] o [▶▶] para seleccionar la frecuencia de la emisora requerida.
Para sintonizar automáticamente, pulse y mantenga pulsado el botón hasta que la frecuencia comience a cambiar rápidamente.

Presintonización de la memoria

Se pueden preconfigurar 30 emisoras de FM y 15 de AM.

Preconfiguración automática

- 1** Pulse [OK] para seleccionar la frecuencia "LOWEST" (más baja) o "CURRENT" (actual).
- 2** Pulse [AUTO PRESET] para iniciar la preconfiguración.
Para cancelar, pulse [■].

Preconfiguración manual

- 1** Pulse [◀◀] o [▶▶] para sintonizar la estación.
- 2** Pulse [PROGRAM].
- 3** Pulse los botones numéricos para seleccionar un número preconfigurado.
Realice los pasos 1 al 3 nuevamente para preconfigurar más estaciones.
La estación más reciente reemplazará cualquier estación que ocupe el mismo número preconfigurado.

Selección de una emisora preconfigurada

Pulse los botones numéricos, [◀◀] o [▶▶] (unidad principal: [◀◀/◀◀] o [▶▶/▶▶]) para seleccionar la estación preconfigurada.

Reloj y temporizador

Configuración de la hora

Este es un reloj con un sistema de 12 horas.

- 1** Pulse [CLOCK/TIMER] para seleccionar "CLOCK".
- 2** Dentro de 10 segundos, pulse [▲, ▼] para configurar la hora.
- 3** Pulse [OK].

Pulse [CLOCK/TIMER] para visualizar el reloj durante unos segundos.

Temporizador de apagado automático

El temporizador de apagado automático apagará el sistema después de la hora configurada.

Pulse [SLEEP] para seleccionar la configuración (en minutos).
Para cancelar, seleccione "OFF".

30MIN → 60MIN → 90MIN → 120MIN → OFF
↑

Para visualizar el tiempo restante
Pulse [SLEEP].