

Panasonic®

Installation Manual

Additional Rugged Cordless Handset

Model No. **KX-TGTA61**

Link2Cell Cordless Telephone with Digital Answering Machine + Rugged Handset

Model No. **KX-TGD583**

KX-TGD584

KX-TGD585

KX-TGE484

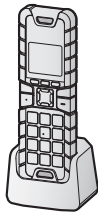

Model shown is TGTA61

Thank you for purchasing a Panasonic product.

This installation manual describes only the steps needed to register and begin using the handset. Please read the base unit's operating instructions for further details. Please read this installation manual before using the unit and save it for future reference.

For assistance, visit our Web site: <http://shop.panasonic.com/support>
for customers in the U.S.A.



PNQX8740YA

Printed in Malaysia

PNQX8740YA PP0418KT1088

Table of Contents

Installation

Accessory information	3
For KX-TGD583/KX-TGD584/KX-TGD585 users	4
For KX-TGE484 users	5

Important Information

For your safety	6
Important safety instructions	7
Other information	7

Getting Started

Setting up	8
Controls	10

Feature differences

Feature differences between your original handset and KX-TGTA61	12
Call block	12
Automated call block	13
Intercom, Transferring calls, Conference calls	14
Handset noise reduction	14
Handset equalizer	14
Turning auto intercom on/off	14
Baby monitor	14
Alarm (Memo alarm)	16
Intercom ringer volume/Intercom ringer tone	17
Changing the handset name	17
Displaying the handset name	17

Appendix

FCC and other information	18
Customer services	19
Limited Warranty (ONLY FOR U.S.A.)	20

Accessory information

Supplied accessories

Accessory item/Part number	Quantity
Charger/PNLC1083ZB	1
Rechargeable batteries*1	2
Handset cover*2/PNYNAGTA61BR	1
Belt clip*3/PNZMAGTA61BR	1

*1 See page 3 for replacement battery information.

*2 The handset cover comes attached to the handset.

*3 The belt clip comes attached to the handset.

Additional/replacement accessories

Please contact your nearest Panasonic dealer for sales information (page 19).

Accessory item	Model number/Specifications
Rechargeable batteries	HHR-4DPA*1
	● To order, please visit http://shop.panasonic.com/support
	Battery type: – Nickel metal hydride (Ni-MH) – 2 x AAA (R03) size for each handset
Headset	KX-TCA93, KX-TCA430

*1 Replacement batteries may have a different capacity from that of the supplied batteries.

Other information

- Design and specifications are subject to change without notice.
- The illustrations in these instructions may vary slightly from the actual product.
- For some features, the operations are slightly different from the descriptions in your base unit's operating instructions.
- Some features described in your base unit's operating instructions may not be available.

Installation

For KX-TGD583/KX-TGD584/KX-TGD585 users

For details about the operations, refer to the enclosed base unit's operating instructions.

Note:

- Some features of KX-TGTA61 are slightly different from the descriptions in the base unit's operating instructions (page 12).

Model composition

Series	Model No.	Base unit	Handset	
		Part No.	Part No.	Quantity
KX-TGD560 series	KX-TGD583	KX-TGD560	KX-TGDA51	2
			KX-TGTA61	1
	KX-TGD584	KX-TGD560	KX-TGDA51	3
			KX-TGTA61	1
	KX-TGD585	KX-TGD560	KX-TGDA51	4
			KX-TGTA61	1

Supplied accessories

Accessory item/Part number	Quantity		
	KX-TGD583	KX-TGD584	KX-TGD585
AC adaptor/PNLV226-0X	1	1	1
Telephone line cord*1	1	1	1
Wall mounting adaptor/PNKL1044Y2	1	1	1
Rechargeable batteries*2	6	8	10
Handset cover for KX-TGDA51*3/ PNYNTGDA50BR	2	3	4
Charger for KX-TGDA51/PNLC1077LB	1	2	3
Handset cover for KX-TGTA61*3/ PNYNAGTA61BR	1	1	1
Belt clip for KX-TGTA61*4/PNZMAGTA61BR	1	1	1
Charger for KX-TGTA61/PNLC1083ZB	1	1	1

*1 PNJA1186Z (Black cord), PNJA1193Z (Transparent cord)

*2 See page 3 for replacement battery information.

*3 The handset cover comes attached to the handset.

*4 The belt clip comes attached to the handset.

For KX-TGE484 users

For details about the operations, refer to the enclosed base unit's operating instructions.

Note:

- Some features of KX-TGTA61 are slightly different from the descriptions in the base unit's operating instructions (page 12).

Model composition

Series	Model No.	Base unit	Handset	
		Part No.	Part No.	Quantity
KX-TGE470 series	KX-TGE484	KX-TGE470	KX-TGEA40	3
			KX-TGTA61	1

Supplied accessories

Accessory item/Part number	Quantity
AC adaptor/PNLV226-0X	1
Telephone line cord*1	1
Wall mounting adaptor/PNKL1044Y1	1
Rechargeable batteries*2	8
Handset cover for KX-TGEA40*3/PNYNTGEA20SR	3
Belt clip for KX-TGEA40/PNKE1312Z1	3
Charger for KX-TGEA40/PNLC4050ZS	2
Handset cover for KX-TGTA61*3/PNYNAGTA61BR	1
Belt clip for KX-TGTA61*4/PNZMAGTA61BR	1
Charger for KX-TGTA61/PNLC1083ZB	1

*1 PQJA10075Y (Black cord), PQJA10075Z (Transparent cord)

*2 See page 3 for replacement battery information.

*3 The handset cover comes attached to the handset.

*4 The belt clip comes attached to the handset.

Important Information

For your safety

To prevent severe injury and loss of life/property, read this section carefully before using the product to ensure proper and safe operation of your product.

WARNING

Power connection

- Completely insert the AC adaptor/power plug into the power outlet. Failure to do so may cause electric shock and/or excessive heat resulting in a fire.
- Regularly remove any dust, etc. from the AC adaptor/power plug by pulling it from the power outlet, then wiping with a dry cloth. Accumulated dust may cause an insulation defect from moisture, etc. resulting in a fire.
- Unplug the product from power outlets if it emits smoke, an abnormal smell, or makes an unusual noise. These conditions can cause fire or electric shock. Confirm that smoke has stopped emitting and contact us at <http://shop.panasonic.com/support>

Installation

- To prevent the risk of fire or electrical shock, do not expose the product to rain or any type of moisture.
- Do not place or use this product near automatically controlled devices such as automatic doors and fire alarms. Radio waves emitted from this product may cause such devices to malfunction resulting in an accident.

CAUTION

Installation and location

- The AC adaptor is used as the main disconnect device. Ensure that the AC outlet is installed near the product and is easily accessible.

Ni-MH rechargeable batteries (supplied)

- We recommend using the supplied batteries or additional/replacement batteries noted on page 3 for replacement battery information. **USE ONLY rechargeable Ni-MH batteries AAA (R03) size.**
- Do not mix old and new batteries.
- Do not open or mutilate the batteries. Released electrolyte from the batteries is corrosive and may cause burns or injury to the eyes or skin. The electrolyte is toxic and may be harmful if swallowed.
- Exercise care when handling the batteries. Do not allow conductive materials such as rings, bracelets, or keys to touch the batteries, otherwise a short circuit may cause the batteries and/or the conductive material to overheat and cause burns.
- Charge the batteries provided with or identified for use with this product only, in accordance with the instructions and limitations specified in this manual.
- Only use a compatible base unit (or charger) to charge the batteries. Do not tamper with the base unit (or charger). Failure to follow these instructions may cause the batteries to swell or explode.

Attention:



A nickel metal hydride battery that is recyclable powers the product you have purchased. Please call 1-800-8-BATTERY (1-800-822-8837) for information on how to recycle this battery.

Waterproof handset

The handset is designed to be waterproof. You can use the handset near water (IP 67 Standard).

- Do not open the handset cover with wet hands.
- Do not expose the handset to salt water, ionized water, soapy water, etc.

Important Information

- Do not use the handset in high humidity places, such as bathroom.
- Since water in headset jack may cause damage, close the headset jack cover completely when the optional headset is not in use. When the optional headset is connected, do not use the handset with wet hands.
- If the handset is wet, wipe with a soft dry cloth.
- The charger is not designed to be waterproof. Do not place near the water. Also do not place the handset on the charger if the handset is wet.

Shock resistance (handset only)

The handset is designed to be shock-resistant, however, it should not be thrown or stepped on.

Important safety instructions

When using your product, basic safety precautions should always be followed to reduce the risk of fire, electric shock, and injury to persons, including the following:

1. Do not use the telephone to report a gas leak in the vicinity of the leak.
2. Use only the power cord and batteries indicated in this manual. Do not dispose of batteries in a fire. They may explode. Check with local codes for possible special disposal instructions.

SAVE THESE INSTRUCTIONS

Other information

- Operating the product near electrical appliances may cause interference. Move away from the electrical appliances.

CAUTION: Risk of explosion if battery is replaced by an incorrect type. Dispose of used batteries according to the instructions.

Routine care

- Wipe the outer surface of the product with a soft moist cloth.
- Do not use benzene, thinner, or any abrasive powder.

Notice for product disposal, transfer, or return

- This product can store your private/confidential information. To protect your privacy/confidentiality, we recommend that you erase information such as phonebook or caller list entries from the memory before you dispose of, transfer, or return the product.

Notice:

- This product is designed for use in the United States of America. Sale or use of this product in other countries may violate local laws.
- Cet appareil est conçu pour être utilisé aux États-Unis d'Amérique. La vente ou l'emploi de cet appareil dans certains autres pays peut constituer une infraction à la législation locale.
- Este producto está diseñado para usarse en los Estados Unidos de América. La venta o el empleo de este producto en ciertos países puede constituir violación de la legislación local.
- 本產品專為美國使用而設。若在其他國家銷售或使用，可能會違反當地法例。
- この製品は、日本国外での使用を目的として設計されており、日本国内での使用は法律違反となります。従って、当社では日本国内においては原則として修理などのサービスは致しかねます。

Compliance with TIA-1083 standard



Telephone handsets identified with this logo have reduced noise and interference when used with T-Coil equipped hearing aids and cochlear implants.

For assistance, please visit <http://shop.panasonic.com/support>

7

Getting Started

Setting up

Connections/Wall mounting

- 1 Connect the AC adaptor to the power outlet.
- 2 Drive the screws (A) (not supplied) into the wall, if necessary.
B 27.2 mm (1 1/16 inches)

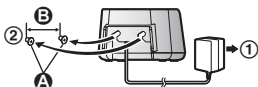

Note:

- The AC adaptor must remain connected at all times. (It is normal for the adaptor to feel warm during use.)
- Make sure that the wall and the fixing method are strong enough to support the weight of the unit.

Battery installation

Important:

- Use the supplied rechargeable batteries. For replacement, we recommend using the Panasonic rechargeable batteries noted on page 3.
- USE ONLY rechargeable Ni-MH batteries AAA (R03) size.
- Do NOT use alkaline/manganese/Ni-Cd batteries.
- Confirm correct polarities (+, -).
- When unlocking (1) or locking (11) the battery cover, make sure to align the arrow positions. Please do not turn more than excessively.

For KX-TGD583/KX-TGD584/KX-TGD585/ KX-TGE484 users:

- Follow the directions on the display to set up the unit.

Locking

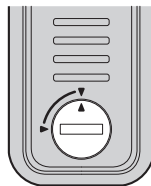

Unlocking

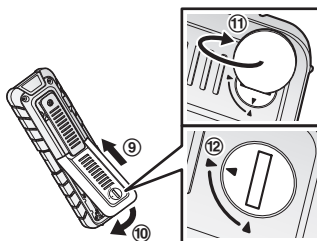
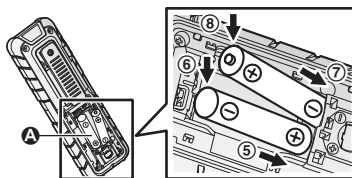
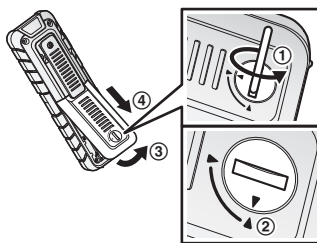
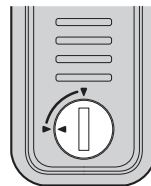

Removing the battery

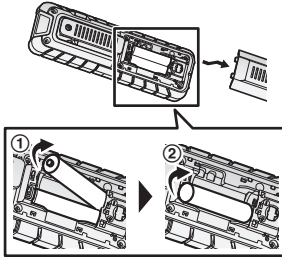

Battery charging

Charge for about 7 hours.

- Confirm “charging” is displayed (A).
- When the batteries are fully charged, “Fully charged” is displayed.



Note:

- If the batteries are fully charged, but the operating time seems to be shorter, clean the battery ends (+, -) and the charge contacts with a dry cloth and charge again.

Battery level

Icon	Battery level
	High
	Medium
	Low
	Needs charging.
	Empty

Ni-MH battery performance (supplied batteries)

Operation	Operating time
In continuous use	8.5 hours max.*1
Not in use (standby)	4 days max.*1

*1 If eco mode is on except when using link to cell function and flash light.

Note:

- Actual battery performance depends on usage and ambient environment.

Registering a handset to a base unit

For KX-TGD583/KX-TGD584/KX-TGD585/KX-TGE484 users:

- The supplied handset is pre-registered. You do not have to perform the following procedure.

- 1 Base unit:**
Press and hold [LOCATOR/INTERCOM] for about 5 seconds.
 - If all registered handsets start ringing, press [LOCATOR/INTERCOM] again to stop, then repeat this step.
- 2 Handset:**
Place the handset on the charger, then wait until a long beep sounds and is displayed.

Note:

- If an error tone sounds, or if is displayed, register the handset according to the base unit's operating instructions.

Display language

- 1** [MENU]#110
- 2** : Select the desired setting. → [SAVE] → [OFF]

Getting Started

Controls

Handset

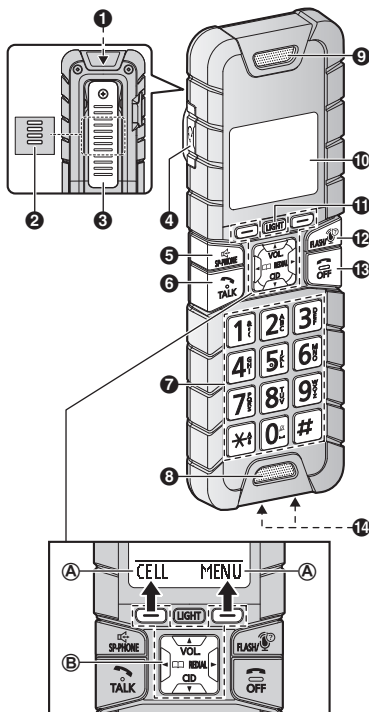

- 1 Flashlight**
- 2 Speaker**
 - The speaker is located behind the belt clip.
- 3 Belt clip**
- 4 Headset jack**

- 5 [SP-PHONE]** (SP-PHONE: Speakerphone)
- 6 [TALK]**
- 7 Dial keypad**
 - [*]: Temporary tone dialing
 - [0] (OFF): Ringer off
 - You can turn the ringer on/off by pressing and holding [0] (OFF) until the unit beeps.
- 8 Microphone**
- 9 Receiver**
- 10 Display**
- 11 [LIGHT]**
 - Press [LIGHT] to turn the flashlight on/off. The maximum lightning time is about 5 minutes.
- 12 [FLASH]** [ASSIST]
- 13 [OFF]**
- 14 Charge contacts**

Control type

A Soft keys

By pressing a soft key, you can select the feature shown directly above it on the display.

B Navigator key



- [▲], [▼], [◀], or [▶]: Scroll through various lists and items.
- VOL. (Volume: [▲] or [▼]): Adjust the receiver or speaker volume while talking.
- [◀] □ □: View the phonebook entry.
- [▶] REDIAL: View the redial list.
- [▼] CID (Caller ID): View the caller list.

Note:

- The preset melodies in this product ("Tone 3" - "Melody 10") are used with permission of © 2004-2013 Copyrights Vision Inc.
- You can switch the language for entering characters by the following procedure:
 [≡] → [↕]: Selecting the desired language.
 → [OK]



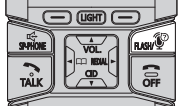









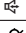
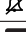

Handset key print

For the following functions, the key prints may differ for your original handset and KX-TGTA61.

	Function	Your original handset	KX-TGTA61
	Flash	[FLASH]	[FLASH]/[]
	Call waiting	[CALL WAIT]	[FLASH]/[]

Display icons

Handset display items

Item	Meaning
	Within base unit range
	Out of base unit range
	The line is in use. <ul style="list-style-type: none"> When flashing: The call is put on hold. When flashing rapidly: An incoming call is now being received.
	Eco mode is on.
	Noise reduction is set. (page 14)
	Equalizer is set. (page 14)
	Speakerphone is on.
	Ringer volume is off.
	Silent mode is on.
	Call sharing mode is off.
	Alarm is on.
	Handset number
	Battery level
	Blocked call
	Baby monitor is activated. The name/number displayed next to the icon indicates the monitoring unit. (page 14)
In use	Answering system is being used by another handset or the base unit.
Line in use	Someone is using the line.

Feature differences

Feature differences between your original handset and KX-TGTA61

■ **Following functions or operations may be different between your original handset and KX-TGTA61.**

Available for models with a base unit that supports the functions.

- Call block (page 12)
- Automated call block (page 13)
- Intercom, Transferring calls, conference calls (page 14)
- Power backup operation (This handset is not compatible.)
- Message indicator (This handset is not compatible.)
- Programming the base unit ringer volume beforehand for cellular line (KX-TGE460/KX-TGE470/KX-TGL460 series)

■ **Following functions can be used with KX-TGTA61.**

- Handset noise reduction*1 (page 14)
- Handset equalizer (page 14)
- Auto intercom (page 14)
- Baby monitor (page 14)
- Alarm (Memo alarm) (page 16)
- Intercom ringer volume/Intercom ringer tone (page 17)
- Change the handset name (page 17)
- Displaying the handset name (page 17)

*1 This feature is not available for KX-TGE660/KX-TGE670 series and KX-TG885SK.

Call block

Depending on your unit, the following operations and displays may be different.

Storing unwanted callers

If your unit is not available for “Block range of numbers”, you need to press **[SELECT]** after step 1 in “By entering phone numbers”.

Blocking incoming calls that have no phone number

Your original handset	KX-TGTA61
Block w/o num	Block unknown CID
On	Block
Off	Unblock

Turning the first ring on and off (Setting the first ring for the call block list)

Your original handset	KX-TGTA61
First ring	One ring for blocked call
On	Yes
Off	No

For users with [CALL BLOCK] button on the original handset

There is no [CALL BLOCK] button on KX-TGTA61 and you need to change the operating procedure instead of pressing [CALL BLOCK].

To disconnect the current call and add a phone number to the call block list

- When an outside call is being received
or
When an outside caller's message is being recorded:
Press **[BLOCK]** (right soft key) on the handset.
 - When you are talking on an outside call:
[MENU] → **[⇩]**: “Call block” → **[SELECT]**
- 2 Confirm the call block number and press **[YES]**.

Adding call blocked numbers from the caller list

Please change the operating procedure in step 3 instead of pressing [CALL BLOCK]

- **When a cellular phone is not paired:**
[MENU] → [↕]: “Save call block” → [SELECT]
- **When a cellular phone is paired:**
[SELECT] → [SAVE] → [↕]: “Call block” → [SELECT]

Differences in call block operations

You need to access the following features by using the direct command code or scrolling through the display menu instead of pressing the [CALL BLOCK] button, then continue the operation according to your base unit's operating instructions.

■ **Using the direct command code:**

Feature	Code
<ul style="list-style-type: none"> - Adding call blocked numbers manually - Storing a range of number - Viewing/editing/erasing call block numbers - Erasing all call block numbers 	[MENU] # 2 1 7
<ul style="list-style-type: none"> - Blocking incoming call that have no phone number 	[MENU] # 2 4 0
<ul style="list-style-type: none"> - Turning the first ring on/off (Setting not to ring once for blocked call) 	[MENU] # 1 7 3
<ul style="list-style-type: none"> - Displaying and clearing the blocked call count*1 	[MENU] # 1 7 7

*1 This feature is not available depending on your base unit.

- **Scrolling through the display menu:**
[MENU] → [↕]: “Settings” → [SELECT] → [↕]: “Call block” → [SELECT]

Automated call block

Differences in automated call block operations

There is no [CALL BLOCK] button on KX-TGTA61. You need to access the following features by using the direct command code or scrolling through the display menu instead of pressing the [CALL BLOCK] button, then continue the operation according to your base unit's operating instructions.

■ **Using the direct command code:**

Feature	Code
<ul style="list-style-type: none"> - Setting the automated call block 	[MENU] # 7 8 7
<ul style="list-style-type: none"> - Changing the access code 	[MENU] # 7 8 9
<ul style="list-style-type: none"> - Displaying and clearing the blocked call count 	[MENU] # 7 9 0
<ul style="list-style-type: none"> - Viewing/erasing an entry - Erasing all entries 	[MENU] # 7 9 4
<ul style="list-style-type: none"> - Recording a greeting message for automated call block 	[MENU] # 7 9 1
<ul style="list-style-type: none"> - Resetting to the pre-recorded greeting message for automated call block 	[MENU] # 7 9 3
<ul style="list-style-type: none"> - Playing back the greeting message for automated call block 	[MENU] # 7 9 2

- **Scrolling through the display menu:**
[MENU] → [↕]: “Settings” → [SELECT] → [↕]: “Automated call block” → [SELECT]

Feature differences

Intercom, Transferring calls, Conference calls

There is no [INTERCOM] button on KX-TGTA61 and you need to change the operating procedure instead of pressing [INTERCOM].

- 1 [MENU] → [↕]: "Intercom" → [SELECT]
- 2 [↕]: Select the desired unit. → [SELECT]

Handset noise reduction

This feature allows you to hear the voice of the person you are talking to more clearly, by reducing the surrounding noise coming from the other party's telephone.

- 1 Press [MENU] while talking.
- 2 [↕]: "Noise reduction on" or "Noise reduction off" → [SELECT]

Note:

- The setting you made is kept for each line (landline and cellular lines).
The default settings are as follows:
 - for landline: "Noise reduction off"
 - for cellular lines: "Noise reduction on"
- Depending on the environment where this handset is being used, this feature may not be effective.
- This feature is not available while using the speakerphone.

Handset equalizer

This feature clarifies the voice of the person you are talking to, producing a more natural-sounding voice that is easier to hear and understand.

- 1 Press [MENU] while talking.
- 2 [↕]: "Equalizer" → [SELECT]
- 3 [↕]: Select the desired setting.

- 4 Press [OK] to exit.

Note:

- The setting you made is kept for each line (landline and cellular lines).
- Depending on the condition and quality of your telephone line, this feature may emphasize existing line noise. If it becomes difficult to hear, turn this feature off.
- This feature is not available while using the speakerphone.
- When both the "Equalizer" setting and noise reduction are activated, [NR] is shown on the display.

Turning auto intercom on/off

This feature allows the handset to answer intercom calls automatically when it is called. You do not need to press [↶] or [↷]. When this feature is set to "On", the monitoring handset for the baby monitor feature (page 16) will also answer baby monitor calls automatically. The default setting is "Off".

- 1 [MENU]#273
- 2 [↕]: Select the desired setting. → [SAVE] → [OFF]

Note:

- This feature is not available for all handsets paging and voice paging even if it is turned on.

Baby monitor

This feature allows you to listen in on a room where another handset is located, allowing you to easily monitor from different areas of the house or even while away from home. The monitored handset (placed in a baby's room, for example) will automatically call the monitoring handset, base unit*1, or the phone number stored when it detects sound.

*1 Available for models with a SP-PHONE button on the base unit.

Important:

- Before using this feature, we recommend that you test this feature and adjust the baby monitor sensitivity as needed, especially if you plan to monitor from outside.
- This feature should not be used as a substitute for a medical or caregiver's supervision. It is the caregiver's responsibility to stay close enough to handle any eventuality.

Note:

- If the unit is connected to a PBX system, you cannot set the baby monitor.
- During the monitoring mode, battery consumption is faster than usual. We recommend leaving the monitored handset on the base unit or charger.
- The monitored handset never rings while it is being monitored. If the base unit is placed near the monitored handset, we recommend turning off the base unit ringer volume.

Setting the baby monitor

Perform the setting operation with the handset to be monitored (for example, the handset placed in a baby's room).

To monitor with a unit

The internal baby monitor feature is available:

- between handsets
- between a handset and the base unit*1

*1 Available for models with a SP-PHONE button on the base unit.

- 1 [MENU]#268
- 2 [↕]: "On" → [SELECT]
- 3 [↕]: Select the desired unit's number to monitor with. → [SAVE]
 - "Baby monitor" will be displayed.
 - The registered unit's name/number is displayed.

Note:

- When this feature is on, another handset or the base unit can hear the monitored handset by making an intercom call.

To monitor from outside

If you enable this feature, the unit will call a pre-programmed phone number when the handset detects sound. After you answer the call, you can listen in on the room where the handset is located.

This feature is only available for landline.

Important:

- KX-TGD583/KX-TGD584/KX-TGD585 users cannot assign a phone number from the phonebook. Please assign the phone number manually.

■ From the phonebook:

- 1 [MENU]#268
- 2 [↕]: "On" → [SELECT]
- 3 [↕]: Select "Outgoing call" to monitor from outside. → [ADD]
- 4 [↕]: "Phonebook" → [SELECT]*1
- 5 [↕]: Select the phonebook entry. → [SAVE]
 - "Baby monitor" will be displayed.

*1 If "Busy" is displayed after step 4, your unit cannot be assigned the phone number from the phonebook. Please assign the phone number manually.

Note:

- If you edit a phonebook entry which is assigned for monitoring, the edited entry does not transfer to the monitor.

■ By entering phone numbers:

- 1 [MENU]#268
- 2 [↕]: "On" → [SELECT]
- 3 [↕]: Select "Outgoing call" to monitor from outside. → [ADD]
- 4 [↕]: "Manual" → [SELECT]
- 5 Enter the desired name. → [OK]
- 6 Enter the desired number. → [OK] → [SELECT]
 - "Baby monitor" will be displayed.

Note:

- The registered name/number is displayed.

Feature differences

Turning off the baby monitor

The monitored handset cannot be used while baby monitor is set to "On".

- 1 Press **[MENU]** on the handset being monitored.
- 2 **[↕]**: "On/Off" → **[SELECT]**
- 3 **[↕]**: "Off" → **[SELECT]** → **[OFF]**

Editing an outside monitoring number

- 1 Press **[MENU]** on the handset being monitored.
- 2 **[↕]**: "On/Off" → **[SELECT]**
- 3 **[↕]**: "On" → **[SELECT]**
- 4 **[↕]**: Select the outside line.
- 5 **[MENU]** → **[↕]**: "Edit" → **[SELECT]**
- 6 Edit the name if necessary. → **[OK]**
- 7 Edit the phone number if necessary. → **[OK]** → **[SELECT]**

Erasing an outside monitoring number

- 1 Press **[MENU]** on the handset being monitored.
- 2 **[↕]**: "On/Off" → **[SELECT]**
- 3 **[↕]**: "On" → **[SELECT]**
- 4 **[↕]**: Select the outside line.
- 5 **[MENU]** → **[↕]**: "Erase" → **[SELECT]**
- 6 **[↕]**: "Yes" → **[SELECT]** → **[OFF]**

Baby monitor sensitivity

You can adjust the sensitivity of the baby monitor. Increase or decrease the sensitivity to adjust the sound level needed to trigger the baby monitor feature.

- This feature cannot be set during a monitoring call.
- 1 Press **[MENU]** on the handset being monitored.
 - 2 **[↕]**: "Sensitivity level" → **[SELECT]**

- 3 **[↕]**: Select the desired setting. → **[SAVE]** → **[OFF]**

Answering the baby monitor

Handset: Press **[↵]** to answer a call.

Base unit: Press **[↵]** to answer a call*1.

*1 Available for models with a SP-PHONE button on the base unit.

If you want to respond from the monitoring unit, press **[MUTE]**.

- The monitoring unit will answer calls automatically when the auto intercom feature is set to "On".

Note:

- If you receive an outside call when communicating with the monitored handset, the interrupt tone sounds.
 - To answer the call with the handset, press **[OFF]**, then press **[↵]**.
 - To answer the call with the base unit, press **[↵]** 3 times.*1,*2

*1 If **[MUTE]** is pressed, press **[↵]** 2 times.

*2 If your base unit does not correspond to the baby monitor, press **[↵]** 2 times.

Alarm (Memo alarm)

An alarm sounds at the set time for 1 minute and is repeated 5 times at 5 minute intervals (snooze function). A text memo can also be displayed for the alarm. A total of 3 separate alarm times can be programmed for each handset. You can set one of 3 different alarm options (once, daily, or weekly) for each alarm time.

Important:

- Make sure the unit's date and time setting is correct.

- 1 **[MENU]** **[#]** **[7]** **[2]** **[0]**
- 2 **[↕]**: Select the desired alarm. → **[SELECT]**

- 3 **[↕]**: Select the desired alarm option. →
[SELECT]

“Off” Turns alarm off. Go to step 10.
“Once” An alarm sounds once at the set time.
“Daily” An alarm sounds daily at the set time. Go to step 5.
“Weekly” Alarm sounds weekly at the set time(s).

- 4 Proceed with the operation according to your selection in step 3.
- **Once:**
Enter the desired month and date. →
[OK]
 - **Weekly:**
[↕]: Select the desired day of the week and press **[SELECT]**. → **[OK]**
- 5 Set the desired time.
- 6 **[X]**: Select “AM” or “PM”. → **[OK]**
- 7 Enter a text memo (10 characters max.). → **[OK]**
- 8 **[↕]**: Select the desired alarm tone. →
[SELECT]
- We recommend selecting a different ringer tone from the one used for outside calls.
- 9 **[↕]**: Select the desired snooze setting. →
[SAVE]
- 10 **[SELECT]** → **[OFF]**

Note:

- Press **[STOP]** to stop the alarm completely.
- When the handset is in use, the alarm will not sound until the handset is in standby mode.
- Press any dial key or **[SNOOZE]** to stop the sound but keep the snooze function activated.
- If you want to make an outside call when the snooze function is activated, please stop the snooze function before making the call.

Intercom ringer volume/ Intercom ringer tone

You can change the handset ringer volume and ringer tone for intercom.

- 1 **To change the ringer volume:**
[MENU]**#****[1]****[7]****[5]**
To change the ringer tone:
[MENU]**#****[1]****[6]****[3]**
- 2 **[↕]**: Select the desired setting. →
[SAVE]

Changing the handset name

The default handset name is “Handset 1” to “Handset 6”. You can customize the name of each handset (“Bob”, “Kitchen”, etc.). This is useful when you make intercom calls between handsets. To display the handset name in standby mode, turn on the handset name display feature (page 17).

- 1 **[MENU]****#****[1]****[0]****[4]**
- 2 Enter the desired name (10 characters max.). → **[SAVE]** → **[OFF]**

Displaying the handset name

You can select whether or not the handset name is displayed in standby mode. The default setting is “off”.

- 1 **[MENU]****#****[1]****[0]****[5]**
- 2 **[↕]**: Select the desired setting. →
[SAVE] → **[OFF]**

Appendix

FCC and other information

This equipment is hearing aid compatible as defined by the FCC in 47 CFR Section 68.316.

When you hold the phone to your ear, noise might be heard in your Hearing Aid. Some Hearing Aids are not adequately shielded from external RF (radio frequency) energy. If noise occurs, use an optional headset accessory or the speakerphone option (if applicable) when using this phone. Consult with your audiologist or Hearing Aid manufacturer about the availability of Hearing Aids which provide adequate shielding to RF energy commonly emitted by digital devices.

WHEN PROGRAMMING EMERGENCY NUMBERS AND/OR MAKING TEST CALLS TO EMERGENCY NUMBERS:

- 1) Remain on the line and briefly explain to the dispatcher the reason for the call.
- 2) Perform such activities in the off-peak hours, such as early morning or late evenings.

This device complies with Part 15 of the FCC Rules. Operation is subject to the following two conditions:

(1) This device may not cause harmful interference, and (2) this device must accept any interference received, including interference that may cause undesired operation.

Privacy of communications may not be ensured when using this phone.

CAUTION:

Any changes or modifications not expressly approved by the party responsible for compliance could void the user's authority to operate this device.

NOTE:

This equipment has been tested and found to comply with the limits for a Class B digital device, pursuant to Part 15 of the FCC Rules. These limits are designed to provide reasonable protection against harmful interference in a residential installation. This equipment generates, uses, and can radiate radio frequency energy and, if not installed and used in accordance with the instructions, may cause harmful interference to radio communications. However, there is no guarantee that interference will not occur in a particular installation. If this equipment does cause harmful interference to radio or television reception, which can be determined by turning the equipment off and on, the user is encouraged to try to correct the interference by one or more of the following measures:

- Reorient or relocate the receiving antenna.
- Increase the separation between the equipment and receiver.
- Connect the equipment into an outlet on a circuit different from that to which the receiver is connected.
- Consult the dealer or an experienced radio/TV technician for help.

FCC RF Exposure Warning:

- This product complies with FCC radiation exposure limits set forth for an uncontrolled environment.
- This handset may not be collocated or operated in conjunction with any other antenna or transmitter.
- The handset may be carried and operated with only the specific provided belt-clip. Other non-tested belt-clips or similar body-worn accessories may not comply and must be avoided.

Notice:

- FCC ID can be found inside the battery compartment or on the bottom of the unit.

Customer services

Shop
Accessories!

for all your Panasonic gear

Go to

<http://shop.panasonic.com/support>

Get everything you need to get the most out of
your Panasonic products
Accessories & Parts for your Camera, Phone, A/V
products, TV, Computers & Networking, Personal
Care, Home Appliances, Headphones, Batteries,
Backup Chargers & more...

Customer Services Directory

For Product Information, Operating Assistance,
Parts, Owner's Manuals, Dealer and Service info
go to <http://shop.panasonic.com/support>

For the hearing or speech impaired TTY: 1- 877-833-8855

As of June 2015

Appendix

Limited Warranty (ONLY FOR U.S.A.)

Panasonic Products Limited Warranty

Limited Warranty Coverage (For USA Only)

If your product does not work properly because of a defect in materials or workmanship, Panasonic Corporation of North America (referred to as “the warrantor”) will, for the length of the period indicated on the chart below, which starts with the date of original purchase (“warranty period”), at its option either (a) repair your product with new or refurbished parts, (b) replace it with a new or a refurbished equivalent value product, or (c) refund your purchase price. The decision to repair, replace or refund will be made by the warrantor.

Product or Part Name	Parts	Labor
Telephone	One (1) Year	One (1) Year

During the “Labor” warranty period there will be no charge for labor. During the “Parts” warranty period, there will be no charge for parts. This Limited Warranty excludes both parts and labor for non-rechargeable batteries, antennas, and cosmetic parts (cabinet). This warranty only applies to products purchased and serviced in the United States. This warranty is extended only to the original purchaser of a new product which was not sold “as is”.

Mail-In Service--Online Repair Request

Online Repair Request

To submit a new repair request and for quick repair status visit our Web Site at <http://shop.panasonic.com/support>

When shipping the unit, carefully pack, include all supplied accessories listed in the Owner’s Manual, and send it prepaid, adequately insured and packed well in a carton box. When shipping Lithium Ion batteries please visit our Web Site at <http://shop.panasonic.com/support> as Panasonic is committed to providing the most up to date information. Include a letter detailing the complaint, a return address and provide a daytime phone number where you can be reached. A valid registered receipt is required under the Limited Warranty.

IF REPAIR IS NEEDED DURING THE WARRANTY PERIOD, THE PURCHASER WILL BE REQUIRED TO FURNISH A SALES RECEIPT/PROOF OF PURCHASE INDICATING DATE OF PURCHASE, AMOUNT PAID AND PLACE OF PURCHASE. CUSTOMER WILL BE CHARGED FOR THE REPAIR OF ANY UNIT RECEIVED WITHOUT SUCH PROOF OF PURCHASE.

Limited Warranty Limits and Exclusions

This warranty ONLY COVERS failures due to defects in materials or workmanship, and DOES NOT COVER normal wear and tear or cosmetic damage. The warranty ALSO DOES NOT COVER damages which occurred in shipment, or failures which are caused by products not supplied by the warrantor, or failures which result from accidents, misuse, abuse, neglect, mishandling, misapplication, alteration, faulty installation, set-up adjustments, misadjustment of consumer controls, improper maintenance, power line surge, lightning damage, modification, introduction of sand, humidity or liquids, commercial use such as hotel, office, restaurant, or other business or rental use of the product, or service by anyone other than a Factory Service Center or other Authorized Servicer, or damage that is attributable to acts of God.

THERE ARE NO EXPRESS WARRANTIES EXCEPT AS LISTED UNDER "LIMITED WARRANTY COVERAGE".

THE WARRANTOR IS NOT LIABLE FOR INCIDENTAL OR CONSEQUENTIAL DAMAGES RESULTING FROM THE USE OF THIS PRODUCT, OR ARISING OUT OF ANY BREACH OF THIS WARRANTY.

(As examples, this excludes damages for lost time, travel to and from the servicer, loss of or damage to media or images, data or other memory or recorded content. The items listed are not exclusive, but for illustration only.)

ALL EXPRESS AND IMPLIED WARRANTIES, INCLUDING THE WARRANTY OF MERCHANTABILITY, ARE LIMITED TO THE PERIOD OF THE LIMITED WARRANTY.

Some states do not allow the exclusion or limitation of incidental or consequential damages, or limitations on how long an implied warranty lasts, so the exclusions may not apply to you. This warranty gives you specific legal rights and you may also have other rights which vary from state to state. If a problem with this product develops during or after the warranty period, you may contact your dealer or Service Center. If the problem is not handled to your satisfaction, then write to:

Consumer Affairs Department
Panasonic Corporation of North America
661 Independence Pkwy
Chesapeake, VA 23320

PARTS AND SERVICE, WHICH ARE NOT COVERED BY THIS LIMITED WARRANTY, ARE YOUR RESPONSIBILITY.

As of June 2015

Appendix

IMPORTANT!

If your product is not working properly. . .

- ① Reconnect AC adaptor to the base unit.
- ② Check if telephone line cord is connected.
- ③ Use rechargeable Ni-MH batteries.
(Alkaline/Manganese/Ni-Cd batteries CANNOT be used.)
- ④ Read **troubleshooting** page in the **Operating Instructions**.



Visit our Web site: <http://shop.panasonic.com/support>

- FAQ and troubleshooting hints are available.

Graphical symbols for use on equipment and their descriptions

Symbol	Explanation	Symbol	Explanation
	Alternating current (A.C.)		Class II equipment (equipment in which protection against electric shock relies on Double Insulation or Reinforced Insulation)
	Direct current (D.C.)		"ON" (power)
	Protective earth		"OFF" (power)
	Protective bonding earth		Stand-by (power)
	Functional earth		"ON"/"OFF" (power; push-push)
	For indoor use only		Caution, risk of electric shock

Panasonic Corporation of North America

Two Riverfront Plaza, Newark, NJ 07102-5490

© Panasonic Corporation 2018

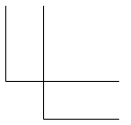
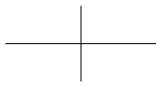
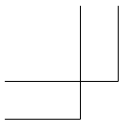

Notes

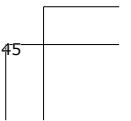
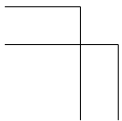
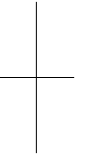
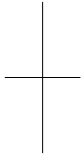

Pasos iniciales

[#] → [*]: Seleccione el idioma deseado. → [OK]

Símbolo en teclas del auricular

Para las siguientes funciones, las teclas son diferentes para el auricular original y KX-TGA61.

Función	Su auricular original	KX-TGA61
Llamada en espera	[FLASH] / [CALL WAIT]	[FLASH] / []
Flash	[FLASH]	[FLASH] / []

Iconos de la pantalla

Elementos de la pantalla del auricular

Artículos	Significado
	Dentro del alcance de la unidad base
	Fuera del alcance de la unidad base
	La línea se está usando.
	<ul style="list-style-type: none"> ● Cuando parpadea lentamente: la llamada se ha puesto en espera. ● Cuando parpadea rápidamente: se está recibiendo una llamada entrante.
	El modo ecológico está encendido.
	La reducción de ruido está configurada.
	El ecualizador está configurado.
	El altavoz está encendido.
	El volumen del timbre está apagado.
	El modo silencioso está encendido.
	El modo de llamadas compartidas está apagado.
	La alarma está encendida.
	Número del auricular
	Nivel de la batería
	Llamada bloqueada
	El monitor para bebés está activado. El nombre/número que aparece junto al icono no indica la unidad de monitoreo.
	Otro auricular o la unidad base están usando el contestador de llamadas.
	Alguien está usando la línea.

Pasos Iniciales

- 2 [↵]: Seleccione la configuración deseada. → [GUARDAR] → [OFF]

Controles

Auricular

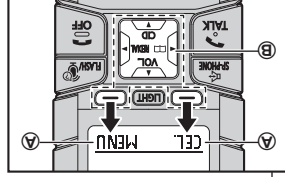
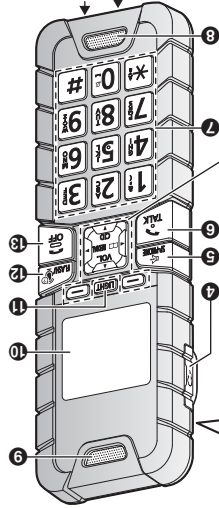
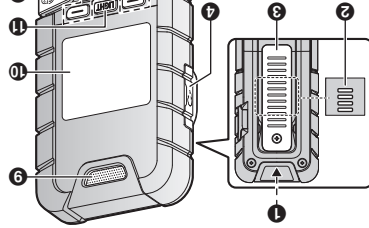

- 1 **Linterna**
 - 2 **Altavoz**
- El altavoz se encuentra detrás del sujetador para cinturón.

- Las melodías predeterminadas en este producto ("Tono 3" - "Melodía 10") se utilizan con permiso de © 2004-2013 Copyrights Vision Inc.
- Puede cambiar el idioma para introducir caracteres mediante el siguiente procedimiento:

Nota:

- [▲] CID (identificador de llamadas): ver la lista de personas que llamaron.
 - [▶] REDIAL: ver la lista de remarca-teléfono.
 - [▶] []: ver la entrada del directorio mientras habla.
 - VOL. (Volumen: [▲] o [▼]): ajustar el volumen del receptor o el altavoz
 - [▲], [▼], [▶] o [◀]: Navegar por di-versas listas y elementos.
 - [▲], [▼], [▶] o [◀]: Navegar por di-versas listas y elementos.
- Al oprimir una tecla de función, puede seleccionar la función que aparece direc-tamente encima de ella en la pantalla.

Tipos de controles

- 11 **Micrófono**
- 10 **Pantalla**
- 9 **Receptor**
- 8 **[LUZ]** para encender o apagar la linterna. El tiempo má-ximo de iluminación es de 5 mi-nutos.
- 7 **[FLASH] (AYUDA)**
- 6 **[OFF]**
- 5 **Contatos de carga**

Pasos iniciales

Extracción de la batería

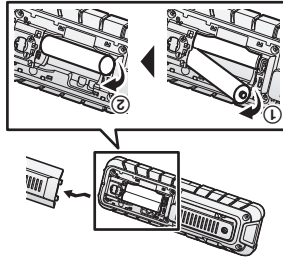

Carga de las baterías

- Cargue aproximadamente durante 7 horas.
- Confirme que se muestre "Cargando" (🔋).
- Una vez que las baterías están completamente cargadas, aparece "Carg. comp."



Nota:

- Si las baterías están completamente cargadas pero el tiempo de funcionamiento parece ser más corto, limpie los extremos de las baterías (⊕) y los contactos de carga con un paño seco y cárguelas de nuevo.

Nivel de la batería

Icono	Nivel de la batería
	Alta
	Media
	Baja
	Necesita cargarse.
	Vacía

Rendimiento de las baterías Ni-MH recargables (baterías que se suministran)

Operación	Tiempo de funcionamiento	Mientras no esté en uso (en espera)
	8.5 horas máx.*1	4 días máx.*1

- *1 Si el modo ecológico está encendido, excepto cuando se usan las funciones de enlace a celular y de linterna.

Nota:

- El rendimiento real de la batería depende del uso y del entorno ambiental.

Cómo registrar un auricular a una unidad base

- Para usuarios de KX-TGD583/KX-TGD584/ KX-TGD585/KX-TG484: El auricular suministrado ya ha sido registrado. No es necesario realizar el siguiente procedimiento.

1 Unidad base:

Optima y mantenga oprimido [LOCATOR/INTERCOM] durante aproximadamente 5 segundos.

- Si todos los auriculares registrados comienzan a timbrar, oprima [LOCATOR/INTERCOM] de nuevo para detenerlos y después repita este paso.

2 Auricular:

Coloque el auricular en el cargador y espere hasta que suene un pitido largo y aparezca



Nota:

- Si suena un tono de error, o si se muestra

regístre el auricular de acuerdo con las instrucciones de operación de la unidad base.

Idioma de la pantalla

1 [MENU] [] [] [] []

Pasos Iniciales

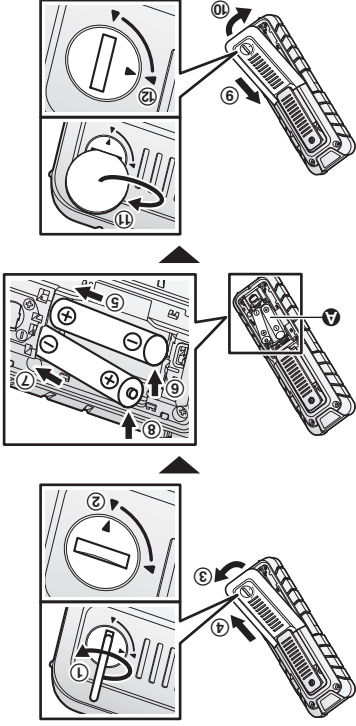
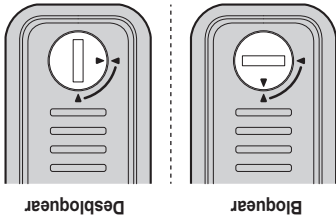

Instalación

Conexiones/Montaje en la pared

- ① Conecte el adaptador de corriente a la toma de corriente.
- ② Si lo requiere, inserte los tornillos (A) (no se suministran) en la pared.
- ③ 27,2 mm (1 1/16 pulgadas)



Nota:

- El adaptador de corriente debe permanecer conectado en todo momento (es normal que el adaptador se caliente durante su uso).
- Asegúrese de que la pared y el método de colocación sean lo suficientemente resistentes para soportar el peso de la unidad.

Instalación de las baterías

Importante:

- Utilice las baterías recargables que se suministran. Para reemplazarlas, recomendamos el uso de las baterías recargables Panasonic que se especifican en la página 2.
- USE SOLO baterías recargables de NI-MH tamaño AAA (R03).
- NO utilice baterías alcalinas, de manganeso ni de Ni-Cd.
- Confirme que las polaridades estén correctas (+), (-).
- Al desbloquear (①) o bloquear (②) la tapa de la batería, asegúrese de alinear las posiciones de las flechas.
- Por favor no gire más que excesivamente.

Para usuarios de KX-TGD583/KX-TGD584/ KX-TGD585/KX-TGE484:

- Siga las instrucciones de la pantalla para configurar la unidad.

Instalación

Para usuarios de KX-TGE484

Para obtener detalles sobre las operaciones, consulte el manual de instrucciones de la unidad base adjunto.

Nota:

- Algunas funciones de KX-TGTa61 son ligeramente diferentes a las descripciones del manual de instrucciones de la unidad base.

Composición del modelo

Serie	Modelo Nº	Auricular	
		Unidad base	Pieza Nº
Serie KX-TGE470	KX-TGE484	KX-TGE470	KX-TGTa61
		KX-TGEA40	1
		Pieza Nº	Cantidad

Accesorios que se suministran

Accesorio/Pieza número	Cantidad
Adaptador de corriente/PNLV226-0X	1
Cable de línea telefónica ¹	1
Adaptador de instalación en pared/PNKL1044Y1	1
Baterías recargables ²	8
Tapa del auricular para KX-TGEA40 ³ /PNYNTGTEA20SR	3
Sujetador para cinturón para KX-TGEA40/PNKE1312Z1	3
Cargador para KX-TGEA40/PNLC4050ZS	2
Tapa del auricular para KX-TGTa61 ³ /PNYNAGTA61BR	1
Sujetador para cinturón para KX-TGTa61 ⁴ /PNZMAGTA61BR	1
Cargador para KX-TGTa61/PNLC1083ZB	1

- ¹ PQJA10075Y (cable negro), PQJA10075Z (cable transparente)
- ² Consulte la página 2 para obtener información acerca de la batería de reemplazo.
- ³ La tapa del auricular viene unida a él.
- ⁴ El sujetador para cinturón viene unido al auricular.

Instalación

Para usuarios de KX-TGD583/KX-TGD584/KX-TGD585

Para obtener detalles sobre las operaciones, consulte el manual de instrucciones de la unidad base adjunto.
Nota:
 ● Algunas funciones de KX-TGA61 son ligeramente diferentes a las descripciones del manual de instrucciones de la unidad base.

Composición del modelo

Serie	Modelo Nº	Unidad base		Auricular	
		Pieza Nº	Pieza Nº	Pieza Nº	Cantidad
Serie KX-TGD560	KX-TGD583	KX-TGD560	KX-TGA51	2	1
			KX-TGA61	1	1
	KX-TGD584	KX-TGD560	KX-TGA51	3	1
			KX-TGA61	1	1
	KX-TGD585	KX-TGD560	KX-TGA51	4	1
			KX-TGA61	1	1

Accesorios que se suministran

Accesorio/Pieza número	Cantidad	
	KX-TGD583	KX-TGD584
Adaptador de corriente/PNLV226-0X	1	1
Cable de línea telefónica ¹	1	1
Adaptador de instalación en pared/PNKL1044Y2	1	1
Baterías recargables ²	6	8
Tapa del auricular para KX-TGDA51 ³ /PNYNTGDA50BR	2	3
Cargador para KX-TGDA51/PNLGC1077LB	1	2
Tapa del auricular para KX-TGTA61 ³ /PNYNAAGTA61BR	1	1
Sujetador para cinturón para KX-TGTA61 ⁴ /PNZMAG-TA61BR	1	1
Cargador para KX-TGA61/PNLGC1083ZB	1	1

- *1 PNLJA1186Z (cable negro), PNLJA1193Z (cable transparente)
- *2 Consulte la página 2 para obtener información acerca de la batería de reemplazo.
- *3 La tapa del auricular viene unida a él.
- *4 El sujetador para cinturón viene unido al auricular.

Instalación

Información de los accesorios

Accesorios que se suministran

Accesorio/Pieza número	Cantidad
Cargador/PNL1083ZB	1
Baterías recargables**	2
Tapa del auricular*/PNYNAGTA61BR	1
Sujetador para cinturón*/PNZMAGTA61BR	1

*1 Consulte la página 2 para obtener información acerca de la batería de reemplazo.

*2 La tapa del auricular viene unida a él.

*3 El sujetador para cinturón viene unido al auricular.

Accesorios adicionales y de reemplazo

Accesorio	Número de modelo/Especificaciones
Baterías recargables	HHR-4DPA*1 ● Para realizar un pedido, visite http://shop.panasonic.com/support
Aurifono	KX-TCA93, KX-TCA430

*1 Las baterías de reemplazo pueden tener una capacidad diferente a la de las baterías que se suministran.

Otra información

- El diseño y especificaciones están sujetos a cambio sin previo aviso.
- Las ilustraciones de estas instrucciones pueden ser ligeramente diferentes al producto.
- En algunas funciones, las operaciones son ligeramente diferentes a las descripciones del manual de instrucciones de la unidad base.
- Es posible que algunas funciones descritas en el manual de instrucciones de la unidad base no estén disponibles.

Auricular inalámbrico resistente adicional
Modelo Nº **KX-TGTA61**

**Teléfono inalámbrico Link2Cell con
contestador de llamadas digital + auricular resistente**

Modelo Nº **KX-TGD583**

KX-TGD583

KX-TGD584

KX-TGD585

KX-TGE484

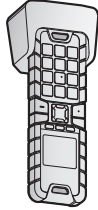

El modelo que se muestra es el TGT A61

Gracias por adquirir un producto Panasonic.

Este manual de instalación solo describe los pasos necesarios para registrar y comenzar a usar la unidad auricular. Para obtener más detalles, lea el manual de instrucciones de la unidad base antes de usar la unidad. Y guárdelo para consultarlo en el futuro.
Para obtener ayuda, visite nuestro sitio web: <http://shop.panasonic.com/support> para clientes en los EE. UU. (solo en inglés).