

Panasonic[®]

Installation Guide

Home Network System
Outdoor Camera

Model No. **KX-HNC600**



Thank you for purchasing a Panasonic product.

This document explains how to install the outdoor camera properly.
For details about how to use the system, refer to the User's Guide (page 26).

Please read this document before using the unit and save it for future reference.

For assistance, visit our Web site: www.panasonic.com/support
for customers in the U.S.A. or Puerto Rico.

Please register your product: www.panasonic.com/prodreg

Printed in China

Table of Contents

Introduction

Accessory information3

Important Information

About this system4

For your safety4

Important safety instructions5

For best performance5

Privacy and rights of portrait6

Other information6

Installation Location

Wireless communication range8

Information about sensor features8

Installation location examples11

Do not install in these locations13

Setup

Part names and functions15

LED indicator15

Setup overview15

Registering the camera16

Confirming the registration area16

Installation17

Appendix

Testing the motion detection range22

Adjusting the infrared sensor range22

Features available when using the [Home
Network] app26

Accessing the User's Guide26

Specifications27

FCC and other information28

Customer services29

Warranty (For United States and Puerto
Rico)30

Accessory information

Supplied accessories

No.	Accessory item/Part number	Quantity
①	AC adaptor/PNLV2360Z	1
②	Camera mounting stand/PNZB1002Z	1
③	Wall mounting screws (25 mm (1 inch))/XTB4+25AVW	4
④	Suspension wire tool – Safety wire: 1 PQME10080Z – Washers: 2 Small washer for attaching safety wire to camera \varnothing 12 mm (15/32 inches)/XWG26D12VW Large washer for attaching safety wire to wall \varnothing 16 mm (5/8 inches)/XWG4F16VW – Screws: 2 Small screw for attaching safety wire to camera 10 mm (3/8 inches)/XTB26+10GVW Large screw for attaching safety wire to wall 25 mm (1 inch)/XTB4+25AVW	1
⑤	Sensor range cap/PNHG1210Z	1



Other information

- Design and specifications are subject to change without notice.
- The illustrations in these instructions may vary slightly from the actual product.

Trademarks

- microSDHC is a trademark of SD-3C, LLC.
- iPhone and iPad are registered trademarks of Apple Inc.
- Android is a trademark of Google Inc.
- All other trademarks identified herein are the property of their respective owners.

Notice

- The hub supports microSD and microSDHC memory cards. In this document, the term "microSD card" is used as a generic term for any of the supported cards.

Important Information

About this system

This system is an auxiliary system; it is not designed to provide complete protection from property loss. Panasonic will not be held responsible in the event that property loss occurs while this system is in operation.

For your safety

To prevent severe injury and loss of life/property, read this section carefully before using the product to ensure proper and safe operation of your product.

WARNING

Power connection

- Use only the power source marked on the product.
- Do not overload power outlets and extension cords. This can result in the risk of fire or electric shock.
- Completely insert the AC adaptor/power plug into the power outlet. Failure to do so may cause electric shock and/or excessive heat resulting in a fire.
- Regularly remove any dust, etc. from the AC adaptor/power plug by pulling it from the power outlet, then wiping with a dry cloth. Accumulated dust may cause an insulation defect from moisture, etc. resulting in a fire.
- Unplug the product from power outlets if it emits smoke, an abnormal smell, or makes an unusual noise. These conditions can cause fire or electric shock. Confirm that smoke has stopped emitting and contact us at www.panasonic.com/contactinfo
- Unplug from power outlets and never touch the inside of the product if its casing has been broken open. Danger of electric shock exists.
- Never touch the plug with wet hands. Danger of electric shock exists.
- Do not connect non-specified devices.
- When opening holes in walls for installation or wiring, or when securing the power cord,

make sure you do not damage existing wiring and ductwork.

- Do not leave the power cable exposed outdoors.

Installation

- To prevent the risk of fire or electrical shock, do not expose the product to rain or any type of moisture.
- Do not place or use this product near automatically controlled devices such as automatic doors and fire alarms. Radio waves emitted from this product may cause such devices to malfunction resulting in an accident.
- Do not allow the power cord to be excessively pulled, bent or placed under heavy objects.
- Do not mount the bracket in an unstable location, in a location subject to frequent vibration, on a ceiling, or on a weak wall. (Do not mount on gypsum board, concrete blocks, wooden materials exposed to the outdoors, walls with very rough surfaces, or surfaces that are narrower than the width of the wall mount bracket.) There is a risk of injury if the product falls, or of fire or electric shock if water enters the product.
- Keep small parts (microSD cards, screws, washers, sensor range caps, etc.) out of the reach of children. There is a risk of swallowing. In the event they are swallowed, seek medical advice immediately.

Operating safeguards

- Unplug the product from power outlets before cleaning. Do not use liquid or aerosol cleaners.
- Do not disassemble the product.
- Keep the sensor range caps out of the reach of children. There is a risk of swallowing. In the event they are swallowed, seek medical advice immediately.
- Never put metal objects inside the product. If metal objects enter the product, turn off the circuit breaker and contact an authorized service center.

Medical

- Consult the manufacturer of any personal medical devices, such as pacemakers or hearing aids, to determine if they are adequately shielded from external RF (radio frequency) energy. DECT features operate between 1.92 GHz and 1.93 GHz with a peak transmission power of 115 mW.
- Do not use the product in health care facilities if any regulations posted in the area instruct you not to do so. Hospitals or health care facilities may be using equipment that could be sensitive to external RF energy.

CAUTION

Installation and location

- Never install wiring during a lightning storm.
- Although this product conforms to the IPX5* code, do not intentionally expose it to water. *IPX5 indicates that the product is protected against water jets: water projected at all angles through a 6.3 mm nozzle flow rate of 12.5 liters/minute at a pressure of 30 kN/m² for 3 minutes from a distance of 3 meters.
- The AC adaptor is used as the main disconnect device. Ensure that the AC outlet is installed near the product and is easily accessible.
- If the wiring is underground, do not make any connections underground.
- If the wiring is underground, make sure the power cable and other wiring is properly waterproofed by running the cables through a conduit.

Preventing accidents and injuries

- The safety wire must be used when mounting the product. There is a risk of injury if the product falls.
- Do not put your ear(s) near the speaker, as loud sounds emitted from the speaker may cause hearing impairment.
- Do not look directly at the LED lights when they are lit. Failure to do so may cause damage to eyes.

Important safety instructions

When using your product, basic safety precautions should always be followed to reduce the risk of fire, electric shock, and injury to persons, including the following:

1. Do not use this product near water for example, near a bathtub, washbowl, kitchen sink, or laundry tub, in a wet basement or near a swimming pool.
2. Use only the power cord indicated in this document.

SAVE THESE INSTRUCTIONS

For best performance

Hub location/avoiding noise

The hub and other compatible Panasonic devices use radio waves to communicate with each other.

- For maximum coverage and noise-free communications, place your hub:
 - at a convenient, high, and central location with no obstructions between the product and hub in an indoor environment.
 - away from electronic appliances such as TVs, radios, personal computers, wireless devices, or other phones.
 - facing away from radio frequency transmitters, such as external antennas of mobile phone cell stations. (Avoid putting the hub on a bay window or near a window.)
- If the reception for a hub location is not satisfactory, move the hub to another location for better reception.

Environment

- Keep the product away from electrical noise generating devices, such as fluorescent lamps and motors.
- The product should be kept free from excessive smoke, dust, high temperature, and vibration.

Important Information

- Do not expose this product to direct sunlight or other forms of powerful light such as halogen lights for long periods of time. (This may damage the image sensor.)
- Do not place heavy objects on top of the product.
- When you leave the product unused for a long period of time, unplug the product from the power outlet.
- The product should be kept away from heat sources such as heaters, kitchen stoves, etc. It should not be placed in rooms where the temperature is less than -20 °C (-4 °F) or greater than 50 °C (122 °F). Damp basements should also be avoided.
- Do not allow the lens cover or the infrared sensor to become scratched or dirty. (This may cause image quality to be reduced, incorrect detections, malfunctions, or damage to the lens cover and infrared sensor.)
- Operating the product near electrical appliances may cause interference. Move away from the electrical appliances.

Privacy and rights of portrait

When installing or using the camera, please take into consideration the rights of others with regard to privacy.

It is generally said that "privacy" means the ability of an individual or group to stop information about themselves from becoming known to people other than those whom they choose to give the information. "Rights of portrait" means the right to be safe from having your own image taken and used indiscriminately without consent.

Other information

Routine care

- To prevent incorrect detections, unplug the product before performing routine care.
- Wipe the outer surface of the product with a soft moist cloth.

- Do not use benzine, thinner, or any abrasive powder.
- Do not apply running water to the product.

Camera image quality

- Camera images may have the following characteristics.
 - Colors in images may differ from the actual colors.
 - When there is light behind the subject (i.e., backlighting), faces may appear dark.
 - Image quality may be reduced in dark locations.
 - Images may appear hazy when there are outdoor lights in use.

Protecting your recordings

- Do not remove the microSD card or disconnect the hub's AC adaptor while reading or writing data to the microSD card. Data on the card could become corrupted.
- If a microSD card malfunctions or is exposed to electromagnetic waves or static electricity, data on the card could become corrupted or erased. Therefore we recommend backing up important data to a computer or other device.

Important Information

Notice

- This product is designed for use in the United States of America. Sale or use of this product in other countries may violate local laws.
- Cet appareil est conçu pour être utilisé aux États-Unis d'Amérique. La vente ou l'emploi de cet appareil dans certains autres pays peut constituer une infraction à la législation locale.
- Este producto está diseñado para usarse en los Estados Unidos de América. La venta o el empleo de este producto en ciertos países puede constituir violación de la legislación local.
- 本產品專為美國使用而設。若在其他國家銷售或使用，可能會違反當地法例。
- この製品は、日本国外での使用を目的として設計されており、日本国内での使用は法律違反となります。従って、当社では日本国内においては原則として修理などのサービスは致しかねます。

Installation Location

Wireless communication range

The wireless communication range of each device in the system from the hub is approximately 50 m (160 feet) indoors and approximately 300 m (1,000 feet) outdoors. Wireless communication may be unreliable when the following obstacles are located between the hub and other devices.

- Metal doors or screens
- Walls containing aluminum-sheet insulation
- Walls made of concrete or corrugated iron
- Double-pane glass windows
- Multiple walls
- When using each device on separate floors or in different buildings

Note:

- The camera's LED indicator blinks quickly in red if it is out of range of the hub. In this case, confirm all connections, including those of the hub.

Information about sensor features

The camera has 2 sensor features that are used for motion detection: a visual sensor and an infrared sensor (i.e., heat sensor).

Please read the following information before deciding where to install the camera.

Note:

- The camera's sensor features are not designed to be used in situations that require high reliability. We do not recommend use of the sensor features in these situations.
- Panasonic takes no responsibility for any injury or damage caused by the use of the camera's sensor features.

Detection method

Visual sensor	Infrared sensor
The camera detects changes in the images being displayed. <ul style="list-style-type: none">● The camera detects changes in the brightness levels of moving objects.	The camera detects temperature differences of objects in the images being displayed. <ul style="list-style-type: none">● The infrared sensor uses infrared rays to detect temperature differences within its range that are emitted naturally by people, animals, etc.

Installation Location

Detection range

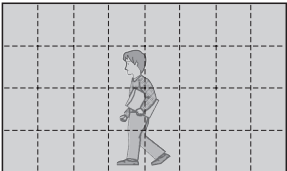
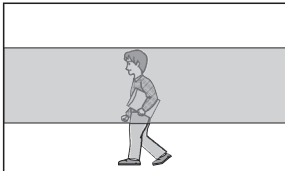
Visual sensor	Infrared sensor
<p>Can detect motion anywhere in the visible image.</p>  <p>The diagram shows a person walking from left to right across a grid of dashed lines. The grid covers the entire visible area, indicating that motion is detected anywhere within this range.</p> <ul style="list-style-type: none"> You can adjust the area detectable by the visual sensor. For more information, refer to the User's Guide (page 26). 	<p>Can detect motion only in part of the visible image (shown here in gray)</p>  <p>The diagram shows a person walking from left to right across a horizontal band that is shaded gray. The rest of the visible area is white, indicating that motion is only detected within the shaded gray area.</p> <ul style="list-style-type: none"> You can adjust the area detectable by the infrared sensor. See "Adjusting the infrared sensor range", page 22. Detection does not occur when there are obstacles in front of the infrared sensor. Remove the obstacles or change the installation location.

Main characteristics

Visual sensor	Infrared sensor
<p>Easily detects movement in the daytime or when it is bright.</p> <ul style="list-style-type: none"> Movement may be incorrectly detected when the moving object and the background have a similar color. Movement may be incorrectly detected when there are sudden changes to the overall brightness levels such as when external lights are used. 	<p>Easily detects when there is a big difference between the temperatures of objects and the surrounding environment, such as in winter or late at night.</p> <ul style="list-style-type: none"> The sensor cannot easily detect when there is no difference between the temperatures of objects and the surrounding environment, such as in summer or during the daytime. If the camera is mounted facing a road, the sensor may detect incorrectly due to interference caused by the heat from passing cars.

Installation Location

Direction of motion

It is easier to detect objects that move sideways in front of the camera, and more difficult to detect objects that move directly toward the front of the camera.

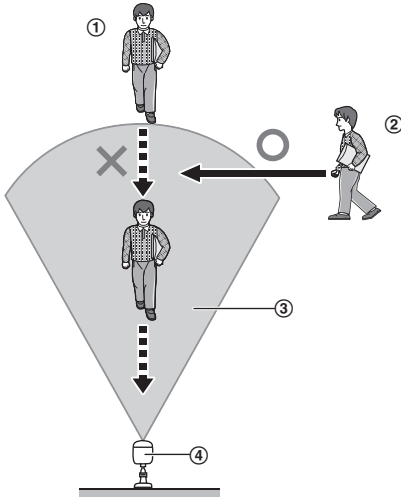

- ① It is difficult to detect movement directly towards the front of the camera.
- ② It is easy to detect movement sideways in front of the camera.
- ③ Detection range
- ④ Camera

Installation location examples

I want to detect visitors approaching the house

Refer to the table below for detecting visitors at an entrance or gate without detecting cars in the street.

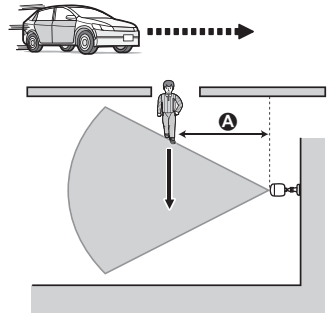
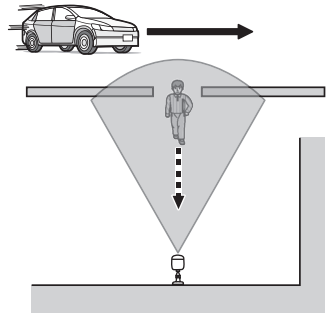
Ideal example	Poor example
 <p>The diagram shows a car in the street moving from left to right, indicated by a dashed arrow. A person is walking towards a house entrance. A camera is mounted on the wall of the house, pointing towards the person. A dashed line labeled 'A' indicates the distance from the camera to the person. A shaded cone represents the camera's field of view, which is directed at the person and does not cover the street.</p> <p>A Approx. 3 m (9.8 feet) Visitors pass in front of the camera from side to side, cars in the street are less likely to cause false detections.</p>	 <p>The diagram shows a car in the street moving from left to right, indicated by a solid arrow. A person is walking towards a house entrance. A camera is mounted on the ground in front of the house, pointing towards the person. A shaded cone represents the camera's field of view, which is wide and covers both the person and the street.</p> <p>Cars in the street are more likely to cause false detections.</p>

Installation Location

I want to detect people entering the garage

Refer to the table below for detecting people entering a garage without detecting cars in the street.

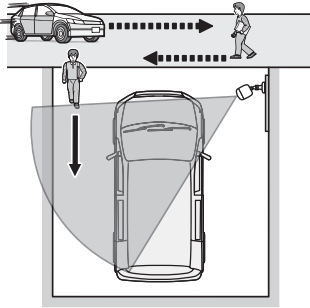
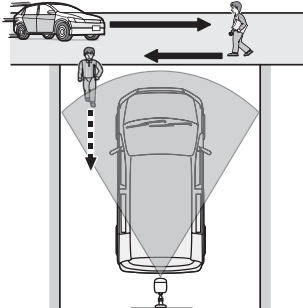
Ideal example	Poor example
 <p>The diagram shows a top-down view of a garage entrance. A car is parked on the street to the left. A person is walking from left to right across the street. A camera is mounted on the right side of the garage, pointing towards the entrance. Dotted arrows indicate the car's path and the person's path. A solid arrow points from the camera towards the person. The camera's field of view is shown as a shaded area that covers the person and the garage entrance, but not the car.</p>	 <p>The diagram shows a top-down view of a garage entrance. A car is parked on the street to the left. A person is walking from left to right across the street. A camera is mounted on the front of the garage, pointing towards the entrance. Dotted arrows indicate the car's path and the person's path. A solid arrow points from the camera towards the person. The camera's field of view is shown as a shaded area that covers the person and the garage entrance, but also includes the car.</p>
<p>Visitors pass in front of the camera from side to side, cars in the street are less likely to cause false detections.</p> <ul style="list-style-type: none">● To prevent faces from being obscured by tall vehicles, adjust the installation position and angle of the camera.	<p>Cars in the street are more likely to cause false detections.</p>

Installation Location

Do not install in these locations

Installing in the following areas may cause deformation, discoloration, malfunction, or operational failure

- In direct sunlight or directly under an outdoor light (even if the surroundings are within operational temperature range, parts of the product may become hot)
- Areas subject to frequent vibration, shock, or impact
- Near fire, heating devices, magnetic fields (such as near magnets), or air conditioners (including outdoor equipment such as unit compressors)
- Areas exposed to grease or steam
- Near devices that emit strong radio waves, such as mobile phones
- Areas subject to extreme temperature changes (which can lead to condensation)
- Near coasts directly subjected to sea breezes, or near sulfuric hot springs (exposure to salt can shorten the life of the product)
- Near TVs, radios, automated office equipment such as computers, air conditioners, water heater panels (with intercom), or home security equipment (these may cause noise)
- Near satellite broadcasting receivers such as tuners, TVs with built-in satellite tuners, and recorders (broadcasted images may be distorted)
- Areas where hydrogen sulfide, ammonia, dust, or toxic gases are present

Installing in the following areas may cause false detections

- Areas where people approach directly from the front of the camera, such as narrow walkways
 - Ⓐ Camera
 - Ⓑ Difficult to detect

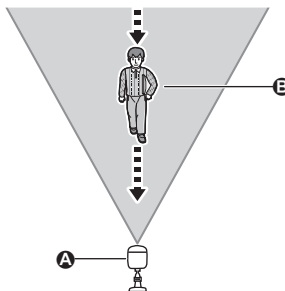

- Areas where objects such as trees or hanging laundry move due to wind (temperature variation and motion may cause false detections)

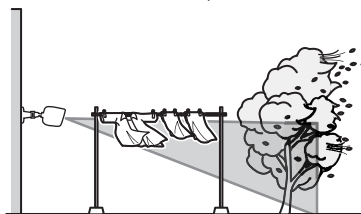

- On roads with high traffic (passing cars may cause sensor detections even if they are 5 m (16.4 feet) or more away)

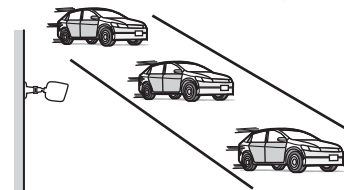

Installation Location

- Areas affected by breezes from fans, air conditioning unit compressors, water heaters, or car exhaust (severe temperature variations may cause false detections)

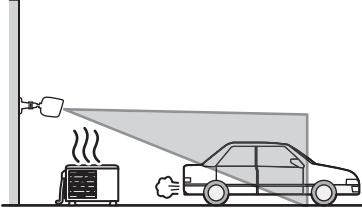

- Areas with strong winds (wind can shake the camera and cause false motion detection)
- Areas with reflective objects, such as glass, that can interfere with detection of temperature variation
- Areas where brightness changes easily (such as areas where shadows form in the afternoon and lights turn on at night)
- Areas where backlight occurs (faces appear dark and are difficult to identify), such as the following
 - Areas where most of the background is the sky
 - Areas where direct sunlight reflects off a white wall or background
 - Bright areas such as those exposed to direct sunlight

Part names and functions

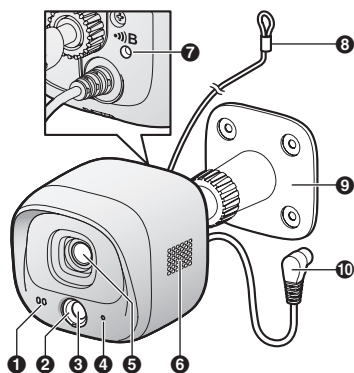

- 1** Microphone
- 2** Sensor range cap (Standard)
- 3** Infrared sensor
- 4** LED indicator
- 5** Lens unit
- 6** Speaker
- 7** **[()) B]**
Used when registering the camera to the hub.
- 8** Safety wire
- 9** Camera mounting stand
- 10** DC cable

LED indicator

You can use the LED indicator to confirm the camera's status.

Indicator	Status
Off	No power, or LED indicator is turned off*1
Green, lit	Normal operation*1
Green, blinking	Registration mode
Red	Motion detection features were triggered

Indicator	Status
Red, blinking	Live images are being viewed or recorded
Red, blinking quickly	Camera is out of range of the hub, or device malfunction
Amber, blinking	Camera is not registered to a hub

*1 You can configure the camera so that its LED indicator does not light during normal operation. For more information, refer to the User's Guide (page 26).

Setup overview

- 1 Initial setup**
Make sure you can access the system using your mobile device. For details, refer to the System Setup Guide included with your hub.
- 2 Registration**
Required only if the camera was purchased separately (i.e., not as part of a bundle).
- 3 Confirm the installation area**
Read the information in this document to confirm that the desired installation area is suitable to proper operation.
- 4 Installation**
Install the camera in the desired location and connect the camera to the power outlet.
- 5 Adjust the infrared sensor range**
Confirm the sensor range area and adjust it if necessary using the included sensor range adjustment caps.

Setup

Registering the camera

This procedure is not required for devices that were included as part of a bundle.

Before you can use the camera, it must be registered to the hub.

If the camera is not registered to a hub, the camera's LED indicator blinks in amber. You can register each device by using the registration buttons or the **[Home Network]** app.

Note:

- Before registering the camera, make sure the AC adaptors of the hub and camera are connected and each device is powered.

Using registration buttons

- 1 Hub:**
Press and hold **[CAMERA]** until the LED indicator blinks in green.
- 2 Camera:**
Using an object with a thin tip, press and hold **[CAMERA]** until the LED indicator blinks in green (page 15).
 - When registration is complete, the hub sounds one long beep.

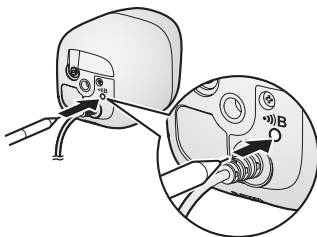

Note:

- To cancel the registration, press the registration button on the hub and on the camera.
- If registration fails, the hub sounds several short beeps.

Using the app

When you register the camera by using the **[Home Network]** app, you can assign a name to your devices and group them by location. For more information, refer to the User's Guide (page 26).

Confirming the registration area

Before deciding where to install the camera, carefully read the chapter "Installation Location", beginning on page 8, to confirm the installation location and direction.

Installation

Installation precautions

- Do not install the camera on a ceiling.
- Do not install the camera in areas directly exposed to water or rain.
- Holes must be made in the wall for cables and wires to pass through. Panasonic takes no responsibility for issues related to opening holes in walls.
- Make sure to waterproof the holes you make in the wall.
- Make sure you attach the safety wire to prevent the camera from falling.
- Do not use an impact driver. (This may lead to damaged screws or over-tightening.)
- Mount the camera on the stable location where the unit can be adequately supported when installing.
- The AC adaptor should be connected to a vertically oriented or floor-mounted AC outlet. Do not connect the AC adaptor to a ceiling-mounted AC outlet, as the weight of the adaptor may cause it to become disconnected.
- Do not mount the camera on a soft material. It may fall down, break or cause injury.

Wall material information

Siding

- Use the included screws $\varnothing 4 \text{ mm} \times 25 \text{ mm}$ ($\varnothing 5/32 \text{ inches} \times 1 \text{ inch}$). Make sure the pull-out capacity of each screw is at least 294 N (30 kgf).
- If the weight of the camera is supported by the siding only, the siding could become damaged. Make sure you mount the camera in a location where the structure behind the siding can be used to support the weight of the camera. If this is not possible due to the thickness of the siding, use commercially-available screws $\varnothing 4 \text{ mm} \times$ longer than 25 mm ($\varnothing 5/32 \text{ inches} \times$ longer than 1 inch).
- Drill a pilot hole using a drill bit that is appropriate for the type of siding. Remove any debris after drilling the pilot hole. Do not drill the pilot hole into the structure behind the siding.

Poor example

No support behind exterior surface

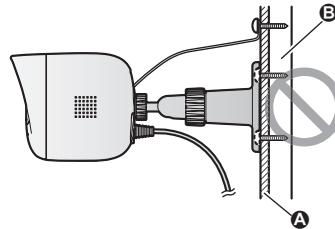

- A** Siding
- B** Open space, no support

Setup

Ideal example

Structure supports exterior surface

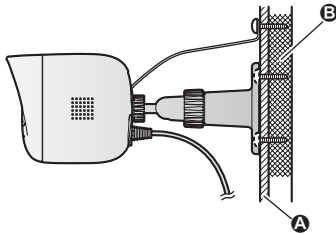

A Siding

B Structure behind siding

Concrete

- Do not use the included screws. Use screw anchors (screw \varnothing : 4 mm (5/32 inches)) designed for concrete walls.
- Carefully read the instructions supplied with the anchors. Follow instructions regarding drill bit diameter, hole depth, etc.
- Drill a pilot hole. Remove any debris after drilling the pilot hole.

- 1 Mark the hole depth on the drill bit (**A**) and then drill a pilot hole.

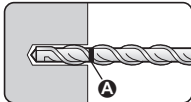

- 2 Remove debris.

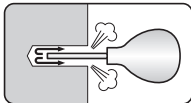

- 3 Insert an anchor, tighten the screw, then remove the screw to secure the anchor.

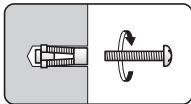

- 4 Insert the screw and tighten it.

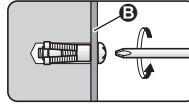

B Camera mounting stand

ALC (autoclaved lightweight cellular concrete)

- Depending on the type of ALC panel, you may not be able to attach the camera. Consult the ALC panel manufacturer.
- Do not use the included screws. After consulting the manufacturer of the ALC panel, use only commercially-available metal screw anchors (screw \varnothing : 4 mm (5/32 inches)) designed for ALC panels.
- Carefully read the instructions supplied with the anchors. Follow instructions regarding drill bit diameter, hole depth, etc.
- Drill a pilot hole. Remove any debris after drilling the pilot hole.
- Seal the pilot hole with a commercially-available waterproof sealant.

Other materials (mortar, tile, etc.)

- Do not use the included screws.
- Consult the builder or licensed professional regarding the type of anchor appropriate for the installation location and materials.
- Do not install on gypsum board or concrete blocks.

Installing the camera

- 1 Attach the safety wire to the camera.
 - Place the ring of the safety wire (①) over the screw hole.
 - Place a washer (②) on top of the ring of the safety wire.
 - Tighten the screw (③) for the safety wire on top of the washer.

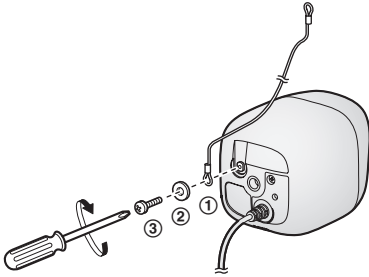

- 2 Attach the camera mounting stand to an outdoor wall.
 - Secure the stand to the wall by tightening 4 screws (①).
 - **A** 37 mm (1 15/32 inches)

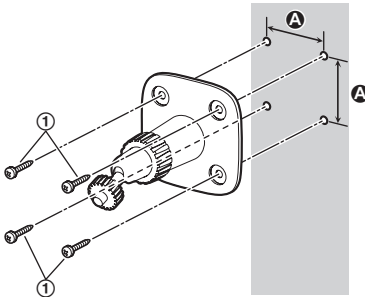

Note:

- Use the following template below when determining the location of the screw holes.

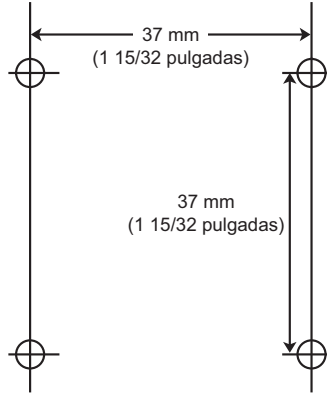

Setup

- 3** Attach the camera to the stand.
- Loosen the screw (A).
 - Insert the tip of the stand (1) into the stand attachment hole (2) on the rear or bottom side.
 - Secure the camera by tightening the screw (B).

Attaching to the hole on the rear side

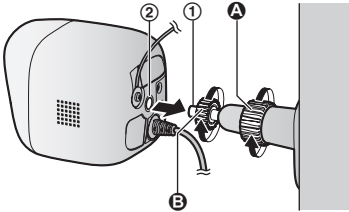

Attaching to the hole on the bottom side

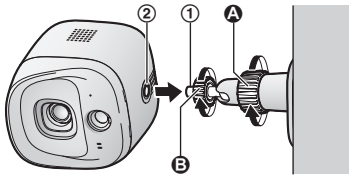

- 4** Adjust the camera angle.
- Loosen the screw (1), adjust the camera to the desired angle, and then tighten the screw (2) to secure the camera in place.

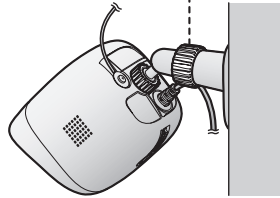
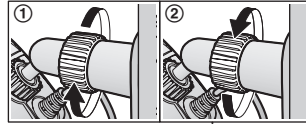

Setup

- 5** Attach the safety wire to the wall.
- Place the ring of the safety wire (①) on the wall.
 - Place the washer (②) on top of the ring of the safety wire.
 - Tighten the screw (③) for the safety wire on top of the washer.

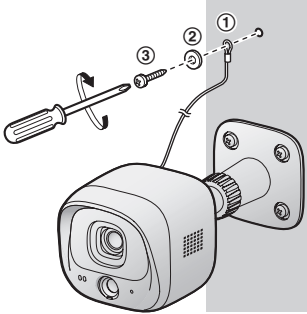

Note:

- Attach the safety wire while it is bent.
- Attach the safety wire high on the wall so that the camera does not strike anyone in the event the camera detaches from the wall.
- Do not hang from the camera or stand.

- 6** Connect the DC cable to the AC adaptor.
- Pull the DC cable indoors, and connect the DC cable plug (①) to the AC adaptor plug (②).
 - Connect the AC adaptor (③) to the power outlet.
- A** Outdoors
B Indoors

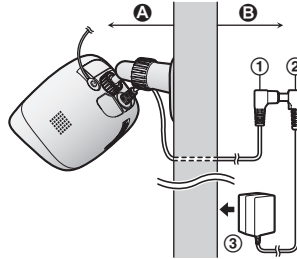

Note:

- Use only the supplied Panasonic AC adaptor PNLV236.
- Be sure to connect the DC cable plug and AC adaptor plug indoors.

Note about power connections

AC adaptor connection

- The AC adaptor must remain connected at all times. (It is normal for the adaptor to feel warm during use.)
- The AC adaptor should be connected to a vertically oriented or floor-mounted AC outlet. Do not connect the AC adaptor to a ceiling-mounted AC outlet, as the weight of the adaptor may cause it to become disconnected.

Power failure

- The camera will not work during a power failure.

Appendix

Testing the motion detection range

After you have installed the **[Home Network]** app on your mobile device, you can use your mobile device to test the performance of the camera's motion detection features. For details about these operations, refer to the User's Guide (page 26).

- 1 Start the **[Home Network]** app and display live images from the camera.
- 2 Move to an area within the camera's viewable area.
- 3 While moving near the camera, use your mobile device to observe where you are in the viewable area when the camera's motion detection features are triggered.
 - When the motion detection features are triggered, the camera's LED indicator lights in red for about 3 seconds.
- 4 Note the areas of the viewable area where movement is detected, and make adjustments as necessary.

Note:

- You can adjust the area detectable by the visual sensor. For more information, refer to the User's Guide (page 26).
- You can adjust the area detectable by the infrared sensor. See "Adjusting the infrared sensor range", page 22.

Testing the microphone

To test the microphone, speak loudly and clearly into the microphone while a mobile device user is viewing live images from the camera.

Adjusting the infrared sensor range







If there are objects that you do not want the infrared sensor to detect, you can adjust the detectable area by attaching sensor range caps.

Sensor range cap types and detectable area

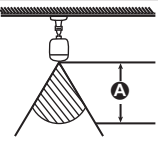
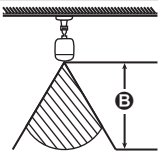
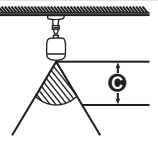
In addition to the standard cap (already attached to the camera), there are 4 cap types (cap 1-4). Each cap blocks different areas of the sensor range and can be attached at 45-degree increments. Refer to the following and attach the proper cap at the proper angle.

- The detectable areas shown here are an approximation for when the **[IR Sensor]** setting is set to **[Normal]**. For more information, refer to the User's Guide (page 26).
- The detectable area rotates according to the sensor range cap angle.

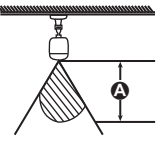
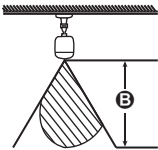
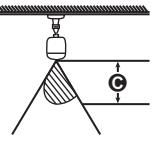
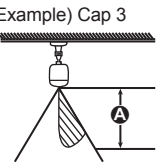
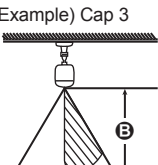
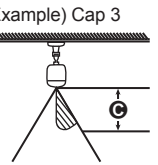
Appendix

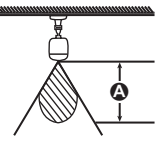
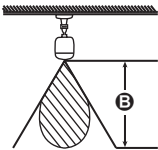
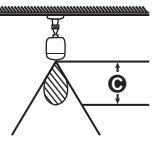
Situation and cap types	Approximate detection range (view when looking from above) *1		
	20 °C (68 °F)	0 °C (32 °F)	30 °C (86 °F)
<p>When you want both sides of the camera to be detectable Standard cap (attached to the camera)</p> 	 <p>A 5 m (16.4 feet)</p>	 <p>B 6 m (19.7 feet)</p>	 <p>C 4 m (13.1 feet)</p>
<p>When you want one side to be undetectable Cap 1</p>  <p>Cap 2</p>  <p>Cap 3</p> 	<p>(Example) Cap 1</p>  <p>A 5 m (16.4 feet)</p>	<p>(Example) Cap 1</p>  <p>B 6 m (19.7 feet)</p>	<p>(Example) Cap 1</p>  <p>C 4 m (13.1 feet)</p>
	<p>(Example) Cap 3</p>  <p>A 5 m (16.4 feet)</p>	<p>(Example) Cap 3</p>  <p>B 6 m (19.7 feet)</p>	<p>(Example) Cap 3</p>  <p>C 4 m (13.1 feet)</p>
<p>When you want both sides to be undetectable Cap 4</p> 	<p>(Example) Cap 4</p>  <p>A 5 m (16.4 feet)</p>	<p>(Example) Cap 4</p>  <p>B 6 m (19.7 feet)</p>	<p>(Example) Cap 4</p>  <p>C 4 m (13.1 feet)</p>

*1 Varies by ambient temperature at the camera installation location. Numeric values are approximate. Detectable area is indicated by .

Appendix

About the attachment angle of the sensor range cap

Example 1

When there is an object on the right side of the viewable area that you do not want to be detected (such as trees):

Attach one of caps 1-3 as shown in the example (A) according to the area you do not want to be detected.

Example 2

When there is an object on the top left of the viewable area that you do not want to be detected (cars in a street, etc.):

Attach one of caps 1-3 as shown in the example (B) according to the area you do not want to be detected.

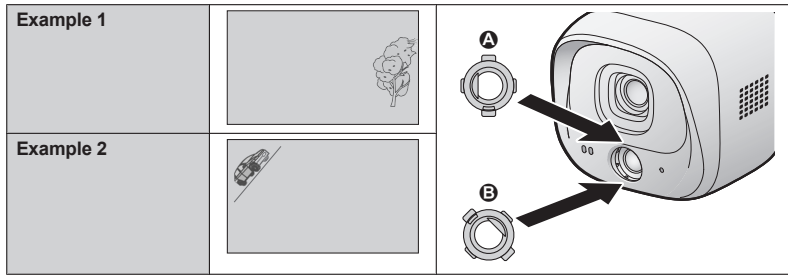

Replacing sensor range caps

- 1 Remove the attached standard cap.

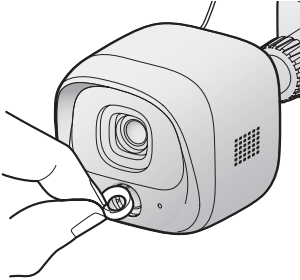

- 2 Remove the desired sensor range cap from one of the 4 types (①) and attach it to the sensor (②).
 - When attaching, rotate the tab (A) on the cap toward the top or at a 45-degree angle according to the type of cap or direction, and attach the cap on the camera, shown in the following illustration.

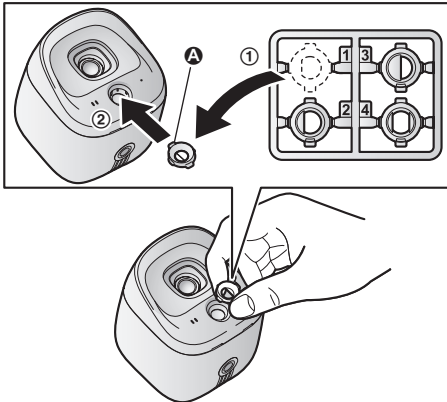

Appendix

Features available when using the [Home Network] app

Some of the camera's features that are available when using the [Home Network] app are listed below. For more information, refer to the User's Guide (page 26).

- **Security system**
You can use the app to arm and disarm the security system, confirm the current status of the sensor, and view a log of previous security events.
- **Live camera monitoring**
You can view live images from the camera, even while away from home.
- **Listen and talk**
You can use your mobile device to talk and listen to anyone within range of the camera's microphone and speaker.
- **Sensor integration**
You can configure the camera's sensor features to trigger other system events, such as camera recording*1, turning on an electric device (such as a lamp), etc. (Appropriate device required.)
*1 A commercially-available microSD card must be inserted into the hub in order to record images.
- **Notification**
You can configure the camera to send a notification to the [Home Network] app when the camera detect motion.

Accessing the User's Guide

The User's Guide is a collection of online documentation that helps you get the most out of the [Home Network] app.

- 1 **iPhone®/iPad®**
Tap  in the app's home screen.
- Android™ devices**
Tap  or press your mobile device's menu button in the app's home screen.
- 2 Tap [User's Guide].

Note:

- You can also access the User's Guide at the web page listed below.



www.panasonic.net/pcc/support/tel/homenetwork/manual/

Specifications

- **Standards**
DECT 6.0 (Digital Enhanced Cordless Telecommunications 6.0)
- **Frequency range**
DECT: 1.92 GHz – 1.93 GHz
- **RF transmission power**
DECT: 115 mW (max.)
- **Power source**
120 V AC, 60 Hz
- **Power consumption**
Standby: 1.4 W
During operation:
1.5 W (when the LED lights are not lit)
2.3 W (when the LED lights are lit)
- **Operating conditions**
-20 °C – 50 °C (-4 °F – 122°F)
up to 90% relative humidity (non-condensing)
- **Transmitting range**
Approx. 50 m (160 feet) indoors
Approx. 300 m (1,000 feet) outdoors
- **Image sensor**
0.3 megapixel CMOS
- **Minimum illuminance required**
0 lx*1
- **Focal length**
Fixed (0.4 m (1.3 feet) – infinity)
- **Angular field of view (camera angle)**
Horizontal: approx. 70°
Vertical: approx. 50°
- **Motion detection method**
Pyroelectric infrared sensor (PIR sensor) and visual sensor
- **PIR sensor detection range (when the surrounding temperature is approx. 25 °C (77 °F))**
Horizontal: approx. 70°
Vertical: approx. 20°
Detection range: approx. 5 m
- **Visual sensor detection range**
Horizontal: approx. 70°
Vertical: approx. 50°
- **IP rating**
IP55*2
- **Adjustable mounting angles**
Horizontal: ±90°
Vertical: facing forward - facing down approx. 60°
(adjustable when mounting)

- **Dimensions**

Approx. 75 mm × 75 mm × 173 mm (2 15/16 inches × 2 15/16 inches × 6 13/16 inches)

- **Mass (weight)**

Approx. 305 g (0.67 lb)

*1 The IR-LED will be lighted at the low illuminance conditions.

*2 Water resistance is only assured if the camera is installed correctly according to the instructions in the Installation Guide, and appropriate water protection measures are taken. Do not install the camera in areas directly exposed to water or rain.

Appendix

FCC and other information

This device complies with Part 15 of the FCC Rules. Operation is subject to the following two conditions:

(1) This device may not cause harmful interference, and (2) this device must accept any interference received, including interference that may cause undesired operation.

Privacy of communications may not be ensured when using this phone.

CAUTION:

Any changes or modifications not expressly approved by the party responsible for compliance could void the user's authority to operate this device.

NOTE:

This equipment has been tested and found to comply with the limits for a Class B digital device, pursuant to Part 15 of the FCC Rules. These limits are designed to provide reasonable protection against harmful interference in a residential installation. This equipment generates, uses, and can radiate radio frequency energy and, if not installed and used in accordance with the instructions, may cause harmful interference to radio communications. However, there is no guarantee that interference will not occur in a particular installation. If this equipment does cause harmful interference to radio or television reception, which can be determined by turning the equipment off and on, the user is encouraged to try to correct the interference by one or more of the following measures:

- Reorient or relocate the receiving antenna.
- Increase the separation between the equipment and receiver.
- Connect the equipment into an outlet on a circuit different from that to which the receiver is connected.
- Consult the dealer or an experienced radio/TV technician for help.

Some cordless telephones operate at frequencies that may cause interference to nearby TVs and VCRs. To minimize or prevent such interference, the base of the

cordless telephone should not be placed near or on top of a TV or VCR. If interference is experienced, move the cordless telephone further away from the TV or VCR. This will often reduce or eliminate interference.

FCC RF Exposure Warning:

- This product complies with FCC radiation exposure limits set forth for an uncontrolled environment.
- To comply with FCC RF exposure requirements, the device must be installed and operated 20 cm (8 inches) or more between the product and all person's body.
- This product may not be collocated or operated in conjunction with any other antenna or transmitter.
- For body-worn operation, the handset must be used only with a non-metallic accessory. Use of other accessories may not ensure compliance with FCC RF exposure requirements.

Notice:

- FCC ID can be found on the rear of the unit.

Customer services

Customer Services Directory (United States and Puerto Rico)

Obtain Product Information and Operating Assistance; locate your nearest Dealer or Service Center; purchase Parts and Accessories; or make Customer Service and Literature requests by visiting our Web Site at:

www.panasonic.com/support

or, contact us via the web at:

www.panasonic.com/contactinfo

You may also contact us directly at: 1-800-211-PANA (1-800-211-7262),
Monday - Friday 9 am to 9 pm; Saturday - Sunday 10 am to 7 pm, EST.

For hearing or speech impaired TTY users, TTY: 1-877-833-8855

Accessory Purchases (United States and Puerto Rico)

Purchase Parts, Accessories and Owner's Manual online for all Panasonic Products by visiting our Web Site at:

www.pstc.panasonic.com

or, send your request by E-mail to:

npcparts@us.panasonic.com

You may also contact us directly at:

1-800-237-9080 (Fax Only)

(Monday - Friday 9 am to 9 pm, EST.)

Panasonic National Parts Center

20421 84th Avenue S., Kent, WA 98032

(We accept Visa, MasterCard, Discover Card, American Express.)

For hearing or speech impaired TTY users, TTY: 1-866-605-1277

Appendix

Warranty (For United States and Puerto Rico)

Panasonic Home Network System Products Limited Warranty

Limited Warranty Coverage

If your product does not work properly because of a defect in materials or workmanship, Panasonic Corporation of North America (referred to as "the warrantor") will, for the length of the period indicated on the chart below, which starts with the date of original purchase ("Limited Warranty period"), at its option either (a) repair your product with new or refurbished parts, or (b) replace it with a new or a refurbished equivalent value product, or (c) refund your purchase price. The decision to repair, replace or refund will be made by the warrantor.

	Parts	Labor
Home Network System Products	One (1) Year	One (1) Year
microSD card (Included model only)	90 days	N/A

During the "Labor" Limited Warranty period there will be no charge for labor. During the "Parts" Limited Warranty period, there will be no charge for parts. You must mail-in your product prepaid during the Limited Warranty period. This Limited Warranty excludes both parts and labor for batteries, antennas, and cosmetic parts (cabinet). This Limited Warranty only applies to products purchased and serviced in the United States or Puerto Rico. This Limited Warranty is extended only to the original purchaser and only covers products purchased as new.

Mail-In Service--Online

Online Repair Request

To submit a new repair request and for quick repair status visit our Web Site at www.panasonic.com/repair

When shipping the unit carefully pack in a padded shipping carton, include all accessories, and send it prepaid. Include a letter detailing the complaint, a return address and provide a day time phone number where you can be reached. P.O. Boxes are not acceptable. Keep the tracking number for your records. A copy of valid registered receipt is required under the 1 year parts and labor Limited Warranty.

For Limited Warranty service for headsets if a headset is included with this product please follow instructions above.

IF REPAIR IS NEEDED DURING THE LIMITED WARRANTY PERIOD THE PURCHASER WILL BE REQUIRED TO FURNISH A SALES RECEIPT/PROOF OF PURCHASE INDICATING DATE OF PURCHASE, AMOUNT PAID AND PLACE OF PURCHASE. CUSTOMER WILL BE CHARGED FOR THE REPAIR OF ANY UNIT RECEIVED WITHOUT SUCH PROOF OF PURCHASE.

Limited Warranty Limits And Exclusions

This Limited Warranty ONLY COVERS failures due to defects in materials or workmanship, and DOES NOT COVER normal wear and tear or cosmetic damage. The Limited Warranty ALSO DOES NOT COVER damages which occurred in shipment, or failures which are caused by products not supplied by the warrantor, or failures which result from accidents, misuse, abuse, neglect, bug infestation, mishandling, misapplication, alteration, faulty installation, set-up adjustments, misadjustment of consumer controls, improper maintenance, power line surge, lightning damage, modification, introduction of sand, humidity or liquids, commercial use such as hotel, office, restaurant, or other business or rental use of the product, or service by anyone other than a Factory Service Center or other Authorized Servicer, or damage that is attributable to acts of God.

THERE ARE NO EXPRESS WARRANTIES EXCEPT AS LISTED UNDER “LIMITED WARRANTY COVERAGE”. THE WARRANTOR IS NOT LIABLE FOR INCIDENTAL OR CONSEQUENTIAL DAMAGES RESULTING FROM THE USE OF THIS PRODUCT, OR ARISING OUT OF ANY BREACH OF THIS LIMITED WARRANTY. (As examples, this excludes damages for lost time, lost calls or messages, cost of having someone remove or re-install an installed unit if applicable, travel to and from the servicer. The items listed are not exclusive, but are for illustration only.) **ALL EXPRESS AND IMPLIED WARRANTIES, INCLUDING THE WARRANTY OF MERCHANTABILITY, ARE LIMITED TO THE PERIOD OF THE LIMITED WARRANTY.**

Some states do not allow the exclusion or limitation of incidental or consequential damages, or limitations on how long an implied warranty lasts, so the exclusions may not apply to you.

This Limited Warranty gives you specific legal rights and you may also have other rights which vary from state to state. If a problem with this product develops during or after the Limited Warranty period, you may contact your dealer or Service Center. If the problem is not handled to your satisfaction, then write to the warrantor’s Consumer Affairs Department at the addresses listed for the warrantor.

PARTS AND SERVICE, WHICH ARE NOT COVERED BY THIS LIMITED WARRANTY, ARE YOUR RESPONSIBILITY.

When you ship the product

- Carefully pack your unit, preferably in the original carton.
- Attach a letter, detailing the symptom.
- Send the unit to Panasonic Exchange Center, prepaid and adequately insured.
- Do not send your unit to Panasonic Corporation of North America listed on the back cover or to executive or regional sales offices. These locations do not repair consumer products.

IMPORTANT!

If your product is not working properly. . .

- ① **Reconnect the AC adaptor to the camera.**
- ② Use the **Home Network app** to access the **User's Guide** and refer to the **Troubleshooting** section.



Visit our Web site: www.panasonic.com/support
• FAQ and troubleshooting hints are available.

For your future reference

We recommend keeping a record of the following information to assist with any repair under warranty.

Serial No.	Date of purchase
(found on the rear of the unit) Name and address of dealer	

Attach your purchase receipt here.

Panasonic Corporation of North America

Two Riverfront Plaza, Newark, NJ 07102-5490

© Panasonic System Networks Co., Ltd. 2014

Panasonic®

Guía de instalación

Sistema de red doméstico
Cámara exterior
Modelo n° **KX-HNC600**



Gracias por adquirir un producto Panasonic.

Este documento explica cómo instalar la cámara exterior de forma correcta.
Para obtener detalles sobre cómo usar el sistema, consulte la Guía del usuario (página 21).

Lea este documento antes de usar la unidad, y guárdelo para consultarlo en el futuro.

Para obtener ayuda, visite nuestro sitio web: www.panasonic.com/support
para clientes en los EE. UU. o Puerto Rico (solo en inglés).

Por favor, registre su producto: www.panasonic.com/prodreg



PNQX6697ZA

PNQX6697ZA CC0814WK0 (E)



Tabla de Contenido

Ubicación de la instalación

Alcance de la comunicación inalámbrica	3
Información acerca de las características del sensor	3
Ejemplos de ubicaciones para instalación	6
No instale en las ubicaciones siguientes	8

Configuración

Nombres de los componentes y funciones	10
Led indicador	10
Resumen de configuración	10
Cómo registrar la cámara	11
Confirmación del área de registro	11
Instalación	12

Apéndice

Cómo probar el alcance de detección de movimiento	17
Ajuste del alcance del sensor infrarrojo	17
Acceso a la Guía del usuario	21

Ubicación de la instalación

Alcance de la comunicación inalámbrica

El alcance de la comunicación inalámbrica de cada dispositivo en el sistema del hub es de aproximadamente 50 m (160 pies) en interiores y de aproximadamente 300 m (1,000 pies) en el exterior. Es posible que la comunicación inalámbrica no sea tan confiable cuando se encuentran los obstáculos siguientes entre el hub y otros dispositivos.

- Puertas o pantallas metálicas
- Paredes que contengan aislamiento de aluminio
- Paredes de hormigón o hierro corrugado
- Ventanas de vidrio doble
- Varias paredes
- Cuando los dispositivos están en pisos o edificios diferentes

Nota:

- Si el Led indicador de la cámara parpadea en rojo de forma rápida, se encuentra fuera de alcance del hub. En este caso, confirme todas las conexiones, incluso las del hub.

Información acerca de las características del sensor

La cámara tiene 2 características de sensor que se usan para la detección de movimiento: un sensor visual y un sensor infrarrojo (es decir, sensor de calor).

Lea la información siguiente antes de decidir dónde instalar la cámara.

Nota:

- Las funciones del sensor de la cámara no están preparadas para que se las use en situaciones que requieran alta confiabilidad. No recomendamos el uso de las características del sensor en esas situaciones.
- Panasonic no asume ninguna responsabilidad por lesiones o daños provocados por el uso de las características del sensor de la cámara.

Método de detección

Sensor visual	Sensor infrarrojo
La cámara detecta cambios en las imágenes que aparecen. <ul style="list-style-type: none">● La cámara detecta los cambios en los niveles de brillo de los objetos en movimiento.	La cámara detecta las diferencias de temperatura de los objetos en las imágenes que aparecen. <ul style="list-style-type: none">● El sensor infrarrojo usa rayos infrarrojos para detectar las diferencias de temperatura dentro su alcance que emiten de forma natural las personas, animales, etc.

Ubicación de la instalación

Alcance de detección

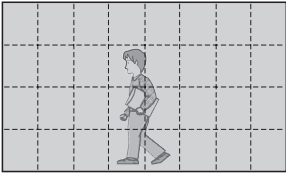
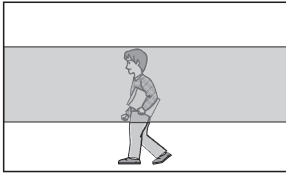
Sensor visual	Sensor infrarrojo
<p>Puede detectar el movimiento en cualquier parte de la imagen visible.</p>  <ul style="list-style-type: none">● Puede ajustar el área detectable mediante el sensor visual. Para obtener más información, consulte la Guía del usuario (página 21).	<p>Puede detectar el movimiento solo en la parte de la imagen visible (se muestra aquí en gris)</p>  <ul style="list-style-type: none">● Puede ajustar el área detectable mediante el sensor infrarrojo. Consulte "Ajuste del alcance del sensor infrarrojo", página 17.● La detección no es posible cuando hay obstáculos frente al sensor infrarrojo. Quite los obstáculos o cambie la ubicación de instalación.

Características principales

Sensor visual	Sensor infrarrojo
<p>Detecta el movimiento de manera fácil durante el día o cuando está alumbrado.</p> <ul style="list-style-type: none">● Es posible que no se detecte correctamente el movimiento cuando el objeto en movimiento y el fondo tengan un color similar.● Es posible que no se detecte correctamente el movimiento cuando haya cambios bruscos en los niveles generales de brillo, como cuando se encienden las luces exteriores.	<p>La detección se facilita cuando hay una gran diferencia entre las temperaturas de los objetos y el entorno, como en invierno o de noche.</p> <ul style="list-style-type: none">● El sensor no puede detectar fácilmente cuando no hay diferencias entre las temperaturas de los objetos y el entorno, como en verano o durante el día.● Si la cámara está montada cara a una carretera, es posible que el sensor no detecte de forma correcta debido a la interferencia generada por el calor de los vehículos que pasan.

Ubicación de la instalación

Dirección del movimiento

Es más fácil detectar objetos que se mueven de lado frente a la cámara y es más difícil detectar objetos que se mueven de frente hacia la cámara.

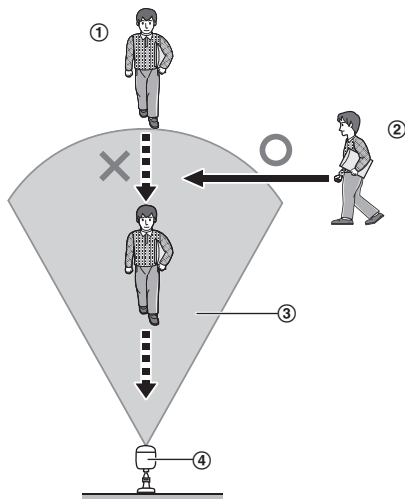

- ① Es difícil detectar movimiento directamente hacia la parte delantera de la cámara.
- ② Es fácil detectar movimiento lateral frente de la cámara.
- ③ Alcance de detección
- ④ Cámara

Ubicación de la instalación

Ejemplos de ubicaciones para instalación

Quiero detectar a los visitantes que se acerquen a la casa

Consulte la tabla siguiente para detectar a los visitantes en la entrada o puerta sin detectar los vehículos de la calle.

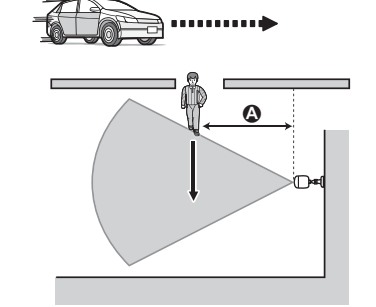
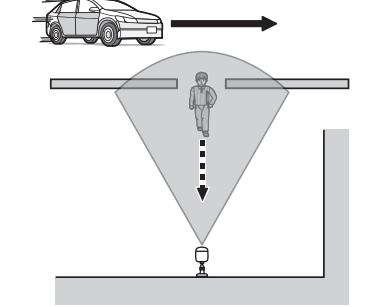
Ejemplo ideal	Mal ejemplo
 <p>A Aprox. 3 m (9.8 pies) Los visitantes pasan en frente de la cámara de lado a lado, y es poco probable que los vehículos en la calle generen detecciones falsas.</p>	 <p>Es más probable que los vehículos en la calle generen detecciones falsas.</p>

Ubicación de la instalación

Quiero detectar a las personas que ingresen al garaje

Consulte la tabla siguiente para detectar a las personas que ingresen al garaje sin detectar los vehículos de la calle.

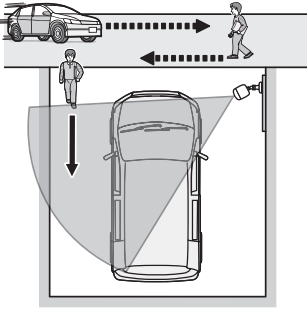
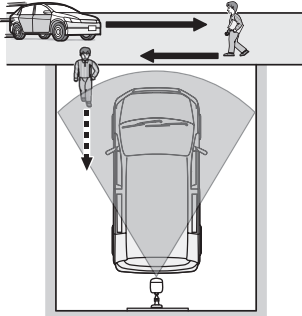
Ejemplo ideal	Mal ejemplo
 <p>Los visitantes pasan en frente de la cámara de lado a lado, y es poco probable que los vehículos en la calle generen detecciones falsas.</p> <ul style="list-style-type: none">● Para evitar que los vehículos altos oscurezcan los rostros, ajuste la posición de instalación y el ángulo de la cámara.	 <p>Es más probable que los vehículos en la calle generen detecciones falsas.</p>

Ubicación de la instalación

No instale en las ubicaciones siguientes

Si se instala en las áreas siguientes puede provocar deformación, falta de color, errores o fallas de operación

- A la luz del sol o bajo una luz exterior (incluso si el entorno está dentro del rango de temperatura funcional, es posible que algunas partes del producto se calienten)
- Áreas sujetas a vibraciones, golpes o impactos frecuentemente
- Cerca del fuego, calefactores, campos magnéticos (como cerca de imanes) o aires acondicionados (incluyendo equipos para exteriores como unidades compresoras)
- Áreas expuestas a grasa o vapor
- Cerca de dispositivos que emiten ondas de radio potentes, como teléfonos móviles
- Áreas sujetas a cambios extremos de temperatura (lo que puede generar condensación)
- Cerca de costas, donde hay brisa marítima, o cerca de termas de azufre (la exposición a la sal puede reducir la vida útil del producto)
- Cerca de televisores, radios, equipos de oficina automáticos, como ordenadores, aires acondicionados, paneles para calentar agua (con intercomunicador) o equipos de seguridad para el hogar (pueden generar ruido)
- Cerca de receptores de transmisión satelital como sintonizadores, televisores con sintonizadores satelitales incluidos, y grabadoras (es posible que las imágenes transmitidas se distorsionen)
- Áreas donde haya ácido sulfhídrico, amoníaco, polvo o gases tóxicos

Si se instala en las áreas siguientes es posible que existan detecciones falsas

- Áreas donde las personas se acercan de forma directa y frontal a la cámara, como en pasillos angostos
 - Ⓐ Cámara
 - Ⓑ Dificultad para detectar

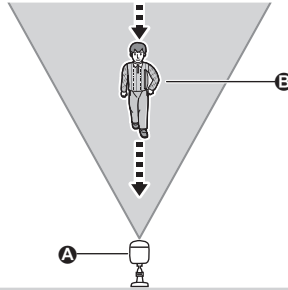

- Áreas donde objetos como árboles o ropa colgada se mueven por efecto del viento (es posible que la variación de temperatura y el movimiento causen detecciones falsas)

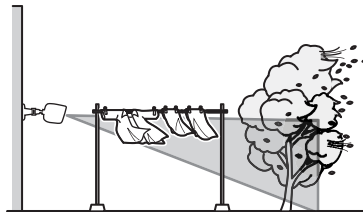

- En carreteras con mucho tránsito (es posible que los vehículos generen detecciones del sensor incluso si están a 5 m (16.4 pies) o más de distancia)

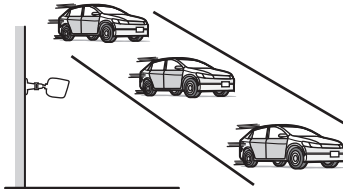

Ubicación de la instalación

- Áreas afectadas por brisas de ventiladores, unidades compresoras de aires acondicionados, calentadores de agua o caños de escape de vehículos (es posible que las variaciones fuertes de temperatura generen detecciones falsas)

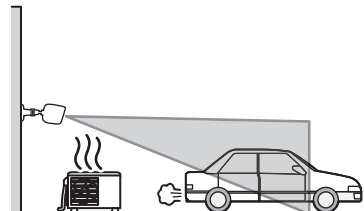

- Áreas con vientos fuertes (el viento puede sacudir la cámara y generar detecciones de movimiento falsas)
- Áreas con objetos reflectivos, como vidrios, que pueden interferir con la detección de la variación de temperatura
- Áreas donde el brillo cambia con facilidad (como áreas donde se formen sombras en la tarde y se enciendan luces de noche)
- Áreas donde haya luces de fondo (los rostros se oscurecen y son difíciles de identificar), como las siguientes
 - Áreas donde la mayor parte del fondo es el cielo
 - Áreas donde la luz del sol se refleje en una pared blanca o fondo
 - Áreas brillantes como aquellas expuestas a la luz del sol

Configuración

Nombres de los componentes y funciones

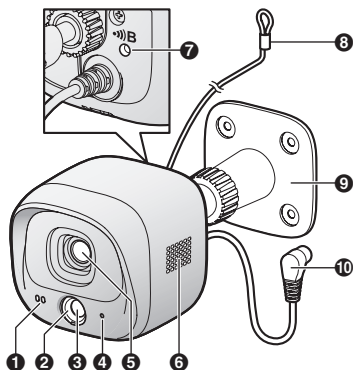

- 1 Micrófono
- 2 Tapa de alcance del sensor (Estándar)
- 3 Sensor infrarrojo
- 4 Led indicador
- 5 Unidad de lente
- 6 Altavoz
- 7 **[••]B**
Se usa para registrar la cámara en el hub.
- 8 Cable de seguridad
- 9 Soporte de montaje de la cámara
- 10 Cable de corriente continua

Led indicador

Puede usar el Led indicador para confirmar el estado de la cámara.

Indicador	Estado
Apagado	Sin energía, o el Led indicador está apagado*1
Verde, encendido	Funcionamiento normal*1
Verde, parpadeante	Modo de registro
Rojo	Las características de detección de movimiento se activaron

Indicador	Estado
Rojo, parpadeante	Las imágenes se están visualizando o grabando
Rojo, parpadeo rápido	La cámara está fuera de alcance del hub o falla el dispositivo
Ámbar, parpadeante	La cámara no está registrada en el hub

*1 Puede configurar la cámara de forma tal que el Led indicador no se encienda durante el funcionamiento normal. Para obtener más información, consulte la Guía del usuario (página 21).

Resumen de configuración

- 1 **Configuración inicial**
Asegúrese de poder acceder al sistema mediante su dispositivo móvil. Para obtener más detalles, consulte la Guía de configuración del sistema que viene con su hub.
- 2 **Registro**
Solo se requiere si se compró la cámara por separado (es decir, no como parte de un paquete).
- 3 **Confirme el área de instalación**
Lea la información de este documento para confirmar que el área de instalación deseada sea la adecuada para el correcto funcionamiento.
- 4 **Instalación**
Instale la cámara en el sitio deseado y conecte la cámara a la toma de corriente.
- 5 **Ajuste del alcance del sensor infrarrojo**
Confirme el área de alcance del sensor y ajuste, si es necesario, con las tapas de ajuste de alcance del sensor incluidas.

Cómo registrar la cámara

Este procedimiento no es necesario para unidades que son parte de un paquete.

Antes de que pueda usar la cámara, se debe registrar en el hub.

Si la cámara no se ha registrado a un hub, el indicador Led de la cámara parpadea en ámbar. Puede registrar cada unidad mediante los botones de registro o la aplicación **[Red doméstico]**.

Nota:

- Antes de registrar la cámara, asegúrese que todos los adaptadores de corriente del hub y la cámara estén conectados y cada dispositivo reciba alimentación.

Uso de los botones de registro

- 1 Hub:**
Oprima y mantenga oprimido **[••]B CAMERA** hasta que el Led indicador parpadee en verde.
- 2 Cámara:**
Con un objeto de punta fina, oprima y mantenga oprimido **[••]B** hasta que el Led indicador parpadee en verde (página 10).
 - Cuando se ha completado el registro, el hub emitirá un pitido largo.

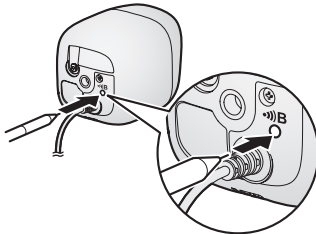

Nota:

- Para cancelar el registro, presione el botón de registro en el hub y en la cámara.
- Si el registro falla, el hub emitirá varios pitidos cortos.

Uso de la aplicación

Cuando registre su cámara con la aplicación **[Red doméstico]**, puede asignar un nombre a sus dispositivos y agruparlos por ubicación. Para obtener más información, consulte la Guía del usuario (página 21).

Confirmación del área de registro

Antes de decidir dónde instalará la cámara, lea con cuidado la "Ubicación de la instalación" en la página 3 para confirmar la dirección y la ubicación de la instalación.

Configuración

Instalación

Precauciones de instalación

- No instale la cámara en un techo.
- No instale la cámara en áreas expuestas de forma directa al agua o a la lluvia.
- Se deben hacer orificios en la pared para que pasen los cables. Panasonic no asume ninguna responsabilidad ante problemas relacionados por abrir orificios en paredes.
- Asegúrese de proteger los orificios que haga en la pared contra el agua.
- Asegúrese de ajustar el cable de seguridad para evitar que la cámara se caiga.
- No use un destornillador neumático (esto puede dañar los tornillos o ajustarlos de más).
- Monte la cámara en una ubicación estable donde la unidad se pueda colocar con seguridad.
- El adaptador de corriente debe estar conectado a un enchufe de corriente orientado verticalmente o en una toma de corriente alterna colocada en el piso. No conecte el adaptador de corriente alterna a una toma de corriente montada en el techo, ya que el peso del adaptador puede hacer que se desconecte.
- No coloque la cámara sobre un material blando. Podría caerse, romperse o provocar lesiones.

Información sobre el material de instalación

Revestimiento

- Use los tornillos incluidos de $\varnothing 4 \text{ mm} \times 25 \text{ mm}$ ($\varnothing 5/32$ pulgadas \times 1 pulgada). Asegúrese de que la fuerza nominal de cada tornillo sea como mínimo de 294 N (30 kgf).
- El revestimiento podría dañarse, si el peso de la cámara se sostiene solo con el revestimiento. Asegúrese de montar la cámara en un sitio donde la estructura detrás del revestimiento pueda usarse para sostener el peso de la cámara. Si no es posible debido al grosor del revestimiento, use tornillos disponibles de forma comercial de $\varnothing 4 \text{ mm} \times$ más largos de 25 mm ($\varnothing 5/32$ pulgadas \times más largos de 1 pulgada).
- Taladre un orificio con una broca que sea apropiada para el tipo de revestimiento. Retire todos los restos después de taladrar el orificio guía. No taladre el orificio guía en la estructura detrás del revestimiento.

Mal ejemplo

No hay soporte detrás de la superficie exterior

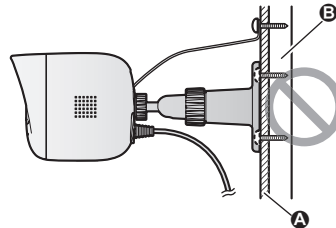

- Ⓐ Revestimiento
- Ⓑ Espacio abierto, no hay soporte

Configuración

Ejemplo ideal

La estructura sustenta la superficie exterior

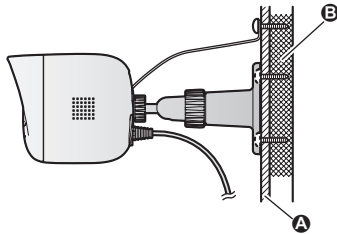

- A** Revestimiento
- B** Estructura detrás del revestimiento

Concreto

- No use los tornillos incluidos. Use los taquetes (tornillos de \varnothing : 4 mm (5/32 pulgadas)) diseñados para paredes de concreto.
- Lea con atención las instrucciones suministradas con los taquetes. Siga las instrucciones sobre el diámetro de la broca, profundidad del orificio, etc.
- Taladre un orificio guía. Retire todos los restos después de taladrar el orificio guía.

- 1 Marque la profundidad del orificio en el taladro (**A**) y después, perforo un orificio guía.

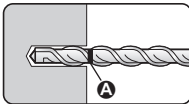

- 2 Retire los restos.

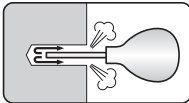

- 3 Introduzca un taquete, apretando el tornillo, después quite el tornillo para asegurar el taquete.

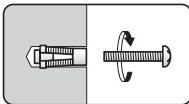

- 4 Introduzca el tornillo y ajústelo.

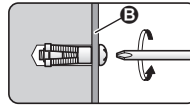

- B** Soporte de montaje de la cámara

ALC (concreto celular ligero en autoclave)

- Dependiendo del tipo de panel de ALC, es posible que no pueda colocar la cámara. Consulte al fabricante del panel de ALC.
- No use los tornillos incluidos. Después de consultar al fabricante del panel de ALC, use solo taquetes de metal disponibles de manera comercial (tornillo \varnothing : 4 mm (5/32 pulgadas)) diseñados para los paneles de ALC.
- Lea con atención las instrucciones suministradas con los taquetes. Siga las instrucciones sobre el diámetro de la broca, profundidad del orificio, etc.
- Taladre un orificio guía. Retire todos los restos después de taladrar el orificio guía.
- Selle el orificio guía con un sellador resistente al agua disponibles de forma comercial.

Otros materiales (mortero, mosaico, etc.)

- No use los tornillos incluidos.
- Consulte con el constructor o el profesional con licencia sobre el tipo de taquete apropiado para la ubicación y los materiales de la instalación.
- No instale sobre tablas de yeso o bloques de concreto.

Configuración

Cómo instalar la cámara

- 1 Coloque el cable de seguridad en la cámara.
 - Coloque la terminal circular del cable de seguridad (1) sobre el agujero para el tornillo.
 - Coloque una arandela (2) encima de la terminal circular del cable de seguridad.
 - Ajuste el tornillo del cable de seguridad (3) encima de la arandela.

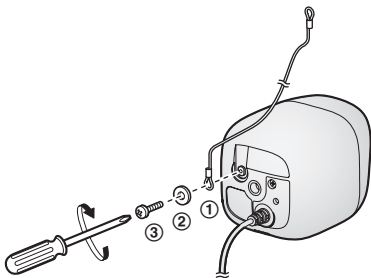

- 2 Coloque el soporte de montaje de la cámara a una pared exterior.
 - Asegure el soporte a la pared ajustando 4 tornillos (1).
 - A 37 mm (1 15/32 pulgadas)

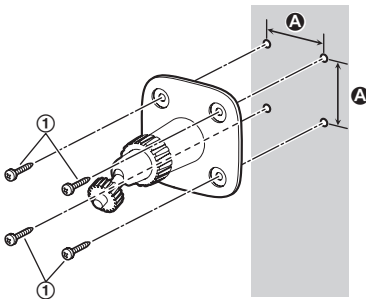

Nota:

- Utilice la siguiente plantilla cuando determine la ubicación de los orificios de los tornillos.

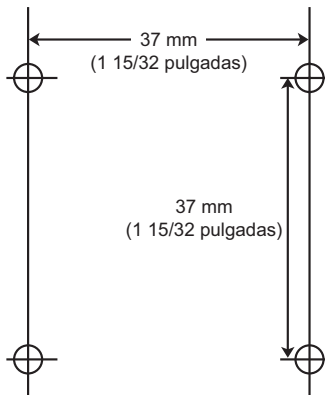

- 3 Coloque la cámara en el soporte.
 - Afloje el tornillo (A).
 - Inserte la punta del soporte (1) en el orificio de colocación del soporte (2) en el lado inferior o posterior.
 - Asegure la cámara ajustando el tornillo (B).

Colocación en el orificio en la parte trasera

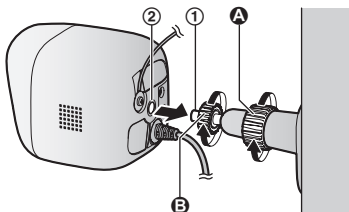

Configuración

Colocación en el orificio en la parte inferior

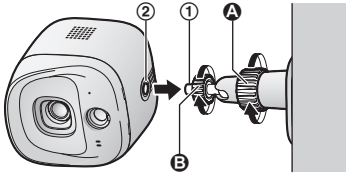

- 4 Ajuste el ángulo de la cámara.
- Afloje el tornillo (1), ajuste la cámara al ángulo deseado y luego ajuste el tornillo (2) para asegurar la cámara.

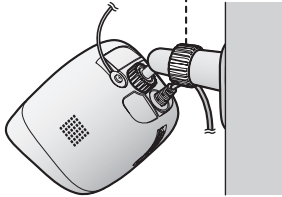
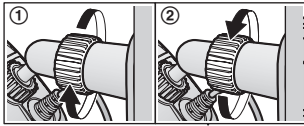

- 5 Coloque el cable de seguridad en la pared.
- Coloque la terminal circular del cable de seguridad (1) sobre la pared.
 - Coloque la arandela (2) encima de la terminal circular del cable de seguridad.
 - Ajuste el tornillo del cable de seguridad (3) encima de la arandela.

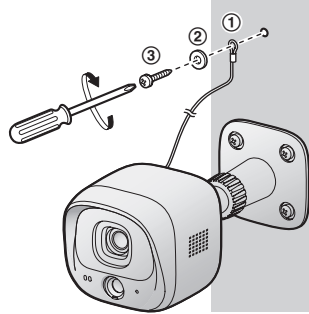

Nota:

- Coloque el cable de seguridad mientras está doblado.
- Coloque el cable de seguridad bien alto para que la cámara no golpee a nadie en caso de que la cámara se desprenda de la pared.
- No se cuelgue de la cámara o del soporte.

Configuración

- 6 Conecte el cable de CC al adaptador de corriente.
- Hale el cable de CC interior y conecte el enchufe de cable de CC (1) al enchufe del adaptador de corriente (2).
 - Conecte el adaptador de corriente (3) a la toma de corriente.

A Exterior

B Interior

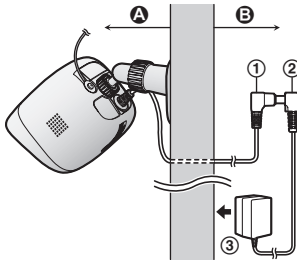

Nota:

- Use solo el adaptador de corriente alterna Panasonic PNLV236 que se suministra.
- Asegúrese de conectar el enchufe del cable de CC y el enchufe del adaptador de corriente interiores.

Nota acerca de las conexiones de alimentación

Adaptador de corriente alterna

- El adaptador de corriente debe permanecer conectado en todo momento (es normal que el adaptador se caliente durante su uso).
- El adaptador de corriente debe estar conectado a un enchufe de corriente orientado verticalmente o en una toma de corriente alterna colocada en el piso. No conecte el adaptador de corriente alterna a una toma de corriente montada en el techo, ya que el peso del adaptador puede hacer que se desconecte.

Falla en el suministro eléctrico

- La cámara no funciona durante las fallas del suministro eléctrico.

Cómo probar el alcance de detección de movimiento

Después de instalar la aplicación de **[Red doméstico]** en su dispositivo móvil, puede usarlo para probar el funcionamiento de las características de detección de movimiento de la cámara.

Para obtener más detalles sobre estas operaciones, consulte la Guía del usuario (página 21).

- 1 Inicie la aplicación **[Red doméstico]** y muestre imágenes en vivo desde la cámara.
- 2 Muévase a un área dentro de la zona visible de la cámara.
- 3 Mientras se mueva cerca de la cámara, use su dispositivo móvil para observar dónde se encuentra en el área visible cuando se activan las características de detección de movimiento de la cámara.
 - Cuando se activan las características de detección de movimiento, el Led indicador se enciende en rojo alrededor de 3 segundos.
- 4 Observe las zonas del área visible de la cámara cuando se detecta movimiento y haga los ajustes necesarios.

Nota:

- Puede ajustar el área detectable mediante el sensor visual. Para obtener más información, consulte la Guía del usuario (página 21).
- Puede ajustar el área detectable mediante el sensor infrarrojo. Consulte "Ajuste del alcance del sensor infrarrojo", página 17.

Cómo probar el micrófono

Para probar el micrófono, hable fuerte y claro en el micrófono mientras un usuario de dispositivo móvil observa las imágenes en vivo desde la cámara.

Ajuste del alcance del sensor infrarrojo







Si hay objetos que no desee que el sensor infrarrojo detecte, puede ajustar el área de detección colocando tapas de alcance del sensor.

Tipos de tapas de alcance y áreas de detección del sensor

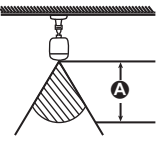
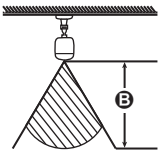
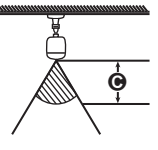
Además de la tapa estándar (incluida en la cámara), existen 4 tipos de tapas (tapa 1-4). Cada tapa bloquea distintas áreas del alcance del sensor y se pueden colocar con incrementos de 45-grados. Consulte la tabla a continuación y coloque la tapa adecuada para el ángulo indicado.

- Las áreas de detección, como se muestra, son una aproximación para cuando la configuración **[Sensor de IR]** está ajustada en **[Normal]**. Para obtener más información, consulte la Guía del usuario (página 21).
- El área de detección rota en función del ángulo de la tapa de alcance del sensor.

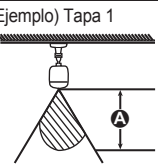
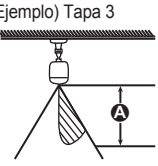
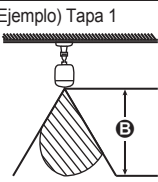
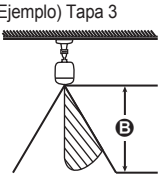
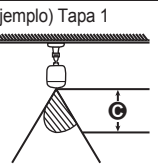
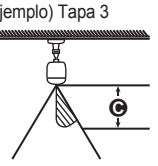
Apéndice

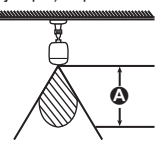
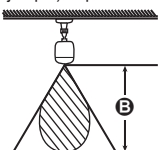
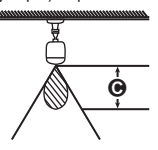
Situación y tipos de tapas	Alcance de detección aproximado (vista desde arriba) *1		
	20 °C (68 °F)	0 °C (32 °F)	30 °C (86 °F)
<p>Cuando desea que se detecten ambos lados de la cámara</p> <p>Tapa estándar (colocada en la cámara)</p> 	 <p>A 5 m (16.4 pies)</p>	 <p>B 6 m (19.7 pies)</p>	 <p>C 4 m (13.1 pies)</p>
<p>Cuando desea que se detecte solo un lado</p> <p>Tapa 1</p>  <p>Tapa 2</p>  <p>Tapa 3</p> 	<p>(Ejemplo) Tapa 1</p>  <p>A 5 m (16.4 pies)</p> <p>(Ejemplo) Tapa 3</p>  <p>A 5 m (16.4 pies)</p>	<p>(Ejemplo) Tapa 1</p>  <p>B 6 m (19.7 pies)</p> <p>(Ejemplo) Tapa 3</p>  <p>B 6 m (19.7 pies)</p>	<p>(Ejemplo) Tapa 1</p>  <p>C 4 m (13.1 pies)</p> <p>(Ejemplo) Tapa 3</p>  <p>C 4 m (13.1 pies)</p>
<p>Cuando desea que no se detecten ambos lados</p> <p>Tapa 4</p> 	<p>(Ejemplo) Tapa 4</p>  <p>A 5 m (16.4 pies)</p>	<p>(Ejemplo) Tapa 4</p>  <p>B 6 m (19.7 pies)</p>	<p>(Ejemplo) Tapa 4</p>  <p>C 4 m (13.1 pies)</p>

*1 Varía en función de la temperatura ambiente en la ubicación de la instalación de la cámara. Los valores numéricos son aproximaciones. El área de detección se indica con .

Acerca del ángulo de colocación de la tapa de alcance del sensor

Ejemplo 1

Quando hay un objeto en el lado derecho del área visible que no quiere que se detecte, (como árboles):

Coloque una de las tapas 1-3 como se muestra en el ejemplo (A) de acuerdo con el área que no desea que se detecte.

Ejemplo 2

Quando hay un objeto en el extremo superior izquierdo del área visible que no desea que se detecte (vehículos en la calle, etc.):

Coloque una de las tapas 1-3 como se muestra en el ejemplo (B) de acuerdo con el área que no desea que se detecte.

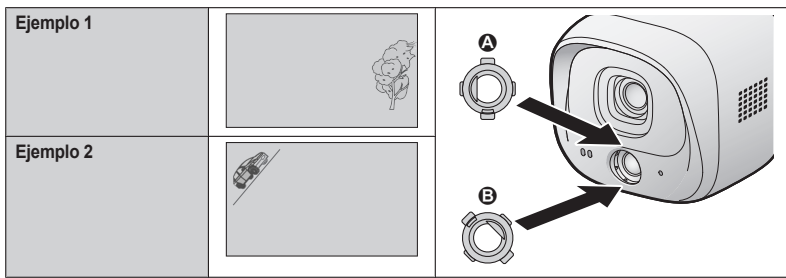

Apéndice

Reemplazo de las tapas de alcance del sensor

- 1 Extraiga la tapa estándar ya colocada.

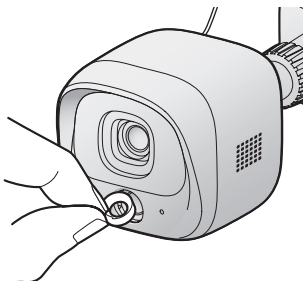

- 2 Retire la tapa de alcance del sensor deseado de uno de los 4 tipos (①) y colóquelo en el sensor (②).
 - Al instalar, gire la pestaña (A) en la tapa hacia arriba o a un ángulo de 45-grados de acuerdo con el tipo de tapa o dirección y coloque la tapa de la cámara, como se muestra en la siguiente ilustración.

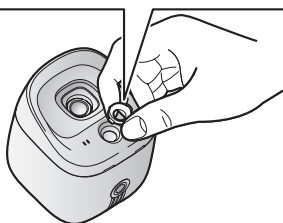
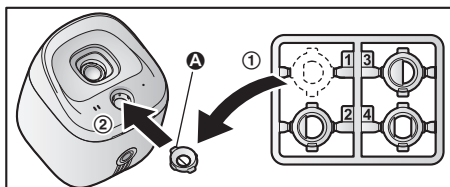

Acceso a la Guía del usuario

La Guía del usuario es una colección de documentación en línea que lo ayuda a aprovechar al máximo la aplicación [Red doméstico].

1 iPhone®/iPad®

Toque  en la pantalla de inicio de la aplicación.

Dispositivos Android™

Toque  u oprima el botón menú de su dispositivo en la pantalla de inicio de la aplicación.

2 Toque [Guía del usuario].

Nota:

- También puede acceder a la Guía del usuario mediante la página web a continuación.



www.panasonic.net/pcc/support/tel/homenetwork/manual/

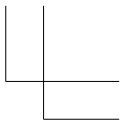
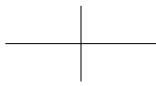
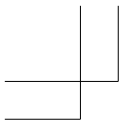

Notas

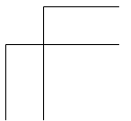
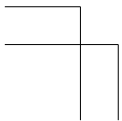
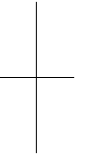
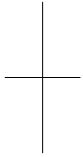

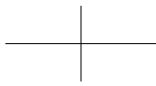

Notas

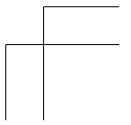
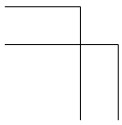
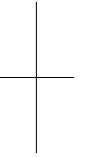
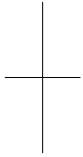

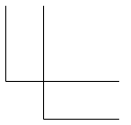
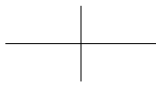
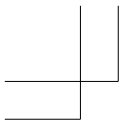

Notas

