

Panasonic®

Basic Owner's Manual Digital Camera

Model No. **DMC-ZS25**

LUMIX

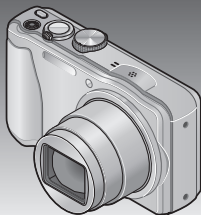

Please read these instructions carefully before using this product, and save this manual for future use.



More detailed instructions on the operation of this camera are contained in "Owner's Manual for advanced features (PDF format)" in the supplied CD-ROM. Install it on your PC to read it.



For Canadian assistance, please call: 1-800-99-LUMIX (1-800-995-8649) or send e-mail to: lumixconcierge@ca.panasonic.com

PC

VQT4N97
M1212KZ0

**Dear Customer,
Thank you for choosing Panasonic!**

You have purchased one of the most sophisticated and reliable products on the market today. Used properly, we're sure it will bring you and your family years of enjoyment. Please take time to fill in the information below.

The serial number is on the tag located on the underside of your camera. Be sure to **retain this manual** as your convenient camera information source.

Date of Purchase	Dealer Phone No.
Dealer Purchased From	Model No.
Dealer Address	Serial No.

Please note that the actual controls and components, menu items, etc. of your Digital Camera may look somewhat different from those shown in the illustrations in this Owner's Manual.

Carefully observe copyright laws.

- Recording of pre-recorded tapes or discs or other published or broadcast material for purposes other than your own private use may infringe copyright laws. Even for the purpose of private use, recording of certain material may be restricted.



A lithium ion battery that is recyclable powers the product you have purchased. Please call 1-800-8-BATTERY for information on how to recycle this battery.

-If you see this symbol-



Information on Disposal in other Countries outside the European Union

This symbol is only valid in the European Union. If you wish to discard this product, please contact your local authorities or dealer and ask for the correct method of disposal.

Information for Your Safety

WARNING:

To reduce the risk of fire, electric shock or product damage,

- Do not expose this unit to rain, moisture, dripping or splashing.
- Use only the recommended accessories.
- Do not remove covers.
- Do not repair this unit by yourself. Refer servicing to qualified service personnel.

The socket outlet shall be installed near the equipment and shall be easily accessible.

This Class B digital apparatus complies with Canadian ICES-003.

■ Product identification marking

Product	Location
Digital camera	Bottom

■ About the battery pack

CAUTION

Battery pack (Lithium ion battery pack)

- Use the specified unit to recharge the battery pack.
- Do not use the battery pack with equipment other than the specified unit.
- Do not get dirt, sand, liquids, or other foreign matter on the terminals.
- Do not touch the plug terminals (+ and -) with metal objects.
- Do not disassemble, remodel, heat or throw into fire.

If any electrolyte should come into contact with your hands or clothes, wash it off thoroughly with water.

If any electrolyte should come into contact with your eyes, never rub the eyes. Rinse eyes thoroughly with water, and then consult a doctor.

CAUTION

- Danger of explosion if battery is incorrectly replaced. Replace only with the type recommended by the manufacturer.
 - When disposing the batteries, please contact your local authorities or dealer and ask for the correct method of disposal.
-
- Do not heat or expose to flame.
 - Do not leave the battery(ies) in a car exposed to direct sunlight for a long period of time with doors and windows closed.

Warning

Risk of fire, explosion and burns. Do not disassemble, heat above 60 °C (140 °F) or incinerate.

■ About the AC adaptor (supplied)

CAUTION!

To reduce the risk of fire, electric shock or product damage,

- Do not install or place this unit in a bookcase, built-in cabinet or in another confined space. Ensure this unit is well ventilated.

AC adaptor

This AC adaptor operates on AC between 110V and 240V.

But

- In the U.S.A. and Canada, the AC adaptor must be connected to a 120V AC power supply only.
- When connecting to an AC supply outside of the U.S.A. or Canada, use a plug adaptor to suit the AC outlet configuration.

■ Cautions for Use

- Do not use any other USB connection cables except the supplied one or a genuine Panasonic USB connection cable (DMW-USBC1: optional).
- Always use a genuine Panasonic HDMI mini cable (RP-CDHM15, RP-CDHM30: optional).
Part numbers: RP-CDHM15 (1.5 m) (4.9 feet), RP-CDHM30 (3.0 m) (9.8 feet)
- Always use a genuine Panasonic AV cable (DMW-AVC1: optional).

Keep this unit as far away as possible from electromagnetic equipment (such as microwave ovens, TVs, video games etc.).

- If you use this unit on top of or near a TV, the pictures and/or sound on this unit may be disrupted by electromagnetic wave radiation.
- Do not use this unit near cell phones because doing so may result in noise adversely affecting the pictures and/or sound.
- Recorded data may be damaged, or pictures may be distorted, by strong magnetic fields created by speakers or large motors.
- Electromagnetic wave radiation generated by microprocessors may adversely affect this unit, disturbing the pictures and/or sound.
- If this unit is adversely affected by electromagnetic equipment and stops functioning properly, turn this unit off and remove the battery or disconnect AC adaptor (supplied)/AC adaptor (DMW-AC5PP: optional). Then reinsert the battery or reconnect AC adaptor and turn this unit on.

Do not use this unit near radio transmitters or high-voltage lines.

- If you record near radio transmitters or high-voltage lines, the recorded pictures and/or sound may be adversely affected.

For information about the software used for this product, press [MENU/SET] and select [Setup] to display [Version Disp.] before pressing [MENU/SET] again.

This product is licensed under the AVC patent portfolio license for the personal and non-commercial use of a consumer to (i) encode video in compliance with the AVC Standard ("AVC Video") and/or (ii) decode AVC Video that was encoded by a consumer engaged in a personal and non-commercial activity and/or was obtained from a video provider licensed to provide AVC Video. No license is granted or shall be implied for any other use. Additional information may be obtained from MPEG LA, LLC.
See <http://www.mpegla.com>.

Contents

Information for Your Safety	3	Taking pictures	13
Before use	6	Recording motion pictures...	14
Standard accessories	7	Viewing your pictures	15
Names and Functions of Main Parts	8	Deleting pictures	15
Inserting and removing the battery or SD memory card (optional)	9	Reading the Owner's Manual (PDF format).....	16
Charging the battery	10	Supplied software.....	17
Setting the clock.....	11	Specifications	18
Setting the menu	12	Digital Camera Accessory System.....	21
		Limited Warranty	22

Before use

■ Camera handling





- Keep the camera away from excessive vibration, force, or pressure.
- The camera is not dust resistant, splash resistant, or waterproof. Avoid using the camera in places with excessive dust or sand, or where water can come into contact with the camera.

■ Condensation (When the lens or the LCD monitor is fogged up)

- Condensation may occur when the camera is exposed to sudden changes of temperature or humidity. Avoid these conditions, which may make the lens or LCD monitor dirty, cause mold, or damage the camera.
- If condensation does occur, turn off the camera and wait about two hours before using it. Once the camera adjusts to the surrounding temperature, the fogging will clear naturally.

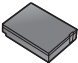
Standard accessories

Check that all the accessories are supplied before using the camera. Part numbers are as of January 2013. These may be subject to change.

<input type="checkbox"/> Battery pack DMW-BCG10PP • Charge the battery before use. Battery pack is indicated as battery pack or battery in the text. 	<input type="checkbox"/> USB connection cable K1HY08YY0031 
<input type="checkbox"/> AC adaptor VSK0768 	<input type="checkbox"/> CD-ROM VFF1087 • Software: Use it to install the software on your PC. • Owner's Manual for advanced features 
<input type="checkbox"/> Hand strap VFC4297 	

- SD Memory Card, SDHC Memory Card and SDXC Memory Card are indicated as card in the text.
- **Cards are optional.** You can record or play back pictures on the built-in memory when you are not using a card.
- For information about optional accessories, refer to the “Digital Camera Accessory System”.
- If any accessories are lost, customers in Canada should contact 1-800-99-LUMIX (1-800-995-8649) for further information about obtaining replacement parts.
- Please dispose of all packaging appropriately.
- Keep small parts in a safe place out of the reach of children.
- The illustrations and screens in this manual may differ from the actual product.

Names and Functions of Main Parts

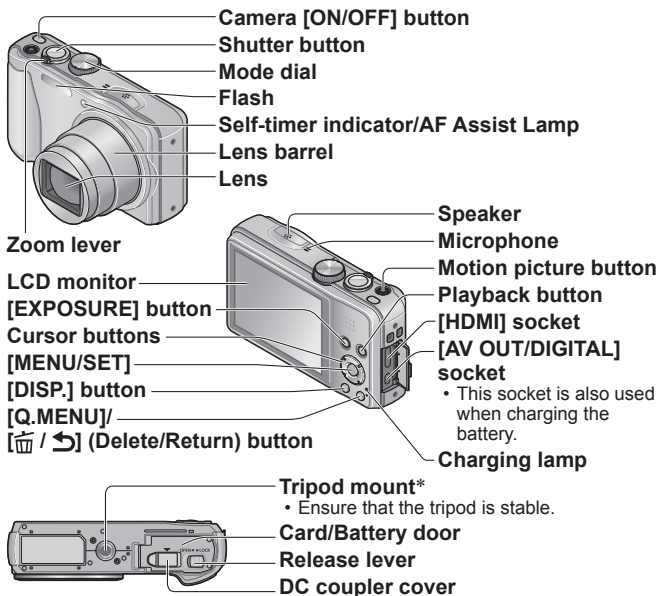

* Do not attach to a tripod with a 5.5 mm (0.22 inch) or longer screw. Doing so may damage this unit.

Hand strap eyelet

We recommend using the supplied hand strap to avoid dropping the camera.



- Always use a genuine Panasonic AC adaptor (DMW-AC5PP: optional).
- When using an AC adaptor, ensure that the Panasonic DC coupler (DMW-DCC5: optional) and AC adaptor (DMW-AC5PP: optional) are used.

Inserting and removing the battery or SD memory card (optional)

Make sure that the camera is turned off.

- 1 Slide the release lever (A) to the [OPEN] position and open the card/battery door**



- 2 Insert the battery and card, making sure that their orientation is correct**

- Battery: Insert the battery all the way firmly and check that it is locked by lever (B).
- Card: Insert the card all the way firmly until it clicks.

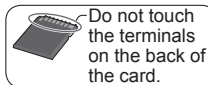

- 3 Close the door**
Slide the release lever to the [LOCK] position.

■ To remove

- **To remove battery:**
Move lever in direction of arrow.

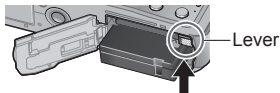

- **To remove card:**
Push the card until it clicks, then pull the card out.

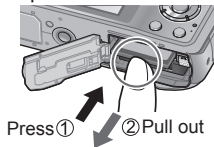

- Always use genuine Panasonic batteries (DMW-BCG10PP).
- If you use other batteries, we cannot guarantee the quality of this product.
- Keep the Memory Card out of reach of children to prevent swallowing.
- We recommend using a Panasonic card.

Charging the battery

- The battery that can be used with this unit is DMW-BCG10PP.
- The battery is not charged when the camera is shipped. Charge the battery before use.
- Charge the battery with the AC adaptor (supplied) indoors (10 °C to 30 °C (50 °F to 86 °F)).

Make sure that the camera is turned off.

- 1 Insert the battery to this unit, and then connect this unit to the AC adaptor (A) (supplied) or a PC (B)

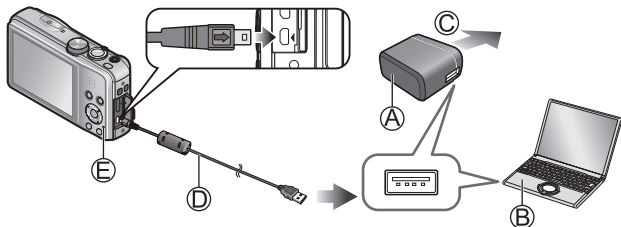

- Ⓒ To the electrical outlet
- Ⓓ USB connection cable (supplied)

■ Charging lamp (E)

On: Charging in progress (approx. 210 min. if fully depleted)

Off: Charging stops

When using the AC adaptor (supplied), observe the following points as improper connections may cause malfunctions.

- Do not use any other USB connection cables except the supplied one or a genuine Panasonic USB connection cable (DMW-USBC1: optional).
- Do not use any other AC adaptors except the supplied one.
- Do not use the AC adaptor (supplied) or the USB connection cable (supplied) with other devices.

Setting the clock

The clock is not set when the camera is shipped.
Disconnect the unit from the AC adaptor (supplied).

- 1 Press the camera [ON/OFF] button (A)**
- 2 Press [MENU/SET] (B)**
- 3 Press ◀▶ to select the items (year, month, day, hour, minute, display order or time display format), and press ▲▼ to set**
- 4 Press [MENU/SET]**
 - To cancel → Press [🗑️ / ↶] button.
- 5 Press [MENU/SET] to set**





■ Changing time settings

Select [Clock Set] from [Rec] or [Setup] menu, perform **3** and **4**.
Please see the next page on how to set the menu.

Setting the menu

Refer to the following procedures to operate the menus.

Example: Setting [AF Mode] from  to  in the [Program AE] Mode

1 Press [MENU/SET] to display the menu

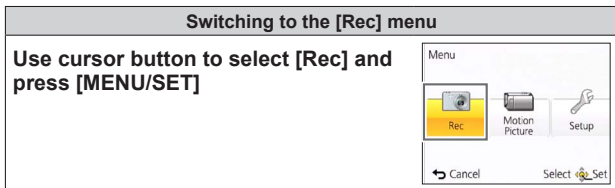

2 Press \blacktriangle \blacktriangledown to select [AF Mode] and then press [MENU/SET]

- Depending on the item, its setting may not appear or it may be displayed in a different way.

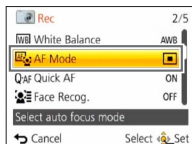

3 Press \blacktriangle \blacktriangledown to select and then press [MENU/SET] to set

4 Press / button several times to close the menu

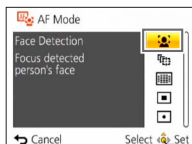

Taking pictures

- 1 Press the camera [ON/OFF] button (A)
- 2 Set to the desired recording mode (B)

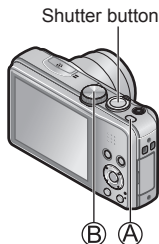

■Recording mode

iA	Take pictures with automatic settings.
P	Take pictures with automatic shutter speed and aperture value settings.
A	The shutter speed is automatically determined by the aperture value you set.
S	The aperture value is automatically determined by the shutter speed you set.
M	The exposure is adjusted by the aperture value and the shutter speed that are manually adjusted.
C1 C2	Use this mode to take pictures with previously registered setting.
	Record panorama pictures.
SCN	Take pictures according to the scene.
	Take pictures while confirming the picture effect.

3 Take a picture



Press halfway
(press lightly and focus)



Press fully
(press the button
all the way to record)

Recording motion pictures

You can record motion pictures with audio (monaural). Zoom can also be used during recording.

- 1 Press the motion picture button (A) to start recording**
- 2 Press the motion picture button (A) again to end recording**



Remaining recording time (approx.)

Elapsed recording time

- We recommend you use a battery with sufficient battery power when recording motion pictures.
- Immediately release the motion picture button after pressing it all the way.
- You can continuously record a motion picture in [MP4] for up to 29 minutes 59 seconds or approx. 4 GB. (Since recording in [MP4] with [FHD/30p] creates larger files, the recording time for such motion pictures will be shorter than 29 minutes 59 seconds.)
- If [Rec Quality] of [AVCHD] motion pictures is set to [FHD/60i], you can continuously record a motion picture for up to 29 minutes 59 seconds.
- You can record a motion picture to the built-in memory only in [MP4] using the [VGA/30p] setting.

Viewing your pictures

- 1 Press the Playback button (A)
- 2 Press ◀▶ to select a picture to be displayed



- By holding down the Playback button while the camera is off, you can turn the camera on in Playback Mode.
- To play back a motion picture, select a picture with ◀ or ▶, and then press ▲ to start playback.
- To switch to Recording Mode, press the playback button again or press the shutter button halfway during playback.

Deleting pictures

Deleted pictures cannot be recovered.

- 1 Press [🗑️ / ↵] button (A) to delete the displayed picture
- 2 Press ◀ to select [Yes] and then press [MENU/SET] (B)

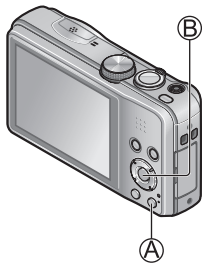

Reading the Owner's Manual (PDF format)

More detailed instructions on the operation of this camera are contained in "Owner's Manual for advanced features (PDF format)" in the supplied CD-ROM. Install it on your PC to read it.

■ For Windows

- 1 Turn the PC on and insert the CD-ROM containing the Owner's Manual (supplied)**
- 2 Click the [Owner's Manual]**
- 3 Select the desired language and then click [Owner's Manual] to install**
Ⓐ To return to the install menu.
- 4 Double click the "Owner's Manual" shortcut icon on the desktop**

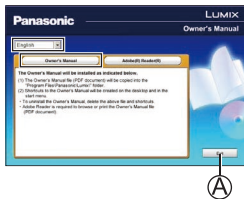

■ When the Owner's Manual (PDF format) will not open

You will need Adobe Acrobat Reader 5.0 or later or Adobe Reader 7.0 or later to browse or print the Owner's Manual (PDF format).

- You can download and install a version of Adobe Reader that you can use with your OS from the following website.
<http://get.adobe.com/reader/otherversions/>

Supplied software

The supplied CD-ROM contains the following software.
Install the software on your computer to use.

PHOTOfunSTUDIO 9.0 AE	Pictures can be captured to a PC, and can be viewed, organized, printed, etc. Also, still pictures can be corrected and motion pictures can be edited. • Compatible OS: Windows 8 / 7 / Vista / XP
LoiLoScope (30-day full-trial version)	You can edit motion pictures easily. This will only install a shortcut to the trial version download site. For details about using LoiLoScope, please download and see the manual from the following site. http://loilo.tv/product/20/ • Compatible OS: Windows 8 / 7 / Vista / XP

For details about operating environment and usage, please read “Owner’s Manual for advanced features” (PDF format) or the manuals for each software.

- PHOTOfunSTUDIO / LoiLoScope are not compatible with Mac.

Installing supplied software

Preparations:

- Check the environment of your PC.
- Before inserting the CD-ROM, close all running applications.

1 Insert the CD-ROM with the supplied software

- When you insert the supplied CD-ROM, the install menu will start.

2 Click on the [Applications] on the install menu

3 Click on the [Recommended Installation]

- Proceed with installation according to messages appearing on the screen.
- You can also select which software to install individually.

Specifications

Specifications are subject to change without notice.

Digital Camera: Information for Your Safety

Power Source	DC 5.1 V
Power Consumption	When recording: 1.4 W When playing back: 1.0 W
Camera effective pixels	16,100,000 pixels
Image sensor	1/2.33" MOS sensor, total pixel number 17,500,000 pixels Primary color filter
Lens [NANO SURFACE COATING]	Optical 20 x zoom f=4.3 mm to 86.0 mm (35 mm film camera equivalent: 24 mm to 480 mm) / F3.3 (Max. Wide) to F6.4 (Max. Tele)
Image Stabilizer	Optical method
Focus range	
P / A / S / M	50 cm (1.6 feet) (Max. Wide) / 2 m (6.6 feet) (Max. Tele) to ∞
Macro / Intelligent Auto / Motion picture	3 cm (0.098 feet) (Max. Wide) / 1 m (3.3 feet) (Max. Tele) to ∞ (5 × to 7 × is 2 m (6.6 feet) to ∞)
Scene Mode	The focus ranges listed above may vary depending on the selected Scene Mode.
Shutter system	Electronic shutter + Mechanical shutter
Minimum Illumination	Approx. 10 lx (when i-Low light is used, the shutter speed is 1/30th of a second)
Shutter speed	4 seconds to 1/2000th of a second [Starry Sky] Mode: 15 seconds, 30 seconds
Exposure (AE)	Program AE (P) / Aperture-priority AE (A) / Shutter-priority AE (S) / Manual exposure (M)
Metering Mode	[Multi Metering] / [Center Weighted] / [Spot]

LCD monitor	3.0" TFT LCD (4:3) (Approx. 460,800 dots) (field of view ratio about 100%)
Microphone / Speaker	Monaural
Recording media	Built-in Memory (Approx. 90 MB) / SD Memory Card / SDHC Memory Card / SDXC Memory Card
Recording file format	
Still picture	JPEG (based on Design rule for Camera File system, based on Exif 2.3 standard / DPOF corresponding) / MPO
Motion pictures	AVCHD / MP4
Audio compression format	AVCHD: Dolby® Digital MP4: AAC
Interface	
Digital	USB 2.0 (High Speed)
Analog video	NTSC Composite
Audio	Audio line output (Monaural)
Terminal	HDMI: MiniHDMI TypeC AV OUT/DIGITAL: Dedicated jack (8 pin)
Dimensions	Approx. 104.9 mm (W) x 58.9 mm (H) x 28.7 mm (D) [4.13" (W) x 2.32" (H) x 1.13" (D)] (excluding the projection part)
Mass (Weight)	With card and battery: Approx. 193 g (0.426 lb) Excluding card and battery: Approx. 171 g (0.377 lb)
Operating temperature	0 °C to 40 °C (32 °F to 104 °F)
Operating humidity	10%RH to 80%RH

Specifications

AC adaptor

(Panasonic VSK0768): Information for Your Safety

Input	~ 110 V to 240 V, 50/60 Hz, 0.2 A
Output	— 5 V, 800 mA

Battery pack (lithium-ion)

(Panasonic DMW-BCG10PP): Information for Your Safety

Voltage / capacity	3.6 V / 895 mAh
--------------------	-----------------

Digital Camera Accessory System

Description	Accessory#
Battery pack*1	DMW-BCG10
DC coupler*2	DMW-DCC5
AC adaptor*2*3	DMW-AC5
Marine case	DMW-MCTZ35
USB connection cable	DMW-USBC1
AV cable	DMW-AVC1
HDMI mini cable	RP-CDHM15, RP-CDHM30

*1 The battery pack can be charged from the camera using the AC adaptor (supplied).

*2 The AC adaptor (optional) can only be used with the designated Panasonic DC Coupler (optional). The AC adaptor (optional) cannot be used by itself.

*3 This AC adaptor (optional) cannot be used to charge the battery pack. Use supplied AC adaptor to charge the battery pack.

- Product numbers are correct as of January 2013. These may be subject to change.
- Accessories and/or model numbers may vary between countries. Consult your local dealer.

Limited Warranty

Panasonic Canada Inc.

5770 Ambler Drive, Mississauga, Ontario L4W 2T3

PANASONIC PRODUCT – LIMITED WARRANTY

Panasonic Canada Inc. warrants this product to be free from defects in material and workmanship under normal use and for a period as stated below from the date of original purchase agrees to, at its option either (a) repair your product with new or refurbished parts, (b) replace it with a new or a refurbished equivalent value product, or (c) refund your purchase price. The decision to repair, replace or refund will be made by Panasonic Canada Inc.

Digital Camera	One (1) year, parts and labour
Digital Camera Peripherals	One (1) year, parts and labour
Digital Camera Accessories	Ninety (90) days, parts and labour

This warranty is given only to the original purchaser, or the person for whom it was purchased as a gift, of a Panasonic brand product mentioned above sold by an authorized Panasonic dealer in Canada and purchased and used in Canada, which product was not sold "as is", and which product was delivered to you in new condition in the original packaging.

**IN ORDER TO BE ELIGIBLE TO RECEIVE WARRANTY SERVICE
HEREUNDER, A PURCHASE RECEIPT OR OTHER PROOF OF DATE
OF ORIGINAL PURCHASE, SHOWING AMOUNT PAID AND PLACE OF
PURCHASE IS REQUIRED**

LIMITATIONS AND EXCLUSIONS

This warranty **ONLY COVERS** failures due to defects in materials or workmanship, and **DOES NOT COVER** normal wear and tear or cosmetic damage. The warranty **ALSO DOES NOT COVER** damages which occurred in shipment, or failures which are caused by products not supplied by Panasonic Canada Inc., or failures which result from accidents, misuse, abuse, neglect, mishandling, misapplication, alteration, faulty installation, set-up adjustments, misadjustment of consumer controls, improper maintenance, improper batteries, power line surge, lightning damage, modification, introduction of sand, humidity or liquids, commercial use such as hotel, office, restaurant, or other business or rental use of the product, or service by anyone other than a Authorized Servicer, or damage that is attributable to acts of God.

Dry cell batteries, printer ink cartridge and paper are also excluded from coverage under this warranty.

Rechargeable batteries are warranted for ninety (90) days from date of original purchase.

THIS EXPRESS, LIMITED WARRANTY IS IN LIEU OF ALL OTHER WARRANTIES, EXPRESS OR IMPLIED, INCLUDING ANY IMPLIED WARRANTIES OF MERCHANTABILITY AND FITNESS FOR A PARTICULAR PURPOSE. IN NO EVENT WILL PANASONIC CANADA INC. BE LIABLE FOR ANY SPECIAL, INDIRECT OR CONSEQUENTIAL DAMAGES RESULTING FROM THE USE OF THIS PRODUCT OR ARISING OUT OF ANY BREACH OF ANY EXPRESS OR IMPLIED WARRANTY. (As examples, this warranty excludes damages for lost time, travel to and from the Authorized Servicer, loss of or damage to media or images, data or other memory or recorded content. This list of items is not exhaustive, but for illustration only.)

In certain instances, some jurisdictions do not allow the exclusion or limitation of incidental or consequential damages, or the exclusion of implied warranties, so the above limitations and exclusions may not be applicable. This warranty gives you specific legal rights and you may have other rights which vary depending on your province or territory.

WARRANTY SERVICE

For product operation and information assistance, please contact:

Our Customer Care Centre: Telephone: 1-800-99-LUMIX (1-800-995-8649)
Fax # : (905) 238-2360
Email link: lumixconcierge@ca.panasonic.com

For defective product exchange within the warranty period, please contact the original Dealer or our Customer Care Centre.

HDMI

AVCHD™

DOLBY
DIGITAL



- HDMI, the HDMI Logo, and High-Definition Multimedia Interface are trademarks or registered trademarks of HDMI Licensing LLC in the United States and other countries.
- HDAVI Control™ is a trademark of Panasonic Corporation.
- “AVCHD” and the “AVCHD” logo are trademarks of Panasonic Corporation and Sony Corporation.
- Manufactured under license from Dolby Laboratories.
Dolby and the double-D symbol are trademarks of Dolby Laboratories.
- SDXC Logo is a trademark of SD-3C, LLC.
- QuickTime and the QuickTime logo are trademarks or registered trademarks of Apple Inc., used under license therefrom.
- Windows and Windows Vista are either registered trademarks or trademarks of Microsoft Corporation in the United States and/or other countries.
- Mac and Mac OS are trademarks of Apple Inc., registered in the U.S. and other countries.
- This product uses “DynaFont” from DynaComware Corporation. DynaFont is a registered trademark of DynaComware Taiwan Inc.
- Other names, company names, and product names mentioned in these instructions are trademarks or registered trademarks of the companies concerned.

Panasonic®

Panasonic Canada Inc.

5770 Ambler Drive

Mississauga, Ontario

L4W 2T3

(905) 624-5010

www.panasonic.ca

© Panasonic Corporation 2013

Printed in Japan